



**MASA**  
MICROCONIC SYSTEM

**WORKHOLDING COLLET SYSTEM  
FOR SMALL PARTS**

[MASATOOL.COM](http://MASATOOL.COM)





# TABLE OF CONTENTS

MICROCONIC SYSTEM OVERVIEW .....	PAGE 4
THE MICROCONIC DIFFERENCE .....	PAGE 5
CARTRIDGES .....	PAGE 7
COLLETS OVERVIEW .....	PAGE 10
SYSTEM ACCESSORIES.....	PAGE 12
EGS GUIDE SLEEVE BLANKS .....	PAGE 14
STANDARD MODIFICATIONS .....	PAGE 15
CUSTOM COLLETS .....	PAGE 16
UM5 COLLETS.....	PAGE 18
UM10 COLLETS .....	PAGE 34
INSTALLATION INSTRUCTIONS .....	PAGE 48
WARRANTY AND SHIPPING .....	PAGE 50



# MASA MICROCONIC SYSTEM

Masa Tool has developed the Microconic system specifically for holding workpieces from Ø0.2mm to 10mm (Ø0.008" to 0.394") through capacity. The system consists of two major components:

- The Microconic **cartridge**, which fits into your CNC machine spindle without modification
- The Microconic **collet**, which fits in the Microconic cartridge.

The Microconic system has unsurpassed concentricity compared to traditional long nose collets. It works with either draw-type or push-type standard collet systems that are in many machines.

The over-grip collet capabilities of the Masa Microconic System introduce a whole new world of time saving opportunities. They open wider and clamp with extreme accuracy and rigidity that exceeds anything else available.

The Microconic system is available in two general series: UM10 with Ø10mm (.394") capacity, and UM5 with Ø5.5mm (.217") capacity. Everything in the catalog ships within 2 days of order.

100% made in the USA.

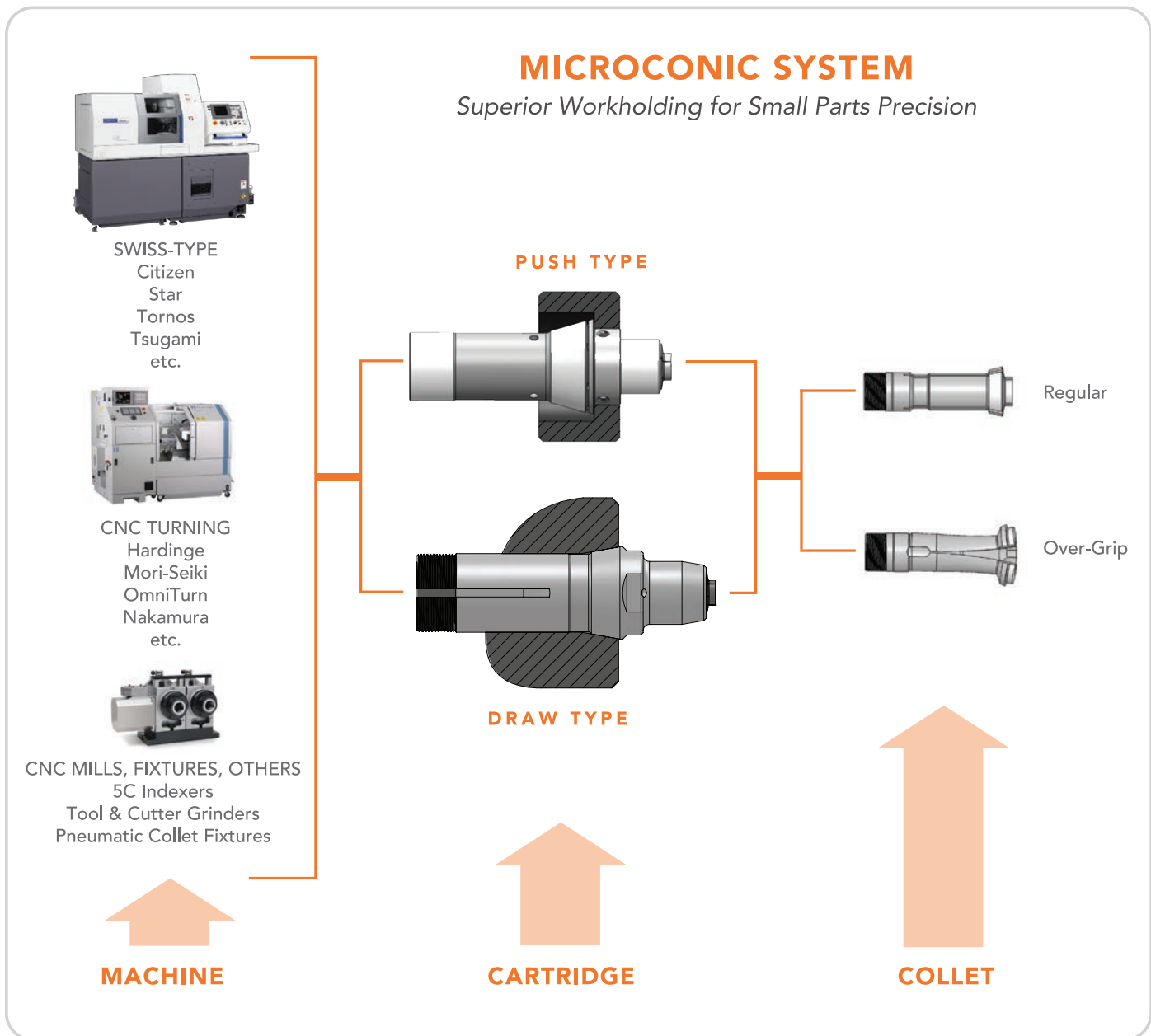



**THE MICROCONIC SYSTEM CAN DO THINGS THAT ARE IMPOSSIBLE WITH TRADITIONAL COLLETS.**

**THE MICROCONIC DIFFERENCE**

- Accuracy – Concentricity guaranteed to 5µm (.0002") runout.
- All sizes available from Ø0.2mm to 10mm (0.008" - 0.394").
- Over-grip collets have full rigidity and accuracy for robust machining.
- Over-grip collets open up to 4mm (0.157") diameter larger than the clamping diameter. See complete details in the table "Microconic Collets" starting on page 18.
- Every Microconic collet fits in every Microconic cartridge of the same series, no matter which machine.
- Every Microconic cartridge has an extended nose with unsurpassed rigidity and accuracy due to solid one-piece construction.
- The Microconic cartridge can be used as a gage to verify machine spindle accuracy under true working conditions.
- Micrograd dial allows you to set your collet clamping force with calibrated precision. Now, even the most fragile parts can be held safely and firmly.

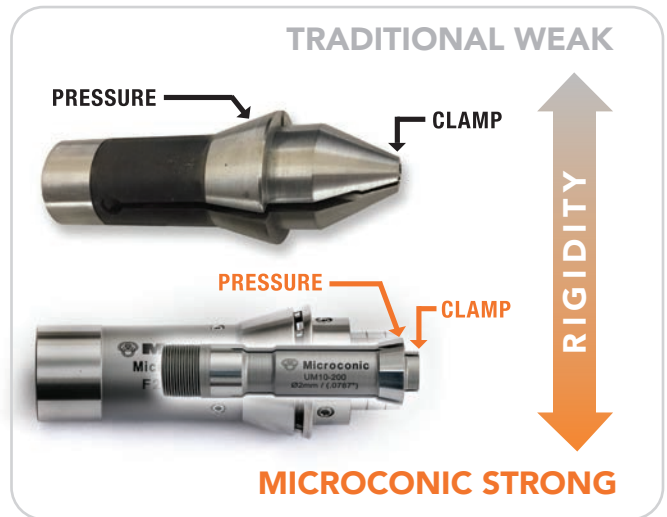

**THE DIFFERENCE IS UNSURPASSED RIGIDITY.**

- Microconic collets are hardened and precision ground to the highest quality standards. We are the best.
- No chip buildup problem. "Lights-out" machining for weeks at a time.





## MICROCONIC CARTRIDGES

The Microconic cartridge fits into your conventional CNC or Swiss-type machine and transforms the spindle into a highly accurate miniature workholding system. Precision ground high-chromium tool steel, triple tempered and cryogenically

treated for extreme durability. Now you can have the confidence to move more machining operations to the sub-spindle from the main spindle, to balance cutting time and reduce overall cycle time. PUT THAT SUB-SPINDLE TO WORK!

### ADVANTAGES OF THE MICROCONIC CARTRIDGE

- Installed like a standard collet in your machine, and actuated like a normal collet. Simple and fast!
- Solid extended nose for unsurpassed rigidity.
- Extreme accuracy. The system is guaranteed not to add more than 5 microns runout (.0002" TIR) to your machine.
- The Microconic cartridge can be used as a gage to verify machine spindle accuracy.
- Available to fit machines that use standard legacy workholding collets (see pages 3 - 5 for details).
- Delicate parts are held firmly and precisely, every time;
  - thin walls
  - micro-size parts
  - fragile materials
- Eliminates the need for long nose collets.



- Micrograd dial gives you precise & repeatable control of collet clamping force, regardless of your machine. Unique to our system!
- All Microconic cartridges in any machine can use any Microconic collets of the same series. UM5 for cartridge part numbers ending with xxxM5, and UM10 for cartridge part numbers ending with xxxM10.
- Designed with an extended nose that is solid and rigid, yet small in diameter so tooling and coolant have easy access to workpiece.

SKU	PART NUMBER	mm/inch	MASA SERIES	FITS MACHINES THAT USE THESE COLLET TYPES:
124968	F15M5-E	Inch	UM5	Southwick & Meister TF15, Schaublin F15 76-580, E120
124969	F15M5-M	Metric		
124970	F16M5-E	Inch	UM5	Southwick & Meister TF16, Schaublin F16 76-1076, E1212
124971	F16M5-M	Metric		
122006	F20M10-E	Inch	UM10	Southwick & Meister TF20, Schaublin F20 76-87, E138
122039	F20M10-M	Metric		
122026	F201M10-E	Inch	UM10	Tornos-type Schaublin F20 76-201, E136
122040	F201M10-M	Metric		
122001	F25M10-E	Inch	UM10	Southwick & Meister TF25, Schaublin F25 76-64, E145
122041	F25M10-M	Metric		
122027	F37M10-E	Inch	UM10	Southwick & Meister TF37, Schaublin F37 76-740, E1536
122037	F37M10-M	Metric		
122009	5CM10-E	Inch	UM10	Hardinge 5C, Schaublin W31.75 80-842, E385
122042	5CM10-M	Metric		



# UM5 AND UM10 MICROCONIC CARTRIDGES

## F15M5 CARTRIDGE

Fits many 10mm to 16mm capacity machines from Star, Maier, Citizen, Tsugami, etc.

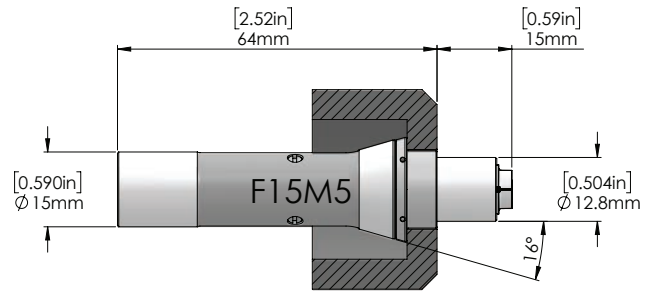

## F16M5 CARTRIDGE

Fits many 10mm to 16mm capacity machines from Citizen, Hanwha, Nexturn, Tornos, etc.

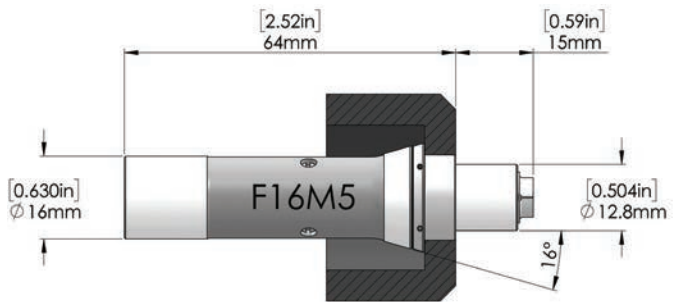

## F20M10 CARTRIDGE

Fits many 12mm and 16mm capacity machines from Citizen, Star, Tsugami, Traub, Nomura, Maier, etc.

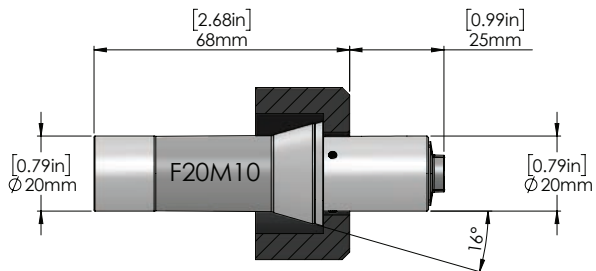

## F201M10 CARTRIDGE

Fits many 13mm and 16mm capacity Tornos Deco machines. Note that some enlargement of the spindle cap nut through-hole is required (see diagram at right). Contact us for details.

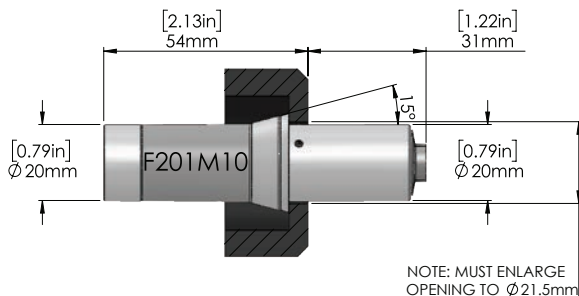



### F25M10 CARTRIDGE

Fits many 20mm and 16mm capacity machines from Citizen, Star, Tsugami, Tornos, Traub, Nomura, Hanwha, Nexturn, Maier, etc.

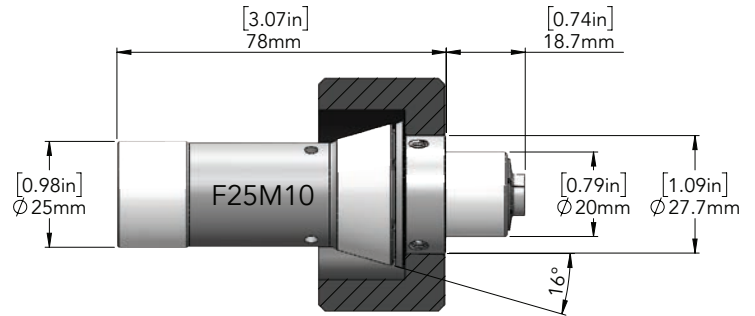

### F37M10 CARTRIDGE

Fits many 25mm and 32mm capacity machines from Citizen, Star, Tsugami, Tornos, Traub, Nomura, Hanwha, Nexturn, Maier, etc.

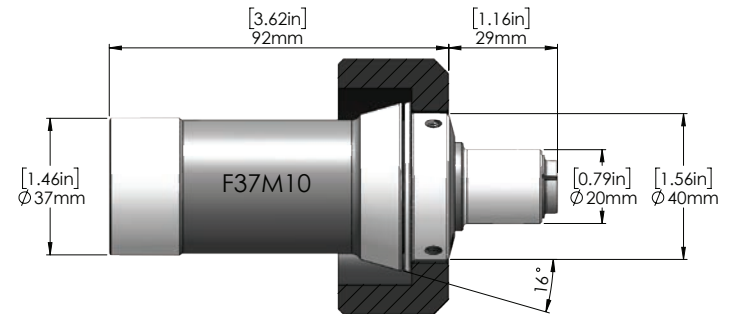
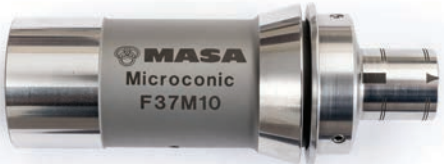

### 5CM10 CARTRIDGE

Fits any machine or fixture that uses 5C collets.

- Great for gang-tool CNC lathes like Hardinge GT, OmniTurn, etc.
  - tighter tool spacing
  - precision chucking force control
  - better concentricity
- Ideal for rotary fixtures on CNC mills

- Tool and cutter grinders
- Eliminate the hassle of extended nose collets
- Solid extended nose gives superior access for tooling while maintaining 5 micron/.0002" concentricity
- MicroGrad dial control of collet closure regardless of the machine's hydraulic or pneumatic pressure
- Workpiece stop mount available (SMT5)

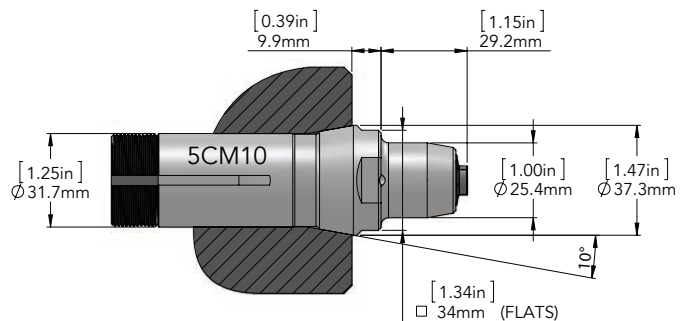



## UM5 AND UM10 MICROCONIC COLLETS



Microconic collets work in concert with our Microconic cartridges to deliver the most accurate, rigid, and reliable work holding system for high-precision small parts machining. The word “Microconic” comes from the unique way we produce each conical segment of the precision ground clamping surfaces to ensure centralized contact for extreme repeatability. As a result, Microconic collets are inherently more accurate and repeatable than traditional collets.

Our proprietary heat treatment and 5-step grinding process results in the most accurate and rigid collets made. Whether you need our regular or over-grip collets, they are the absolute best!

EVERY SIZE AVAILABLE TO SHIP WITHIN 2 DAYS.

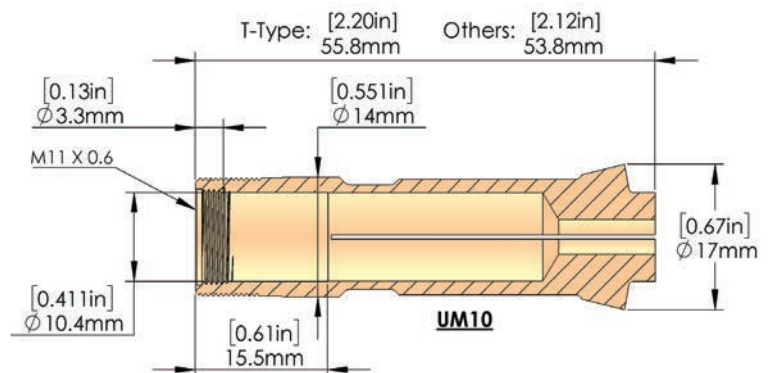
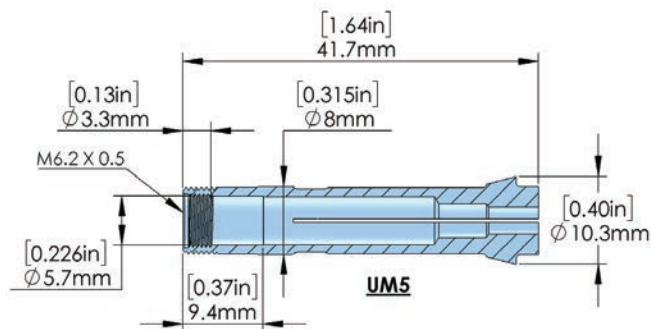

## MICROCONIC REGULAR COLLETS

Our Microconic regular collets have game-changing rigidity with superb accuracy that will allow you to perform challenging operations that were difficult or impossible with conventional collets. Used with our Microconic cartridges, they eliminate the need for extended nose collets. They grip tighter yet can hold the most fragile workpiece without damage.

- Concentricity 5 microns (.0002") or better TIR
- Eliminates the need for extended nose collets
- Rigidity for the most demanding operations



- Internal thread for available EGS work support
- Available now for any size: UM5 from Ø0.2mm - 5.5mm (.008" - .217"), UM10 from Ø0.25mm - 10mm (.010" - .394")

## MICROCONIC OVER-GRIP COLLETS

Microconic over-grip collets are like nothing else you have ever seen. They open up to Ø4mm (.156") larger to reach behind flanges, headed parts, and any enlarged feature. Due to our proprietary Microconic geometry, they have the same accuracy and rigidity as our industry-best regular collets! Now you can over-grip and do real machining like heavy drilling/milling/turning, blind hole broaching, etc. Choose to run parts the best way out, rather than be limited by conventional collets. Make serious profit from your sub-spindle!

- Opens up to Ø4mm (.156") larger than holding diameter\*
- Concentricity 5 microns (.0002") TIR
- Rigidity for heavy operations
- Internal thread for available EGS guide sleeve blanks, to help part ejection. See page 14 for details.
- Eliminate secondary operations
- Turn parts around to run "the right way out"
- Profit from your sub-spindle!
- Use our available "Standard Modifications" to fit your part exactly as needed. See page 15 for details.
- All sizes available to ship in 2 days or less



### SHORT LAND

**W-TYPE:** Our most popular over-grip type, these have a gripping length of about 1x diameter.\*



### LONGER LAND

**T-TYPE:** Intended for longer parts, this type has a gripping length of about 2x-3x diameter.\*



### LARGER DIAMETER

**V-TYPE:** Similar to W-type but optimized for larger diameter parts, these have a larger throat diameter.\*

\* For collet details not shown here, see tables beginning on page 18.



## UM5 AND UM10 MICROCONIC SYSTEM ACCESSORIES



### MICROGRAD DIAL WRENCH

Included with each cartridge, the Micrograd™ Dial Wrench is a dual-purpose tool used to install and adjust the collet in the cartridge. With dial graduations in either .02mm or .001-inch increments, the closure of the Microconic collet can be set with calibrated precision using a common pin gage the diameter of

the work piece. This setting is held internally by the cartridge and remains stable regardless of variations in the machine's closing pressure. In fact, the setting can be recorded in the job setup plan and precisely repeated in a later setup or even on a different machine! No guesswork or skilled "feel" is needed.

MACHINING CONDITION	RECOMMENDED MICROGRAD SETTING	
VERY LIGHT – thin walls, micro-size parts	0 – 0.02 mm	0 – .001"
LIGHT TO MODERATE – skim cutting, facing, ID chamfer, smaller parts	0.02 – 0.06 mm	.001 – .002"
MODERATE – turning, boring, small drilling, small threading	0.04 – 0.08 mm	.0015 – .003"
HEAVY – turning, milling, drilling, threading, cross-drilling	0.08 – 0.1 mm	.003 – .004"
EXTREME – large drilling, blind hole broaching, heavy milling	0.1+ mm	.004"+

### MASA SCREWDRIVER

Supplied with each cartridge, these custom hex screwdrivers make it easy to tighten the collet lock screw with appropriate force.



SKU	ITEM #	ITEM DESCRIPTION
124972	CW5-E	Micrograd Dial Collet Wrench for UM5, Inch Graduations
124973	CW5-M	Micrograd Dial Collet Wrench for UM5, Metric Graduations
122002	CW10-E	Micrograd Dial Collet Wrench for UM10, Inch Graduations
122005	CW10-M	Micrograd Dial Collet Wrench for UM10, Metric Graduations
122017	HSD9	Screwdriver, Masa .035" (0.9mm) Hex
122003	HSD15	Screwdriver, Masa 1.5mm Hex



**UM5 CARTRIDGES, COLLETS, AND ACCESSORIES**



**F25M10 CARTRIDGE  
CW10-E MICROGRAD DIAL  
HSD15 SCREWDRIVER**



**EGW5 AND EGW10 WRENCHES**

For installing EGS Guide Sleeves into collets. Use them in pairs to wrench both collet and EGS. They prevent damage to collets caused by excessive twisting force on the collet fingers.

SKU	ITEM #	ITEM DESCRIPTION
124974	EGW5	EGS Collet Wrench for UM5 (qty 1) Use two to wrench both collet and EGS.
123652	EGW10	EGS Collet Wrench for UM10 (qty 1) Use two to wrench both collet and EGS.
122014	SMT5	Stop Mount for 5CM10 cartridge; including (3) SHS1 mounting screws:
124963	UM5B-00	UM5 3-Slot Semi-Hard Blank Collet, 0 - 5.5mm (0" - .217") thru, Ø8mm max c/bore; includes SCB5 Ring
124964	UM5B-01	UM5 3-Slot Soft Steel Blank Collet, 0 - 5.5mm (0" - .217") thru, Ø8mm max c/bore; includes SCB5 Ring
124965	UM5B-02	UM5 3-Slot Full-Hard Blank Collet, 0 - 5.5mm (0" - .217") thru, Ø8mm max c/bore; includes SCB5 Ring
124967	UM5B-03	UM5 2-Slot Full-Hard Blank Collet, 0 - 5.5mm (0" - .217") thru, Ø8mm max c/bore; includes SCB5-2 Ring
124966	UM5B-04	UM5 4-Slot Full-Hard Blank Collet, 0 - 5.5mm (0" - .217") thru, Ø8mm max c/bore; includes SCB5-4 Ring
123334	UM10B-00	UM10 3-Slot Semi-Hard Blank Collet, 0 - 10mm (0" - .394") thru, Ø14mm max c/bore; includes SCB10 Ring
123336	UM10B-01	UM10 3-Slot Soft Steel Blank Collet, 0 - 10mm (0" - .394") thru, Ø14mm max c/bore; includes SCB10 Ring
123337	UM10B-02	UM10 3-Slot Full-Hard Blank Collet, 0 - 10mm (0" - .394") thru, Ø14mm max c/bore; includes SCB10 Ring
123550	UM10B-03	UM10 2-Slot Full-Hard Blank Collet, 0 - 10mm (0" - .394") thru, Ø14mm max c/bore
123549	UM10B-04	UM10 4-Slot Full-Hard Blank Collet, 0 - 10mm (0" - .394") thru, Ø14mm max c/bore
124991	SCB5	Support Collar for machining of 3-Slot UM5 collets
124992	SCB5-2	Support Collar for machining of 2-Slot UM5 collets
124993	SCB5-4	Support Collar for machining of 4-Slot UM5 collets
122012	SCB10	Support Collar for machining of 3-Slot UM10 collets
124995	SCB10-2	Support Collar for machining of 2-Slot UM10 collets



# MICROCONIC EGS EJECTION GUIDE SLEEVE BLANKS

The amazing over-grip capabilities of the Microconic system can also create the challenge of how to effectively eject the part from the collet. Our assortment of available EGS blanks is designed to give you many options to work with. Typically, they are drilled through with a hole size that provides a loose fit to guide the part as it is ejected from the collet. Your machine's knock-out pin/ejector tip goes through the hole to

push out the part. Alternately, ejection can be done with through-spindle coolant or air blast, with the EGS acting as a "blow gun" nozzle to help eject the part. EGS are available in a variety of configurations and materials. Every Microconic collet has an internal thread for mounting the EGS. We also offer custom collets with pre-finished EGS installed. For a quotation, send your part drawing to [sales@masatool.com](mailto:sales@masatool.com)

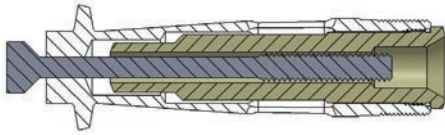

EGS bored to workpiece size and installed in T-type over-grip collet.

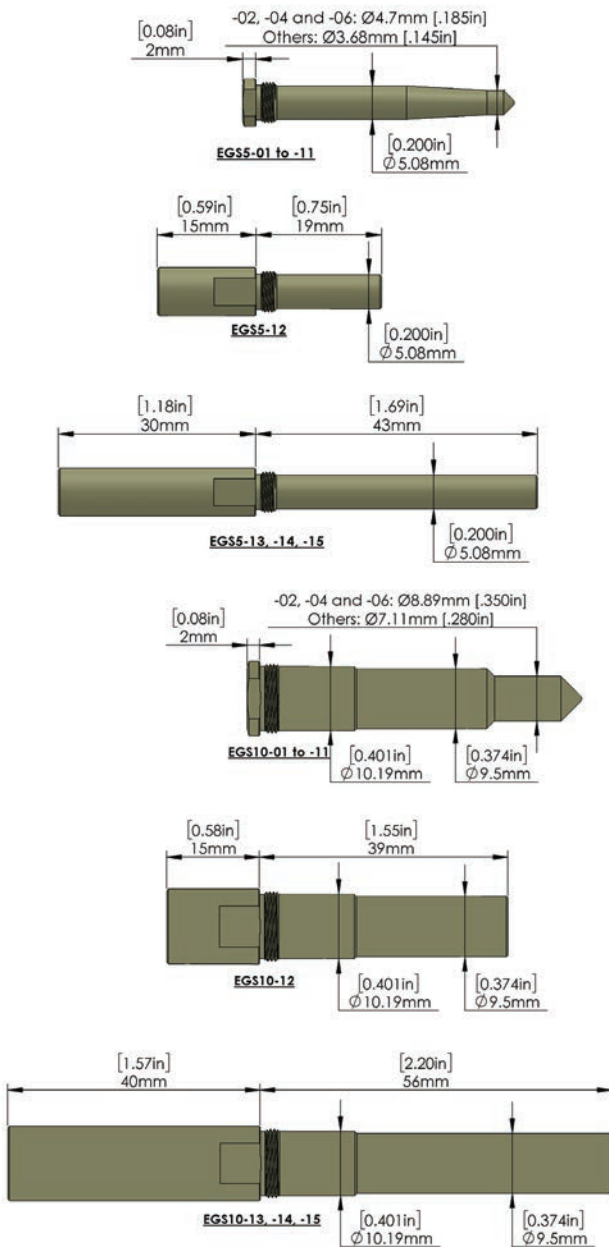

Full dimensioned drawings available upon request.

## EGS EJECTION GUIDE SLEEVE BLANKS

Function	Usage	Material	SKU	Item No.	
Standard	UM5W	Brass	124976	EGS5-01	
	UM5T*, UM5W	Stainless Steel	124977	EGS5-03	
		Plastic	124978	EGS5-05	
	UM5T	-90 to -150	Brass	124982	EGS5-07
		-155 to -230	Brass	124983	EGS5-08
		-235 to -285	Brass	124984	EGS5-09
		-290 to -365	Brass	124985	EGS5-10
		-370 and up	Brass	124986	EGS5-11
	UM5V	Brass	124979	EGS5-02	
		Stainless Steel	124980	EGS5-04	
		Plastic	124981	EGS5-06	
Short Ext.	Any UM5 Type	Stainless Steel	124987	EGS5-12	
Long Extended	Any UM5 Type*	Stainless Steel	124988	EGS5-13	
		A2 Tool Steel	124989	EGS5-14	
		Brass	124990	EGS5-15	
Standard	UM10W	Brass	122004	EGS10-01	
	UM10T*, UM10W	Stainless Steel	122022	EGS10-03	
		Plastic	122024	EGS10-05	
	UM10T	-155 to -240	Brass	122028	EGS10-07
		-245 to -325	Brass	122029	EGS10-08
		-330 to -420	Brass	122030	EGS10-09
		-425 to -530	Brass	122031	EGS10-10
		-535 and up	Brass	122032	EGS10-11
	UM10V	Brass	122018	EGS10-02	
		Stainless Steel	122023	EGS10-04	
Plastic		122025	EGS10-06		
Short Ext.	Any UM10 Type	Stainless Steel	122033	EGS10-12	
Long Extended	Any UM10 Type*	Stainless Steel	122045	EGS10-13	
		A2 Tool Steel	122047	EGS10-14	
		Brass	122048	EGS10-15	

\* Must trim to length as needed

# UM5 AND UM10 MICROCONIC STANDARD MODIFICATIONS

At Masa Tool we want to solve your work holding problems now. These standard modifications can be applied to any of our UM5 or UM10 series collets, all within our normal 2 day lead time.

We have dedicated machinery and a fantastic team ready to apply these modifications to suit your particular application.

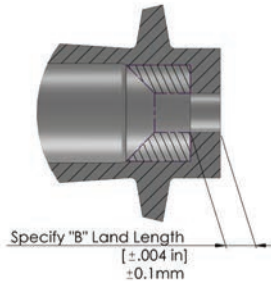

## BML – Back Modified Land

Reduce the grip land length by removing material from the internal “back” side. This leaves a flat-bottom shoulder as shown in the diagram. Especially useful for over-gripping into a limited space. Applicable to any Microconic collet. To order, add an additional line item BML and specify the desired “B” dimension (land length). Standard tolerance is +/-0.1mm (+/-0.004”). AVAILABLE TO SHIP IN 2 DAYS

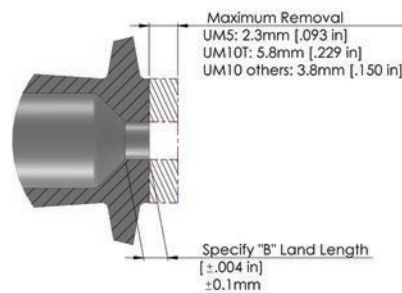

## FML – Front Modified Land

Reduce the grip land length by removing material from the front of the collet. This also shortens the collet nose. A less expensive option than BML, and is preferred to maintain maximum collet rigidity. Removal amount is limited as shown in the diagram. To order, add an additional line item FML and specify the desired “B” dimension (land length). Standard tolerance is +/-0.1mm (+/-0.004”). AVAILABLE TO SHIP IN 2 DAYS

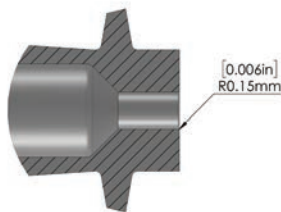

## RB – Radius Edge Break

Smooth the edge of the gripping diameter with a blend radius. Size is approximate. A good option when gripping softer metals with critical surface finish. AVAILABLE TO SHIP IN 2 DAYS

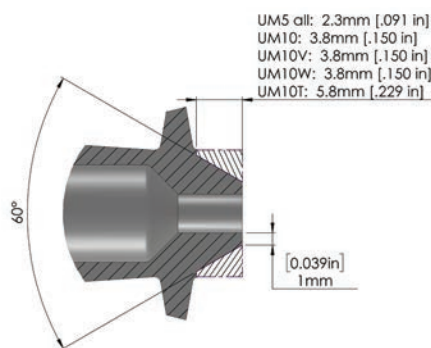

## TN – Taper Nose

Reduce the collet nose to provide maximal clearance for cutting tool access. Especially useful for micro-size parts. AVAILABLE TO SHIP IN 2 DAYS



## GMAX – Enlarge ØG to Maximize Over-Grip

This is an additional grind operation to enlarge the opening of any over-grip collet beyond the stock “G” diameter shown in the tables. The enlargement amount varies, but about 10% is typical. It causes some reduction of grip land contact surface. For specifics, send a part drawing to sales@masatool.com. AVAILABLE TO SHIP IN 2 DAYS



## UM5 AND UM10 MICROCONIC CUSTOM COLLETS

The Microconic system has a huge selection of standard collets and standard modifications available to fit most needs without requiring custom collets, but sometimes only a custom will do. Masa Tool can make a variety of custom collets to suit your

application. Note that the largest thru diameter capacity for a UM10 is  $\text{Ø}10.1\text{mm}$  (.398") and  $\text{Ø}5.5\text{mm}$  (.217") for a UM5. For a quote, send your part drawing to [sales@masatool.com](mailto:sales@masatool.com)

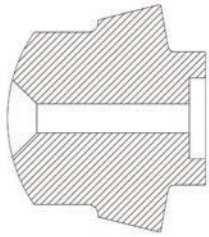

**COUNTERBORE**

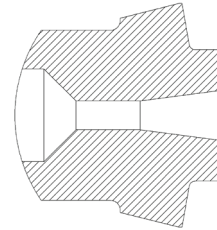

**TAPERED**



**PROFILES**

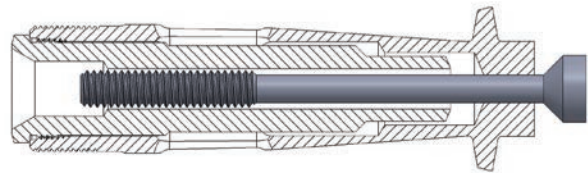

**PRE-DRILLED AND INSTALLED EJECTION GUIDE SLEEVE (EGS)**

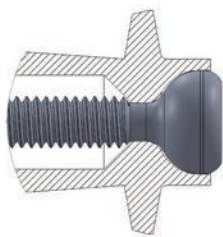

**COMPLEX FORMS**

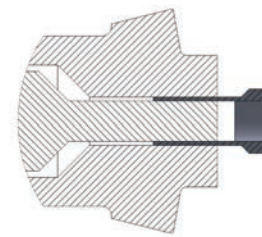

**INTERNAL SUPPORT**





# UM5 MICROCONIC COLLETS

Part Size Range	ØA		SKU	Item Number	B		ØG		ØC1		D1		ØC2		D2	
	mm	inch			mm	inch	mm	inch	mm	inch	mm	inch	mm	inch	mm	inch
0.2	.175	.0079	124343	UM5-20	1.5	.07	-	-	-	-	-	-	-	-	-	-
	.215	.0085	124558	UM5W-20	2.1	.09	4	.15	3.8	.15	3.9	.15	5.3	.21	16.2	.64
0.225	.20	.0079	124344	UM5-22	1.5	.07	-	-	-	-	-	-	-	-	-	-
	.24	.0094	124559	UM5W-22	2.1	.09	4	.15	3.8	.15	3.9	.15	5.3	.21	16.2	.64
0.25	.225	.0098	124345	UM5-25	1.6	.07	-	-	-	-	-	-	-	-	-	-
	.265	.0104	124560	UM5W-25	2.1	.09	4	.15	3.8	.15	3.9	.15	5.3	.21	16.2	.64
0.275	.25	.0108	124346	UM5-27	1.6	.07	-	-	-	-	-	-	-	-	-	-
	.29	.0114	124561	UM5W-27	2.1	.09	4	.15	3.8	.15	3.9	.15	5.3	.21	16.2	.64
0.3	.275	.0118	124347	UM5-30	1.6	.07	-	-	-	-	-	-	-	-	-	-
	.315	.0124	124562	UM5W-30	2.1	.09	4	.15	3.8	.15	3.9	.15	5.3	.21	16.2	.64
0.325	.30	.0128	124348	UM5-32	1.6	.07	-	-	-	-	-	-	-	-	-	-
	.34	.0134	124563	UM5W-32	2.1	.09	4	.15	3.8	.15	3.9	.15	5.3	.21	16.2	.64
0.35	.325	.0138	124349	UM5-35	1.6	.07	-	-	-	-	-	-	-	-	-	-
	.365	.0144	124564	UM5W-35	2.1	.09	4.1	.15	3.8	.15	3.9	.15	5.3	.21	16.2	.64
0.375	.35	.0148	124350	UM5-37	2.9	.12	-	-	-	-	-	-	-	-	-	-
	.39	.0154	124565	UM5W-37	2.1	.09	4	.15	3.9	.15	3.9	.15	5.3	.21	16.2	.64
0.4	.375	.0157	124351	UM5-40	2.9	.12	-	-	-	-	-	-	-	-	-	-
	.415	.0163	124566	UM5W-40	2.1	.09	4.1	.15	3.9	.15	3.9	.15	5.3	.21	16.2	.64
0.425	.40	.0167	124352	UM5-42	2.9	.12	-	-	-	-	-	-	-	-	-	-
	.44	.0173	124567	UM5W-42	2.2	.09	4.1	.16	3.9	.15	3.9	.15	5.3	.21	16.2	.64
0.45	.425	.0177	124353	UM5-45	2.9	.12	-	-	-	-	-	-	-	-	-	-
	.465	.0183	124568	UM5W-45	2.2	.09	4.1	.16	3.9	.15	3.9	.15	5.3	.21	16.2	.64
0.475	.45	.0187	124354	UM5-47	2.9	.12	-	-	-	-	-	-	-	-	-	-
	.49	.0193	124569	UM5W-47	2.2	.09	4.1	.16	3.9	.15	3.9	.15	5.3	.21	16.2	.64
0.5	.475	.0197	124355	UM5-50	2.9	.12	-	-	-	-	-	-	-	-	-	-
	.515	.0203	124570	UM5W-50	2.2	.09	4.1	.16	3.9	.15	3.9	.15	5.3	.21	16.2	.64
0.525	.50	.0207	124356	UM5-52	2.9	.12	-	-	-	-	-	-	-	-	-	-
	.54	.0213	124571	UM5W-52	2.2	.09	4.1	.16	3.9	.15	3.9	.15	5.3	.21	16.2	.64
0.55	.525	.0217	124357	UM5-55	2.9	.12	-	-	-	-	-	-	-	-	-	-
	.565	.0222	124572	UM5W-55	2.2	.09	4.1	.16	3.9	.15	3.9	.15	5.3	.21	16.2	.64
0.575	.55	.0226	124358	UM5-57	2.9	.12	-	-	-	-	-	-	-	-	-	-
	.59	.0232	124573	UM5W-57	2.2	.09	4.2	.16	3.9	.15	3.9	.15	5.3	.21	16.2	.64
0.6	.575	.0236	124359	UM5-60	2.9	.12	-	-	-	-	-	-	-	-	-	-
	.615	.0242	124574	UM5W-60	2.2	.09	4.2	.16	3.9	.15	3.9	.15	5.3	.21	16.2	.64
0.625	.60	.0246	124360	UM5-62	2.9	.12	-	-	-	-	-	-	-	-	-	-
	.64	.0252	124575	UM5W-62	2.3	.09	4.2	.16	3.9	.15	3.9	.15	5.3	.21	16.2	.64
0.65	.625	.0256	124361	UM5-65	2.9	.12	-	-	-	-	-	-	-	-	-	-
	.665	.0262	124576	UM5W-65	2.3	.09	4.2	.16	3.9	.15	3.9	.15	5.3	.21	16.2	.64
0.675	.65	.0266	124362	UM5-67	2.9	.12	-	-	-	-	-	-	-	-	-	-
	.69	.0272	124577	UM5W-67	2.3	.09	4.2	.16	3.9	.15	3.9	.15	5.3	.21	16.2	.64
0.7	.675	.0276	124363	UM5-70	2.9	.12	-	-	-	-	-	-	-	-	-	-
	.715	.0281	124578	UM5W-70	2.3	.09	4.2	.16	3.9	.15	3.9	.15	5.3	.21	16.2	.64
0.725	.70	.0285	124364	UM5-72	3	.12	-	-	-	-	-	-	-	-	-	-
	.74	.0291	124579	UM5W-72	2.3	.10	4.2	.16	3.9	.15	3.9	.15	5.3	.21	16.2	.64
0.75	.725	.0295	124365	UM5-75	3	.12	-	-	-	-	-	-	-	-	-	-
	.765	.0301	124580	UM5W-75	2.3	.10	4.3	.16	3.9	.15	3.9	.15	5.3	.21	16.2	.64

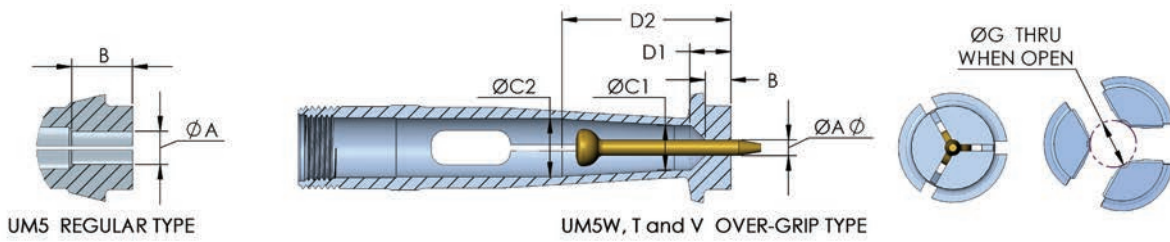

**UM5** - Regular Type   **UM5W** - Short Land Over-grip   **UM5T** - Long Land Over-grip   **UM5V** - Larger Capacity Over-grip

Part Size Range	ØA		SKU	Item Number	B		ØG		ØC1		D1		ØC2		D2	
	mm	inch			mm	inch	mm	inch	mm	inch	mm	inch	mm	inch	mm	inch
0.775	.74	.0305	124366	UM5-77	3	.12	-	-	-	-	-	-	-	-	-	-
	.80	.0315	124581	UM5W-77	2.3	.10	4.3	.16	3.9	.15	3.9	.15	5.3	.21	16.2	.64
0.8	.765	.0315	124367	UM5-80	3	.12	-	-	-	-	-	-	-	-	-	-
	.825	.0325	124582	UM5W-80	2.3	.10	4.3	.16	3.9	.15	3.9	.15	5.3	.21	16.2	.64
0.825	.79	.0325	124368	UM5-82	3	.12	-	-	-	-	-	-	-	-	-	-
	.85	.0335	124583	UM5W-82	2.3	.10	4.3	.16	3.9	.15	3.9	.15	5.3	.21	16.2	.64
0.85	.815	.0335	124369	UM5-85	3	.12	-	-	-	-	-	-	-	-	-	-
	.875	.0344	124584	UM5W-85	2.4	.10	4.3	.17	3.9	.15	3.9	.15	5.3	.21	16.2	.64
0.875	.84	.0344	124370	UM5-87	3.3	.13	-	-	-	-	-	-	-	-	-	-
	.90	.0354	124585	UM5W-87	2.3	.10	4.3	.16	3.9	.15	3.9	.15	5.3	.21	16.2	.64
0.9	.865	.0354	124371	UM5-90	3.3	.13	-	-	-	-	-	-	-	-	-	-
			124586	UM5W-90	2.4	.10	4.3	.16	3.9	.15	3.9	.15	5.3	.21	16.2	.64
	.925	.0364	124709	UM5T-90	4.3	.18	4	.15	3.9	.15	5	.20	5.3	.21	21.8	.86
0.925	.89	.0364	124372	UM5-92	3.3	.13	-	-	-	-	-	-	-	-	-	-
			124587	UM5W-92	2.4	.10	4.3	.17	3.9	.15	3.9	.15	5.3	.21	16.2	.64
	.95	.0374	124710	UM5T-92	4.3	.18	4	.15	3.9	.15	5	.20	5.3	.21	21.8	.86
0.95	.915	.0374	124373	UM5-95	3.3	.13	-	-	-	-	-	-	-	-	-	-
			124588	UM5W-95	2.4	.10	4.3	.17	3.9	.15	3.9	.15	5.3	.21	16.2	.64
	.975	.0384	124711	UM5T-95	4.3	.18	4	.15	3.9	.15	5	.20	5.3	.21	21.8	.86
0.975	.94	.0384	124374	UM5-97	3.3	.13	-	-	-	-	-	-	-	-	-	-
			124589	UM5W-97	2.4	.10	4.4	.17	3.9	.15	3.9	.15	5.3	.21	16.2	.64
	1.00	.0394	124712	UM5T-97	4.3	.18	4.1	.15	3.9	.15	5	.20	5.3	.21	21.8	.86
1	.965	.0394	124375	UM5-100	3.8	.15	-	-	-	-	-	-	-	-	-	-
			124590	UM5W-100	2.4	.10	4.4	.17	3.9	.15	3.9	.15	5.3	.21	16.2	.64
	1.025	.0404	124713	UM5T-100	4.4	.18	4.1	.16	3.9	.15	5	.20	5.3	.21	21.8	.86
1.025	.99	.0404	124376	UM5-102	3.8	.15	-	-	-	-	-	-	-	-	-	-
			124591	UM5W-102	2.4	.10	4.4	.17	3.9	.15	3.9	.15	5.3	.21	16.2	.64
	1.05	.0413	124714	UM5T-102	4.4	.18	4.1	.16	3.9	.15	5	.20	5.3	.21	21.8	.86
1.05	1.015	.0413	124377	UM5-105	3.8	.16	-	-	-	-	-	-	-	-	-	-
			124592	UM5W-105	2.4	.10	4.4	.17	3.9	.15	3.9	.15	5.3	.21	16.2	.64
	1.075	.0423	124715	UM5T-105	4.4	.18	4.1	.16	3.9	.15	5	.20	5.3	.21	21.8	.86
1.075	1.04	.0423	124378	UM5-107	3.8	.16	-	-	-	-	-	-	-	-	-	-
			124593	UM5W-107	2.4	.10	4.4	.17	3.9	.15	3.9	.15	5.3	.21	16.2	.64
	1.10	.0433	124716	UM5T-107	4.4	.18	4.1	.16	3.9	.15	5	.20	5.3	.21	21.8	.86
1.1	1.065	.0433	124379	UM5-110	3.8	.16	-	-	-	-	-	-	-	-	-	-
			124594	UM5W-110	2.5	.10	4.4	.17	3.9	.15	3.9	.15	5.3	.21	16.2	.64
	1.125	.0443	124717	UM5T-110	4.4	.18	4.1	.16	3.9	.15	5	.20	5.3	.21	21.8	.86
1.125	1.09	.0443	124380	UM5-112	3.8	.16	-	-	-	-	-	-	-	-	-	-
			124595	UM5W-112	2.5	.10	4.5	.17	3.9	.15	3.9	.15	5.3	.21	16.2	.64
	1.15	.0453	124718	UM5T-112	4.4	.18	4.2	.16	3.9	.15	5	.20	5.3	.21	21.8	.86

# UM5 MICROCONIC COLLETS

Part Size Range $\phi A$			SKU	Item Number	B		$\phi G$		$\phi C1$		D1		$\phi C2$		D2	
mm	inch				mm	inch	mm	inch	mm	inch	mm	inch	mm	inch	mm	inch
1.15	1.115 1.175	.0453 .0463	124381	UM5-115	3.9	.16	-	-	-	-	-	-	-	-	-	-
			124596	UM5W-115	2.5	.10	4.5	.17	3.9	.15	3.9	.15	5.3	.21	16.2	.64
			124719	UM5T-115	4.4	.18	4.2	.16	3.9	.15	5	.20	5.3	.21	21.8	.86
1.175	1.14 1.20	.0463 .0472	124382	UM5-117	4.4	.18	-	-	-	-	-	-	-	-	-	-
			124597	UM5W-117	2.5	.10	4.5	.17	3.9	.15	3.9	.15	5.3	.21	16.2	.64
			124720	UM5T-117	4.4	.18	4.2	.16	3.9	.15	5	.20	5.3	.21	21.8	.86
1.2	1.165 1.225	.0472 .0482	124383	UM5-120	4.4	.18	-	-	-	-	-	-	-	-	-	-
			124598	UM5W-120	2.5	.10	4.5	.17	3.9	.15	3.9	.15	5.3	.21	16.2	.64
			124721	UM5T-120	4.4	.18	4.2	.16	3.9	.15	5	.20	5.3	.21	21.8	.86
1.225	1.19 1.25	.0482 .0492	124384	UM5-122	4.4	.18	-	-	-	-	-	-	-	-	-	-
			124599	UM5W-122	2.5	.10	4.5	.17	3.9	.15	3.9	.15	5.3	.21	16.2	.64
			124722	UM5T-122	4.4	.18	4.2	.16	3.9	.15	5	.20	5.3	.21	21.8	.86
1.25	1.215 1.275	.0492 .0502	124385	UM5-125	4.4	.18	-	-	-	-	-	-	-	-	-	-
			124600	UM5W-125	2.5	.10	4.6	.17	3.9	.15	3.9	.15	5.3	.21	16.2	.64
			124723	UM5T-125	4.4	.18	4.3	.16	3.9	.15	5	.20	5.3	.21	21.8	.86
1.275	1.24 1.30	.0502 .0512	124386	UM5-127	4.4	.18	-	-	-	-	-	-	-	-	-	-
			124601	UM5W-127	2.6	.11	4.6	.17	3.9	.15	3.9	.15	5.3	.21	16.2	.64
			124724	UM5T-127	4.4	.18	4.3	.16	3.9	.15	5	.20	5.3	.21	21.8	.86
1.3	1.265 1.325	.0512 .0522	124387	UM5-130	4.4	.18	-	-	-	-	-	-	-	-	-	-
			124602	UM5W-130	2.6	.11	4.6	.18	3.9	.15	3.9	.15	5.3	.21	16.2	.64
			124725	UM5T-130	4.4	.18	4.3	.16	3.9	.15	5	.20	5.3	.21	21.8	.86
1.325	1.29 1.35	.0522 .0531	124388	UM5-132	4.7	.19	-	-	-	-	-	-	-	-	-	-
			124603	UM5W-132	2.6	.11	4.6	.18	3.9	.15	3.9	.15	5.3	.21	16.2	.64
			124726	UM5T-132	4.4	.18	4.4	.17	3.9	.15	5	.20	5.3	.21	21.8	.86
1.35	1.315 1.375	.0531 .0541	124389	UM5-135	4.7	.19	-	-	-	-	-	-	-	-	-	-
			124604	UM5W-135	2.6	.11	4.7	.18	3.9	.15	3.9	.15	5.3	.21	16.2	.64
			124727	UM5T-135	4.4	.18	4.4	.17	3.9	.15	5	.20	5.3	.21	21.8	.86
1.375	1.34 1.40	.0541 .0551	124390	UM5-137	4.7	.19	-	-	-	-	-	-	-	-	-	-
			124605	UM5W-137	2.6	.11	4.7	.18	3.9	.15	3.9	.15	5.3	.21	16.2	.64
			124728	UM5T-137	4.4	.18	4.4	.17	3.9	.15	5	.20	5.3	.21	21.8	.86
1.4	1.365 1.425	.0551 .0561	124391	UM5-140	4.7	.19	-	-	-	-	-	-	-	-	-	-
			124606	UM5W-140	2.6	.11	4.7	.18	3.9	.15	3.9	.15	5.3	.21	16.2	.64
			124729	UM5T-140	4.4	.18	4.4	.17	3.9	.15	5	.20	5.3	.21	21.8	.86
1.425	1.39 1.45	.0561 .0571	124392	UM5-142	4.7	.19	-	-	-	-	-	-	-	-	-	-
			124607	UM5W-142	2.6	.11	4.7	.18	3.9	.15	3.9	.15	5.3	.21	16.2	.64
			124730	UM5T-142	4.5	.18	4.4	.17	3.9	.15	5	.20	5.3	.21	21.8	.86
1.45	1.415 1.475	.0571 .0581	124393	UM5-145	5.2	.21	-	-	-	-	-	-	-	-	-	-
			124608	UM5W-145	2.7	.11	4.7	.18	3.9	.15	3.9	.15	5.3	.21	16.2	.64
			124731	UM5T-145	4.5	.18	4.4	.17	3.9	.15	5	.20	5.3	.21	21.8	.86
1.475	1.44 1.50	.0581 .0591	124394	UM5-147	5.2	.21	-	-	-	-	-	-	-	-	-	-
			124609	UM5W-147	2.7	.11	4.7	.18	3.9	.15	3.9	.15	5.3	.21	16.2	.64
			124732	UM5T-147	4.5	.18	4.5	.17	3.9	.15	5	.20	5.3	.21	21.8	.86
1.5	1.465 1.525	.0591 .0600	124395	UM5-150	5.2	.21	-	-	-	-	-	-	-	-	-	-
			124610	UM5W-150	2.7	.11	4.8	.18	3.9	.15	3.9	.15	5.3	.21	16.2	.64
			124733	UM5T-150	4.5	.18	4.5	.17	3.9	.15	5	.20	5.3	.21	21.8	.86

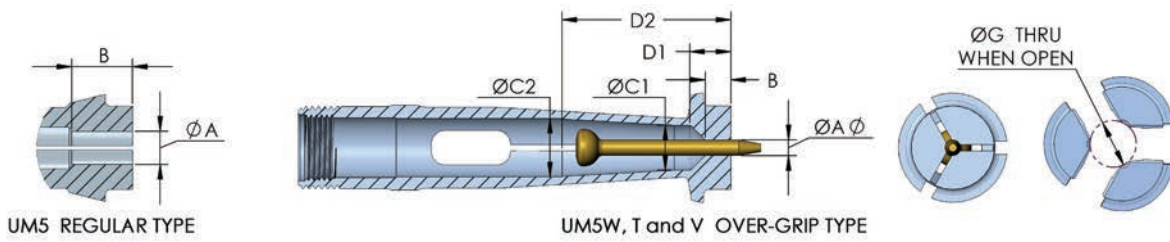

**UM5** - Regular Type **UM5W** - Short Land Over-grip **UM5T** - Long Land Over-grip **UM5V** - Larger Capacity Over-grip

Part Size Range	ØA	SKU	Item Number	B		ØG		ØC1		D1		ØC2		D2		
				mm	inch	mm	inch	mm	inch	mm	inch	mm	inch	mm	inch	
1.525	1.49 1.55	.0600 .0587 .0610	124396	UM5-152	5.2	.21	-	-	-	-	-	-	-	-	-	-
			124611	UM5W-152	2.7	.11	4.8	.18	3.9	.15	3.9	.15	5.3	.21	16.2	.64
			124734	UM5T-152	4.5	.18	4.5	.17	3.9	.15	5	.20	5.3	.21	21.8	.86
1.55	1.515 1.575	.0610 .0596 .0620	124397	UM5-155	5.2	.21	-	-	-	-	-	-	-	-	-	-
			124612	UM5W-155	2.7	.11	4.8	.18	3.9	.15	3.9	.15	5.3	.21	16.2	.64
			124735	UM5T-155	4.5	.18	4.5	.17	3.9	.15	5	.20	5.3	.21	21.8	.86
1.575	1.54 1.60	.0620 .0606 .0630	124398	UM5-157	5.3	.21	-	-	-	-	-	-	-	-	-	-
			124613	UM5W-157	2.7	.11	4.8	.18	3.9	.15	3.9	.15	5.3	.21	16.2	.64
			124736	UM5T-157	4.5	.18	4.5	.17	3.9	.15	5	.20	5.3	.21	21.8	.86
1.6	1.565 1.625	.0630 .0616 .0640	124399	UM5-160	5.3	.21	-	-	-	-	-	-	-	-	-	-
			124614	UM5W-160	2.7	.11	4.8	.18	3.9	.15	3.9	.15	5.3	.21	16.2	.64
			124737	UM5T-160	4.5	.18	4.5	.17	3.9	.15	5	.20	5.3	.21	21.8	.86
1.625	1.59 1.65	.0640 .0626 .0650	124400	UM5-162	5.5	.22	-	-	-	-	-	-	-	-	-	-
			124615	UM5W-162	2.8	.11	4.9	.19	3.9	.15	3.9	.15	5.3	.21	16.2	.64
			124738	UM5T-162	4.8	.19	4.5	.17	3.9	.15	5.3	.21	5.3	.21	21.8	.86
1.65	1.615 1.675	.0650 .0636 .0659	124401	UM5-165	5.5	.22	-	-	-	-	-	-	-	-	-	-
			124616	UM5W-165	2.8	.11	4.9	.19	3.9	.15	3.9	.15	5.3	.21	16.2	.64
			124739	UM5T-165	4.8	.19	4.6	.17	3.9	.15	5.3	.21	5.3	.21	21.8	.86
1.675	1.64 1.70	.0659 .0646 .0669	124402	UM5-167	5.5	.22	-	-	-	-	-	-	-	-	-	-
			124617	UM5W-167	2.8	.11	4.9	.19	3.9	.15	3.9	.15	5.3	.21	16.2	.64
			124740	UM5T-167	4.8	.19	4.6	.18	3.9	.15	5.3	.21	5.3	.21	21.8	.86
1.7	1.665 1.725	.0669 .0656 .0679	124403	UM5-170	5.5	.22	-	-	-	-	-	-	-	-	-	-
			124618	UM5W-170	2.8	.11	4.9	.19	3.9	.15	3.9	.15	5.3	.21	16.2	.64
			124741	UM5T-170	4.8	.19	4.6	.18	3.9	.15	5.3	.21	5.3	.21	21.8	.86
			124832	UM5V-170	2.8	.11	4	.15	4.8	.19	4.3	.17	5.3	.21	16.2	.64
1.725	1.69 1.75	.0679 .0665 .0689	124404	UM5-172	5.6	.22	-	-	-	-	-	-	-	-	-	-
			124619	UM5W-172	2.8	.12	4.9	.19	3.9	.15	3.9	.15	5.3	.21	16.2	.64
			124742	UM5T-172	4.8	.19	4.6	.18	3.9	.15	5.3	.21	5.3	.21	21.8	.86
			124833	UM5V-172	2.8	.12	4	.15	4.8	.19	4.3	.17	5.3	.21	16.2	.64
1.75	1.715 1.775	.0689 .0675 .0699	124405	UM5-175	5.6	.22	-	-	-	-	-	-	-	-	-	-
			124620	UM5W-175	2.8	.12	5	.19	3.9	.15	3.9	.15	5.3	.21	16.2	.64
			124743	UM5T-175	4.8	.19	4.6	.18	3.9	.15	5.3	.21	5.3	.21	21.8	.86
			124834	UM5V-175	2.8	.12	4	.15	4.8	.19	4.3	.17	5.3	.21	16.2	.64
1.775	1.74 1.80	.0699 .0685 .0709	124406	UM5-177	6.1	.24	-	-	-	-	-	-	-	-	-	-
			124621	UM5W-177	2.8	.12	5	.19	3.9	.15	3.9	.15	5.3	.21	16.2	.64
			124744	UM5T-177	5.1	.21	4.6	.18	3.9	.15	5.6	.22	5.3	.21	21.8	.86
			124835	UM5V-177	2.8	.12	4.1	.15	4.8	.19	4.3	.17	5.3	.21	16.2	.64
1.8	1.765 1.825	.0709 .0695 .0719	124407	UM5-180	6.1	.24	-	-	-	-	-	-	-	-	-	-
			124622	UM5W-180	2.8	.12	5	.19	3.9	.15	3.9	.15	5.3	.21	16.2	.64
			124745	UM5T-180	5.1	.21	4.6	.18	3.9	.15	5.6	.22	5.3	.21	21.8	.86
			124836	UM5V-180	2.8	.12	4.1	.16	4.8	.19	4.3	.17	5.3	.21	16.2	.64

# UM5 MICROCONIC COLLETS

Part Size Range $\phi A$			SKU	Item Number	B		$\phi G$		$\phi C1$		D1		$\phi C2$		D2	
mm	inch				mm	inch	mm	inch	mm	inch	mm	inch	mm	inch	mm	inch
1.825	1.79 1.85	.0719 .0728	124408	UM5-182	6.1	.24	-	-	-	-	-	-	-	-	-	-
			124623	UM5W-182	2.8	.12	5	.19	3.9	.15	3.9	.15	5.3	.21	16.2	.64
			124746	UM5T-182	5.1	.21	4.7	.18	3.9	.15	5.6	.22	5.3	.21	21.8	.86
			124837	UM5V-182	2.8	.12	4.1	.16	4.8	.19	4.3	.17	5.3	.21	16.2	.64
1.85	1.815 1.875	.0728 .0738	124409	UM5-185	6.1	.24	-	-	-	-	-	-	-	-	-	-
			124624	UM5W-185	2.9	.12	5	.19	3.9	.15	3.9	.15	5.3	.21	16.2	.64
			124747	UM5T-185	5.1	.21	4.7	.18	3.9	.15	5.6	.22	5.3	.21	21.8	.86
			124838	UM5V-185	2.9	.12	4.1	.16	4.8	.19	4.3	.17	5.3	.21	16.2	.64
1.875	1.84 1.90	.0738 .0748	124410	UM5-187	6.4	.26	-	-	-	-	-	-	-	-	-	-
			124625	UM5W-187	2.9	.12	5.1	.19	3.8	.15	3.9	.15	5.3	.21	16.2	.64
			124748	UM5T-187	5.4	.22	4.7	.18	3.9	.15	5.8	.23	5.3	.21	21.8	.86
			124839	UM5V-187	2.9	.12	4.2	.16	4.8	.18	4.3	.17	5.3	.21	16.2	.64
1.9	1.865 1.925	.0748 .0758	124411	UM5-190	6.4	.26	-	-	-	-	-	-	-	-	-	-
			124626	UM5W-190	2.9	.12	5.1	.20	3.8	.15	3.9	.15	5.3	.21	16.2	.64
			124749	UM5T-190	5.4	.22	4.7	.18	3.9	.15	5.8	.23	5.3	.21	21.8	.86
			124840	UM5V-190	2.9	.12	4.2	.16	4.8	.18	4.3	.17	5.3	.21	16.2	.64
1.925	1.89 1.95	.0758 .0768	124412	UM5-192	6.4	.26	-	-	-	-	-	-	-	-	-	-
			124627	UM5W-192	2.9	.12	5.1	.20	3.8	.15	3.9	.15	5.3	.21	16.2	.64
			124750	UM5T-192	5.4	.22	4.7	.18	3.9	.15	5.8	.23	5.3	.21	21.8	.86
			124841	UM5V-192	2.9	.12	4.2	.16	4.8	.18	4.3	.17	5.3	.21	16.2	.64
1.95	1.915 1.975	.0768 .0778	124413	UM5-195	6.4	.26	-	-	-	-	-	-	-	-	-	-
			124628	UM5W-195	2.9	.12	5.1	.20	3.8	.15	3.9	.15	5.3	.21	16.2	.64
			124751	UM5T-195	5.4	.22	4.7	.18	3.9	.15	5.8	.23	5.3	.21	21.8	.86
			124842	UM5V-195	2.9	.12	4.2	.16	4.8	.18	4.3	.17	5.3	.21	16.2	.64
1.975	1.94 2.00	.0778 .0787	124414	UM5-197	6.4	.26	-	-	-	-	-	-	-	-	-	-
			124629	UM5W-197	2.9	.12	5.1	.20	3.8	.15	3.9	.15	5.3	.21	16.2	.64
			124752	UM5T-197	5.4	.22	4.8	.18	3.9	.15	5.8	.23	5.3	.21	21.8	.86
			124843	UM5V-197	2.9	.12	4.2	.16	4.8	.18	4.3	.17	5.3	.21	16.2	.64
2	1.965 2.025	.0787 .0797	124415	UM5-200	6.4	.26	-	-	-	-	-	-	-	-	-	-
			124630	UM5W-200	2.9	.12	5.2	.20	3.8	.15	3.9	.15	5.3	.21	16.2	.64
			124753	UM5T-200	5.4	.22	4.8	.18	3.9	.15	5.8	.23	5.3	.21	21.8	.86
			124844	UM5V-200	2.9	.12	4.3	.16	4.8	.18	4.3	.17	5.3	.21	16.2	.64
2.025	1.99 2.05	.0797 .0807	124416	UM5-202	6.4	.26	-	-	-	-	-	-	-	-	-	-
			124631	UM5W-202	3	.12	5.2	.20	3.8	.15	3.9	.15	5.3	.21	16.2	.64
			124754	UM5T-202	5.4	.22	4.8	.18	3.9	.15	5.8	.23	5.3	.21	21.8	.86
			124845	UM5V-202	3	.12	4.3	.16	4.8	.18	4.3	.17	5.3	.21	16.2	.64
2.05	2.015 2.075	.0807 .0817	124417	UM5-205	6.4	.26	-	-	-	-	-	-	-	-	-	-
			124632	UM5W-205	3	.12	5.2	.20	3.8	.15	3.9	.15	5.3	.21	16.2	.64
			124755	UM5T-205	5.4	.22	4.8	.18	3.9	.15	5.8	.23	5.3	.21	21.8	.86
			124846	UM5V-205	3	.12	4.3	.16	4.8	.18	4.3	.17	5.3	.21	16.2	.64
2.075	2.04 2.10	.0817 .0827	124418	UM5-207	6.9	.28	-	-	-	-	-	-	-	-	-	-
			124633	UM5W-207	2.9	.12	5.1	.20	3.9	.15	3.9	.15	5.3	.21	16.2	.64
			124756	UM5T-207	5.8	.23	4.7	.18	3.9	.15	6.2	.24	5.3	.21	21.8	.86
			124847	UM5V-207	2.9	.12	4.2	.16	4.9	.19	4.3	.17	5.3	.21	16.2	.64

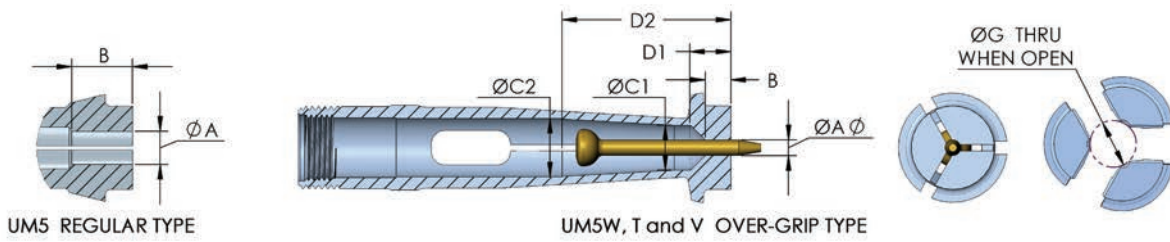

**UM5** - Regular Type **UM5W** - Short Land Over-grip **UM5T** - Long Land Over-grip **UM5V** - Larger Capacity Over-grip

Part Size Range	ØA	SKU	Item Number	B		ØG		ØC1		D1		ØC2		D2			
				mm	inch	mm	inch	mm	inch	mm	inch	mm	inch	mm	inch		
2.1	2.065 2.125			124419	UM5-210	6.9	.28	-	-	-	-	-	-	-	-	-	
				124634	UM5W-210	3	.12	5.2	.20	3.9	.15	3.9	.15	5.3	.21	16.2	.64
				124757	UM5T-210	5.8	.23	4.7	.18	3.9	.15	6.2	.24	5.3	.21	21.8	.86
				124848	UM5V-210	3	.12	4.3	.16	4.9	.19	4.3	.17	5.3	.21	16.2	.64
2.125	2.09 2.15			124420	UM5-212	6.9	.28	-	-	-	-	-	-	-	-	-	
				124635	UM5W-212	3	.12	5.2	.20	3.9	.15	3.9	.15	5.3	.21	16.2	.64
				124758	UM5T-212	5.8	.23	4.8	.18	3.9	.15	6.2	.24	5.3	.21	21.8	.86
				124849	UM5V-212	3	.12	4.3	.16	4.9	.19	4.3	.17	5.3	.21	16.2	.64
2.15	2.115 2.175			124421	UM5-215	7	.28	-	-	-	-	-	-	-	-	-	
				124636	UM5W-215	3	.12	5.2	.20	3.9	.15	3.9	.15	5.3	.21	16.2	.64
				124759	UM5T-215	5.8	.23	4.8	.18	3.9	.15	6.2	.24	5.3	.21	21.8	.86
				124850	UM5V-215	3	.12	4.3	.16	4.9	.19	4.3	.17	5.3	.21	16.2	.64
2.175	2.14 2.20			124422	UM5-217	7	.28	-	-	-	-	-	-	-	-	-	
				124637	UM5W-217	3	.12	5.2	.20	3.9	.15	3.9	.15	5.3	.21	16.2	.64
				124760	UM5T-217	5.8	.23	4.8	.18	3.9	.15	6.2	.24	5.3	.21	21.8	.86
				124851	UM5V-217	3	.12	4.3	.17	4.9	.19	4.3	.17	5.3	.21	16.2	.64
2.2	2.165 2.225			124423	UM5-220	7	.28	-	-	-	-	-	-	-	-	-	
				124638	UM5W-220	3	.12	5.2	.20	3.9	.15	3.9	.15	5.3	.21	16.2	.64
				124761	UM5T-220	5.8	.23	4.8	.18	3.9	.15	6.2	.24	5.3	.21	21.8	.86
				124852	UM5V-220	3	.12	4.3	.17	4.9	.19	4.3	.17	5.3	.21	16.2	.64
2.225	2.19 2.25			124424	UM5-222	7.5	.30	-	-	-	-	-	-	-	-	-	
				124639	UM5W-222	3	.12	5.3	.20	3.9	.15	3.9	.15	5.3	.21	16.2	.64
				124762	UM5T-222	6.1	.24	4.8	.18	3.9	.15	6.4	.25	5.3	.21	21.8	.86
				124853	UM5V-222	3	.12	4.4	.17	4.9	.19	4.3	.17	5.3	.21	16.2	.64
2.25	2.215 2.275			124425	UM5-225	7.5	.30	-	-	-	-	-	-	-	-	-	
				124640	UM5W-225	3	.12	5.3	.20	3.9	.15	3.9	.15	5.3	.21	16.2	.64
				124763	UM5T-225	6.1	.24	4.8	.19	3.9	.15	6.4	.25	5.3	.21	21.8	.86
				124854	UM5V-225	3	.12	4.4	.17	4.9	.19	4.3	.17	5.3	.21	16.2	.64
2.275	2.24 2.30			124426	UM5-227	7.5	.30	-	-	-	-	-	-	-	-	-	
				124641	UM5W-227	3.1	.13	5.3	.20	3.9	.15	3.9	.15	5.3	.21	16.2	.64
				124764	UM5T-227	6.1	.24	4.9	.19	3.9	.15	6.4	.25	5.3	.21	21.8	.86
				124855	UM5V-227	3.1	.13	4.4	.17	4.9	.19	4.3	.17	5.3	.21	16.2	.64
2.3	2.265 2.325			124427	UM5-230	7.5	.30	-	-	-	-	-	-	-	-	-	
				124642	UM5W-230	3.1	.13	5.3	.20	3.9	.15	3.9	.15	5.3	.21	16.2	.64
				124765	UM5T-230	6.1	.24	4.9	.19	3.9	.15	6.4	.25	5.3	.21	21.8	.86
				124856	UM5V-230	3.1	.13	4.4	.17	4.9	.19	4.3	.17	5.3	.21	16.2	.64
2.325	2.29 2.35			124428	UM5-232	7.5	.30	-	-	-	-	-	-	-	-	-	
				124643	UM5W-232	3.1	.13	5.3	.21	3.9	.15	3.9	.15	5.3	.21	16.2	.64
				124766	UM5T-232	6.1	.24	4.9	.19	3.9	.15	6.4	.25	5.3	.21	21.8	.86
				124857	UM5V-232	3.1	.13	4.5	.17	4.9	.19	4.3	.17	5.3	.21	16.2	.64

## UM5 MICROCONIC COLLETS

Part Size Range ØA			SKU	Item Number	B		ØG		ØC1		D1		ØC2		D2		
mm	inch				mm	inch	mm	inch	mm	inch	mm	inch	mm	inch	mm	inch	
2.35	2.315	.0925	.0911	124429	UM5-235	7.5	.30	-	-	-	-	-	-	-	-	-	
	2.375			124644	UM5W-235	3.1	.13	5.4	.21	3.9	.15	3.9	.15	5.3	.21	16.2	.64
				124767	UM5T-235	6.1	.25	4.9	.19	3.9	.15	6.4	.25	5.3	.21	21.8	.86
				124858	UM5V-235	3.1	.13	4.5	.17	4.9	.19	4.3	.17	5.3	.21	16.2	.64
2.375	2.34	.0935	.0921	124430	UM5-237	7.8	.31	-	-	-	-	-	-	-	-	-	
	2.40			124645	UM5W-237	3.1	.13	5.4	.21	3.8	.15	3.9	.15	5.3	.21	16.2	.64
				124768	UM5T-237	6.5	.26	4.9	.19	3.9	.15	6.8	.27	5.3	.21	21.8	.86
				124859	UM5V-237	3.1	.13	4.6	.17	4.8	.18	4.3	.17	5.3	.21	16.2	.64
2.4	2.365	.0945	.0931	124431	UM5-240	7.8	.31	-	-	-	-	-	-	-	-	-	
	2.425			124646	UM5W-240	3.2	.13	5.5	.21	3.8	.15	3.9	.15	5.3	.21	16.2	.64
				124769	UM5T-240	6.5	.26	4.9	.19	3.9	.15	6.8	.27	5.3	.21	21.8	.86
				124860	UM5V-240	3.2	.13	4.6	.18	4.8	.18	4.3	.17	5.3	.21	16.2	.64
2.425	2.39	.0955	.0941	124432	UM5-242	7.8	.31	-	-	-	-	-	-	-	-	-	
	2.45			124647	UM5W-242	3.2	.13	5.5	.21	3.8	.15	3.9	.15	5.3	.21	16.2	.64
				124770	UM5T-242	6.5	.26	5	.19	3.9	.15	6.8	.27	5.3	.21	21.8	.86
				124861	UM5V-242	3.2	.13	4.6	.18	4.8	.18	4.3	.17	5.3	.21	16.2	.64
2.45	2.415	.0965	.0951	124433	UM5-245	7.8	.31	-	-	-	-	-	-	-	-	-	
	2.475			124648	UM5W-245	3.2	.13	5.5	.21	3.8	.15	3.9	.15	5.3	.21	16.2	.64
				124771	UM5T-245	6.5	.26	5	.19	3.9	.15	6.8	.27	5.3	.21	21.8	.86
				124862	UM5V-245	3.2	.13	4.6	.18	4.8	.18	4.3	.17	5.3	.21	16.2	.64
2.475	2.44	.0974	.0961	124434	UM5-247	7.8	.31	-	-	-	-	-	-	-	-	-	
	2.50			124649	UM5W-247	3.2	.13	5.5	.21	3.8	.15	3.9	.15	5.3	.21	16.2	.64
				124772	UM5T-247	6.6	.26	5	.19	3.9	.15	6.8	.27	5.3	.21	21.8	.86
				124863	UM5V-247	3.2	.13	4.6	.18	4.8	.18	4.3	.17	5.3	.21	16.2	.64
2.5	2.465	.0984	.0970	124435	UM5-250	8.3	.33	-	-	-	-	-	-	-	-	-	
	2.525			124650	UM5W-250	3.2	.13	5.5	.21	3.9	.15	3.9	.15	5.3	.21	16.2	.64
				124773	UM5T-250	6.8	.27	5	.19	3.9	.15	7	.28	5.3	.21	21.8	.86
				124864	UM5V-250	3.2	.13	4.6	.18	4.8	.19	4.3	.17	5.3	.21	16.2	.64
2.525	2.49	.0994	.0980	124436	UM5-252	8.3	.33	-	-	-	-	-	-	-	-	-	
	2.55			124651	UM5W-252	3.2	.13	5.5	.21	3.9	.15	3.9	.15	5.3	.21	16.2	.64
				124774	UM5T-252	6.8	.27	5	.19	3.9	.15	7	.28	5.3	.21	21.8	.86
				124865	UM5V-252	3.2	.13	4.7	.18	4.8	.19	4.3	.17	5.3	.21	16.2	.64
2.55	2.515	.1004	.0990	124437	UM5-255	8.3	.33	-	-	-	-	-	-	-	-	-	
	2.575			124652	UM5W-255	3.2	.13	5.5	.21	3.9	.15	3.9	.15	5.3	.21	16.2	.64
				124775	UM5T-255	6.8	.27	5	.19	3.9	.15	7	.28	5.3	.21	21.8	.86
				124866	UM5V-255	3.2	.13	4.7	.18	4.8	.19	4.3	.17	5.3	.21	16.2	.64
2.575	2.54	.1014	.1000	124438	UM5-257	8.3	.33	-	-	-	-	-	-	-	-	-	
	2.60			124653	UM5W-257	3.2	.13	5.6	.21	3.9	.15	3.9	.15	5.3	.21	16.2	.64
				124776	UM5T-257	6.8	.27	5	.19	3.9	.15	7	.28	5.3	.21	21.8	.86
				124867	UM5V-257	3.2	.13	4.7	.18	4.8	.19	4.3	.17	5.3	.21	16.2	.64
2.6	2.565	.1024	.1010	124439	UM5-260	8.4	.33	-	-	-	-	-	-	-	-	-	
	2.625			124654	UM5W-260	3.2	.13	5.6	.21	3.9	.15	3.9	.15	5.3	.21	16.2	.64
				124777	UM5T-260	6.8	.27	5.1	.19	3.9	.15	7	.28	5.3	.21	21.8	.86
				124868	UM5V-260	3.2	.13	4.7	.18	4.8	.19	4.3	.17	5.3	.21	16.2	.64



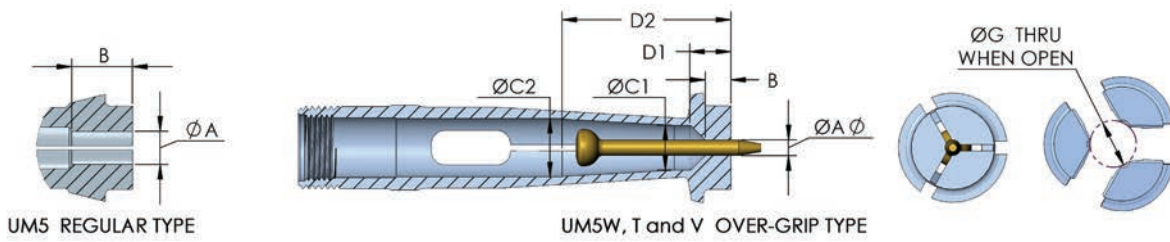

**UM5** - Regular Type   **UM5W** - Short Land Over-grip   **UM5T** - Long Land Over-grip   **UM5V** - Larger Capacity Over-grip

Part Size Range ØA		SKU	Item Number	B		ØG		ØC1		D1		ØC2		D2			
mm	inch			mm	inch	mm	inch	mm	inch	mm	inch	mm	inch	mm	inch		
2.625	2.59 2.65	.1033 .1043	.1020 .1043	124440	UM5-262	8.4	.33	-	-	-	-	-	-	-	-		
				124655	UM5W-262	3.2	.13	5.6	.22	3.9	.15	3.9	.15	5.3	.21	16.2	.64
				124778	UM5T-262	6.8	.27	5.1	.20	3.9	.15	7	.28	5.3	.21	21.8	.86
				124869	UM5V-262	3.2	.13	4.7	.18	4.8	.19	4.3	.17	5.3	.21	16.2	.64
2.65	2.615 2.675	.1043 .1053	.1030 .1053	124441	UM5-265	8.4	.33	-	-	-	-	-	-	-	-		
				124656	UM5W-265	3.3	.13	5.6	.22	3.9	.15	3.9	.15	5.3	.21	16.2	.64
				124779	UM5T-265	6.8	.27	5.1	.20	3.9	.15	7	.28	5.3	.21	21.8	.86
				124870	UM5V-265	3.3	.13	4.8	.18	4.8	.19	4.3	.17	5.3	.21	16.2	.64
2.675	2.64 2.70	.1053 .1063	.1039 .1063	124442	UM5-267	8.9	.35	-	-	-	-	-	-	-	-		
				124657	UM5W-267	3.3	.13	5.7	.22	3.9	.15	3.9	.15	5.3	.21	16.2	.64
				124780	UM5T-267	7.1	.29	5.1	.20	3.9	.15	7.4	.29	5.3	.21	21.8	.86
				124871	UM5V-267	3.3	.13	4.8	.18	4.8	.19	4.3	.17	5.3	.21	16.2	.64
2.7	2.665 2.725	.1063 .1073	.1049 .1073	124443	UM5-270	8.9	.35	-	-	-	-	-	-	-	-		
				124658	UM5W-270	3.3	.13	5.7	.22	3.9	.15	3.9	.15	5.3	.21	16.2	.64
				124781	UM5T-270	7.2	.29	5.1	.20	3.9	.15	7.4	.29	5.3	.21	21.8	.86
				124872	UM5V-270	3.3	.13	4.8	.18	4.8	.19	4.3	.17	5.3	.21	16.2	.64
2.725	2.69 2.75	.1073 .1083	.1059 .1083	124444	UM5-272	8.9	.36	-	-	-	-	-	-	-	-		
				124659	UM5W-272	3.3	.13	5.7	.22	3.9	.15	3.9	.15	5.3	.21	16.2	.64
				124782	UM5T-272	7.2	.29	5.1	.20	3.9	.15	7.4	.29	5.3	.21	21.8	.86
				124873	UM5V-272	3.3	.13	4.8	.19	4.8	.19	4.3	.17	5.3	.21	16.2	.64
2.75	2.715 2.775	.1083 .1093	.1069 .1093	124445	UM5-275	8.9	.36	-	-	-	-	-	-	-	-		
				124660	UM5W-275	3.3	.14	5.7	.22	3.9	.15	3.9	.15	5.3	.21	16.2	.64
				124783	UM5T-275	7.2	.29	5.1	.20	3.9	.15	7.4	.29	5.3	.21	21.8	.86
				124874	UM5V-275	3.3	.14	4.9	.19	4.8	.19	4.3	.17	5.3	.21	16.2	.64
2.775	2.74 2.80	.1093 .1102	.1079 .1102	124446	UM5-277	9.2	.37	-	-	-	-	-	-	-	-		
				124661	UM5W-277	3.3	.14	5.7	.22	3.9	.15	3.9	.15	5.3	.21	16.2	.64
				124784	UM5T-277	7.3	.29	5.1	.20	3.9	.15	7.5	.30	5.3	.21	21.8	.86
				124875	UM5V-277	3.3	.14	4.9	.19	4.8	.19	4.3	.17	5.3	.21	16.2	.64
2.8	2.765 2.825	.1102 .1112	.1089 .1112	124447	UM5-280	9.2	.37	-	-	-	-	-	-	-	-		
				124662	UM5W-280	3.3	.14	5.8	.22	3.9	.15	3.9	.15	5.3	.21	16.2	.64
				124785	UM5T-280	7.3	.29	5.2	.20	3.9	.15	7.5	.30	5.3	.21	21.8	.86
				124876	UM5V-280	3.3	.14	4.9	.19	4.8	.19	4.3	.17	5.3	.21	16.2	.64
2.825	2.79 2.85	.1112 .1122	.1098 .1122	124448	UM5-282	9.2	.37	-	-	-	-	-	-	-	-		
				124663	UM5W-282	3.4	.14	5.8	.22	3.9	.15	3.9	.15	5.3	.21	16.2	.64
				124786	UM5T-282	7.3	.29	5.2	.20	3.9	.15	7.5	.30	5.3	.21	21.8	.86
				124877	UM5V-282	3.4	.14	4.9	.19	4.8	.19	4.3	.17	5.3	.21	16.2	.64
2.85	2.815 2.875	.1122 .1132	.1108 .1132	124449	UM5-285	9.2	.37	-	-	-	-	-	-	-	-		
				124664	UM5W-285	3.4	.14	5.8	.22	3.9	.15	3.9	.15	5.3	.21	16.2	.64
				124787	UM5T-285	7.3	.29	5.2	.20	3.9	.15	7.5	.30	5.3	.21	21.8	.86
				124878	UM5V-285	3.4	.14	4.9	.19	4.8	.19	4.3	.17	5.3	.21	16.2	.64

# UM5 MICROCONIC COLLETS

Part Size Range $\phi A$			SKU	Item Number	B		$\phi G$		$\phi C1$		D1		$\phi C2$		D2		
mm	inch				mm	inch	mm	inch	mm	inch	mm	inch	mm	inch	mm	inch	
2.875	2.84	.1132	.1118	124450	UM5-287	9.2	.37	-	-	-	-	-	-	-	-		
	2.90			124665	UM5W-287	3.4	.14	5.8	.22	3.9	.15	3.9	.15	5.3	.21	16.2	.64
				124788	UM5T-287	7.3	.29	5.2	.20	3.9	.15	7.5	.30	5.3	.21	21.8	.86
				124879	UM5V-287	3.4	.14	5	.19	4.8	.19	4.3	.17	5.3	.21	16.2	.64
2.9	2.865	.1142	.1128	124451	UM5-290	9.2	.37	-	-	-	-	-	-	-	-		
	2.925			124666	UM5W-290	3.4	.14	5.8	.22	3.9	.15	3.9	.15	5.3	.21	16.2	.64
				124789	UM5T-290	7.3	.29	5.2	.20	3.9	.15	7.5	.30	5.3	.21	21.8	.86
				124880	UM5V-290	3.4	.14	5	.19	4.8	.19	4.3	.17	5.3	.21	16.2	.64
2.925	2.89	.1152	.1138	124452	UM5-292	9.5	.38	-	-	-	-	-	-	-	-		
	2.95			124667	UM5W-292	3.4	.14	5.9	.23	3.8	.15	3.9	.15	5.3	.21	16.2	.64
				124790	UM5T-292	7.8	.31	5.2	.20	3.9	.15	8	.32	5.3	.21	21.8	.86
				124881	UM5V-292	3.4	.14	5	.19	4.8	.18	4.3	.17	5.3	.21	16.2	.64
2.95	2.915	.1161	.1148	124453	UM5-295	9.5	.38	-	-	-	-	-	-	-	-		
	2.975			124668	UM5W-295	3.4	.14	5.9	.23	3.8	.15	3.9	.15	5.3	.21	16.2	.64
				124791	UM5T-295	7.8	.31	5.2	.20	3.9	.15	8	.32	5.3	.21	21.8	.86
				124882	UM5V-295	3.4	.14	5	.19	4.8	.18	4.3	.17	5.3	.21	16.2	.64
2.975	2.94	.1171	.1157	124454	UM5-297	9.5	.38	-	-	-	-	-	-	-	-		
	3.00			124669	UM5W-297	3.4	.14	5.9	.23	3.8	.15	3.9	.15	5.3	.21	16.2	.64
				124792	UM5T-297	7.8	.31	5.3	.20	3.9	.15	8	.32	5.3	.21	21.8	.86
				124883	UM5V-297	3.4	.14	5.1	.19	4.8	.18	4.3	.17	5.3	.21	16.2	.64
3	2.965	.1181	.1167	124455	UM5-300	9.5	.38	-	-	-	-	-	-	-	-		
	3.025			124670	UM5W-300	3.5	.14	5.9	.23	3.8	.15	3.9	.15	5.3	.21	16.2	.64
				124793	UM5T-300	7.8	.31	5.3	.20	3.9	.15	8	.32	5.3	.21	21.8	.86
				124884	UM5V-300	3.5	.14	5.1	.20	4.8	.18	4.3	.17	5.3	.21	16.2	.64
3.025	2.99	.1191	.1177	124456	UM5-302	9.5	.38	-	-	-	-	-	-	-	-		
	3.05			124671	UM5W-302	3.5	.14	5.9	.23	3.8	.15	3.9	.15	5.3	.21	16.2	.64
				124794	UM5T-302	7.8	.31	5.3	.20	3.9	.15	8	.32	5.3	.21	21.8	.86
				124885	UM5V-302	3.5	.14	5.1	.20	4.8	.18	4.3	.17	5.3	.21	16.2	.64
3.05	3.015	.1201	.1187	124457	UM5-305	9.5	.38	-	-	-	-	-	-	-	-		
	3.075			124672	UM5W-305	3.5	.14	6	.23	3.8	.15	3.9	.15	5.3	.21	16.2	.64
				124795	UM5T-305	7.8	.31	5.3	.20	3.9	.15	8	.32	5.3	.21	21.8	.86
				124886	UM5V-305	3.5	.14	5.1	.20	4.8	.18	4.3	.17	5.3	.21	16.2	.64
3.075	3.04	.1211	.1197	124458	UM5-307	9.5	.38	-	-	-	-	-	-	-	-		
	3.10			124673	UM5W-307	3.5	.14	6	.23	3.8	.15	3.9	.15	5.3	.21	16.2	.64
				124796	UM5T-307	7.8	.31	5.3	.21	3.9	.15	8	.32	5.3	.21	21.8	.86
				124887	UM5V-307	3.5	.14	5.2	.20	4.8	.18	4.3	.17	5.3	.21	16.2	.64
3.1	3.065	.1220	.1207	124459	UM5-310	9.5	.38	-	-	-	-	-	-	-	-		
	3.125			124674	UM5W-310	3.5	.14	6	.23	3.8	.15	3.9	.15	5.3	.21	16.2	.64
				124797	UM5T-310	7.8	.31	5.4	.21	3.9	.15	8	.32	5.3	.21	21.8	.86
				124888	UM5V-310	3.5	.14	5.2	.20	4.8	.18	4.3	.17	5.3	.21	16.2	.64
3.125	3.09	.1230	.1217	124460	UM5-312	10	.40	-	-	-	-	-	-	-	-		
	3.15			124675	UM5W-312	3.5	.14	6	.23	3.9	.15	3.9	.15	5.3	.21	16.2	.64
				124798	UM5T-312	8.1	.33	5.3	.20	3.9	.15	8.3	.33	5.3	.21	21.8	.86
				124889	UM5V-312	3.5	.14	5.1	.20	4.9	.19	4.3	.17	5.3	.21	16.2	.64

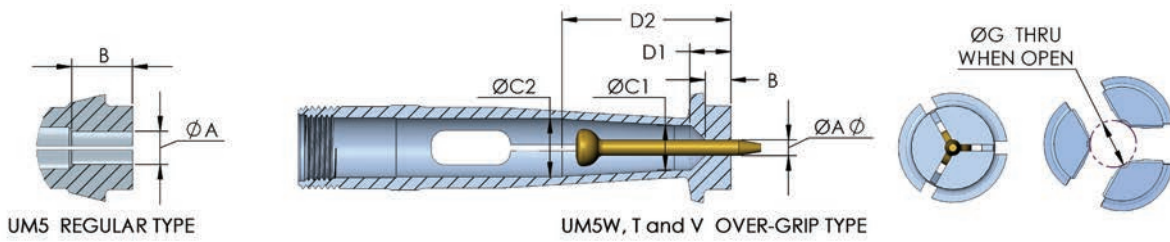

UM5 - Regular Type UM5W - Short Land Over-grip UM5T - Long Land Over-grip UM5V - Larger Capacity Over-grip

Part Size Range	ØA	SKU	Item Number	B		ØG		ØC1		D1		ØC2		D2		
				mm	inch	mm	inch	mm	inch	mm	inch	mm	inch	mm	inch	
3.15	3.115 3.175	.1240 .1250	124461	UM5-315	10	.40	-	-	-	-	-	-	-	-	-	
			124676	UM5W-315	3.5	.14	6	.23	3.9	.15	3.9	.15	5.3	.21	16.2	.64
			124799	UM5T-315	8.1	.33	5.3	.20	3.9	.15	8.3	.33	5.3	.21	21.8	.86
			124890	UM5V-315	3.5	.14	5.2	.20	4.9	.19	4.3	.17	5.3	.21	16.2	.64
3.175	3.14 3.20	.1250 .1260	124462	UM5-317	10	.40	-	-	-	-	-	-	-	-	-	
			124677	UM5W-317	3.5	.14	6	.23	3.9	.15	3.9	.15	5.3	.21	16.2	.64
			124800	UM5T-317	8.2	.33	5.3	.21	3.9	.15	8.3	.33	5.3	.21	21.8	.86
			124891	UM5V-317	3.5	.14	5.2	.20	4.9	.19	4.3	.17	5.3	.21	16.2	.64
3.2	3.165 3.225	.1260 .1270	124463	UM5-320	10.1	.40	-	-	-	-	-	-	-	-	-	
			124678	UM5W-320	3.5	.14	6	.23	3.9	.15	3.9	.15	5.3	.21	16.2	.64
			124801	UM5T-320	8.2	.33	5.4	.21	3.9	.15	8.3	.33	5.3	.21	21.8	.86
			124892	UM5V-320	3.5	.14	5.2	.20	4.9	.19	4.3	.17	5.3	.21	16.2	.64
3.225	3.19 3.25	.1270 .1280	124464	UM5-322	10.1	.40	-	-	-	-	-	-	-	-	-	
			124679	UM5W-322	3.5	.14	6.1	.23	3.9	.15	3.9	.15	5.3	.21	16.2	.64
			124802	UM5T-322	8.2	.33	5.4	.21	3.9	.15	8.3	.33	5.3	.21	21.8	.86
			124893	UM5V-322	3.5	.14	5.2	.20	4.9	.19	4.3	.17	5.3	.21	16.2	.64
3.25	3.215 3.275	.1280 .1289	124465	UM5-325	10.6	.42	-	-	-	-	-	-	-	-	-	
			124680	UM5W-325	3.5	.14	6.1	.23	3.9	.15	3.9	.15	5.3	.21	16.2	.64
			124803	UM5T-325	8.4	.34	5.4	.21	3.9	.15	8.6	.34	5.3	.21	21.8	.86
			124894	UM5V-325	3.5	.14	5.2	.20	4.9	.19	4.3	.17	5.3	.21	16.2	.64
3.275	3.24 3.30	.1289 .1299	124466	UM5-327	10.6	.42	-	-	-	-	-	-	-	-	-	
			124681	UM5W-327	3.5	.14	6.1	.23	3.9	.15	3.9	.15	5.3	.21	16.2	.64
			124804	UM5T-327	8.4	.34	5.4	.21	3.9	.15	8.6	.34	5.3	.21	21.8	.86
			124895	UM5V-327	3.5	.14	5.3	.20	4.9	.19	4.3	.17	5.3	.21	16.2	.64
3.3	3.265 3.325	.1299 .1309	124467	UM5-330	10.6	.42	-	-	-	-	-	-	-	-	-	
			124682	UM5W-330	3.6	.14	6.1	.24	3.9	.15	3.9	.15	5.3	.21	16.2	.64
			124805	UM5T-330	8.4	.34	5.4	.21	3.9	.15	8.6	.34	5.3	.21	21.8	.86
			124896	UM5V-330	3.6	.14	5.3	.20	4.9	.19	4.3	.17	5.3	.21	16.2	.64
3.325	3.29 3.35	.1309 .1319	124468	UM5-332	10.6	.42	-	-	-	-	-	-	-	-	-	
			124683	UM5W-332	3.6	.15	6.1	.24	3.9	.15	3.9	.15	5.3	.21	16.2	.64
			124806	UM5T-332	8.4	.34	5.4	.21	3.9	.15	8.6	.34	5.3	.21	21.8	.86
			124897	UM5V-332	3.6	.15	5.3	.20	4.9	.19	4.3	.17	5.3	.21	16.2	.64
3.35	3.315 3.375	.1319 .1329	124469	UM5-335	10.6	.42	-	-	-	-	-	-	-	-	-	
			124684	UM5W-335	3.6	.15	6.1	.24	3.9	.15	3.9	.15	5.3	.21	16.2	.64
			124807	UM5T-335	8.4	.34	5.5	.21	3.9	.15	8.6	.34	5.3	.21	21.8	.86
			124898	UM5V-335	3.6	.15	5.3	.20	4.9	.19	4.3	.17	5.3	.21	16.2	.64
3.375	3.34 3.40	.1329 .1339	124470	UM5-337	10.6	.42	-	-	-	-	-	-	-	-	-	
			124685	UM5W-337	3.6	.15	6.2	.24	3.9	.15	3.9	.15	5.3	.21	16.2	.64
			124808	UM5T-337	8.4	.34	5.5	.21	3.9	.15	8.6	.34	5.3	.21	21.8	.86
			124899	UM5V-337	3.6	.15	5.3	.21	4.9	.19	4.3	.17	5.3	.21	16.2	.64

# UM5 MICROCONIC COLLETS

Part Size Range ØA			SKU	Item Number	B		ØG		ØC1		D1		ØC2		D2	
mm	inch	mm			inch	mm	inch	mm	inch	mm	inch	mm	inch	mm	inch	mm
3.4	3.365 3.425	.1339 .1325 .1348	124471	UM5-340	10.6	.42	-	-	-	-	-	-	-	-	-	-
			124686	UM5W-340	3.6	.15	6.2	.24	3.9	.15	3.9	.15	5.3	.21	16.2	.64
			124809	UM5T-340	8.5	.34	5.5	.21	3.9	.15	8.6	.34	5.3	.21	21.8	.86
			124900	UM5V-340	3.6	.15	5.4	.21	4.9	.19	4.3	.17	5.3	.21	16.2	.64
3.425	3.39 3.45	.1348 .1335 .1358	124472	UM5-342	10.9	.43	-	-	-	-	-	-	-	-	-	-
			124687	UM5W-342	3.6	.15	6.2	.24	3.9	.15	3.9	.15	5.3	.21	16.2	.64
			124810	UM5T-342	8.7	.35	5.5	.21	3.9	.15	8.8	.35	5.3	.21	21.8	.86
			124901	UM5V-342	3.6	.15	5.4	.21	4.9	.19	4.3	.17	5.3	.21	16.2	.64
3.45	3.415 3.475	.1358 .1344 .1368	124473	UM5-345	10.9	.43	-	-	-	-	-	-	-	-	-	-
			124688	UM5W-345	3.6	.15	6.2	.24	3.9	.15	3.9	.15	5.3	.21	16.2	.64
			124811	UM5T-345	8.7	.35	5.5	.21	3.9	.15	8.8	.35	5.3	.21	21.8	.86
			124902	UM5V-345	3.6	.15	5.4	.21	4.9	.19	4.3	.17	5.3	.21	16.2	.64
3.475	3.44 3.50	.1368 .1354 .1378	124474	UM5-347	10.9	.43	-	-	-	-	-	-	-	-	-	-
			124689	UM5W-347	3.7	.15	6.3	.24	3.9	.15	3.9	.15	5.3	.21	16.2	.64
			124812	UM5T-347	8.7	.35	5.5	.21	3.9	.15	8.8	.35	5.3	.21	21.8	.86
			124903	UM5V-347	3.7	.15	5.4	.21	4.9	.19	4.3	.17	5.3	.21	16.2	.64
3.5	3.465 3.525	.1378 .1364 .1388	124475	UM5-350	10.9	.43	-	-	-	-	-	-	-	-	-	-
			124690	UM5W-350	3.7	.15	6.3	.24	3.9	.15	3.9	.15	5.3	.21	16.2	.64
			124813	UM5T-350	8.7	.35	5.6	.21	3.9	.15	8.8	.35	5.3	.21	21.8	.86
			124904	UM5V-350	3.7	.15	5.5	.21	4.9	.19	4.3	.17	5.3	.21	16.2	.64
3.525	3.49 3.55	.1388 .1374 .1398	124476	UM5-352	10.9	.43	-	-	-	-	-	-	-	-	-	-
			124691	UM5W-352	3.7	.15	6.3	.24	3.9	.15	3.9	.15	5.3	.21	16.2	.64
			124814	UM5T-352	8.7	.35	5.6	.21	3.9	.15	8.8	.35	5.3	.21	21.8	.86
			124905	UM5V-352	3.7	.15	5.5	.21	4.9	.19	4.3	.17	5.3	.21	16.2	.64
3.55	3.515 3.575	.1398 .1384 .1407	124477	UM5-355	10.9	.43	-	-	-	-	-	-	-	-	-	-
			124692	UM5W-355	3.7	.15	6.3	.24	3.9	.15	3.9	.15	5.3	.21	16.2	.64
			124815	UM5T-355	8.7	.35	5.6	.22	3.9	.15	8.8	.35	5.3	.21	21.8	.86
			124906	UM5V-355	3.7	.15	5.5	.21	4.9	.19	4.3	.17	5.3	.21	16.2	.64
3.575	3.54 3.60	.1407 .1394 .1417	124478	UM5-357	10.9	.44	-	-	-	-	-	-	-	-	-	-
			124693	UM5W-357	3.7	.15	6.3	.24	3.9	.15	3.9	.15	5.3	.21	16.2	.64
			124816	UM5T-357	8.7	.35	5.6	.22	3.9	.15	8.8	.35	5.3	.21	21.8	.86
			124907	UM5V-357	3.7	.15	5.5	.21	4.9	.19	4.3	.17	5.3	.21	16.2	.64
3.6	3.565 3.625	.1417 .1404 .1427	124479	UM5-360	11.5	.46	-	-	-	-	-	-	-	-	-	-
			124694	UM5W-360	3.7	.15	6.4	.25	3.9	.15	3.9	.15	5.3	.21	16.2	.64
			124817	UM5T-360	9.2	.37	5.6	.22	3.9	.15	9.2	.36	5.3	.21	21.8	.86
			124908	UM5V-360	3.7	.15	5.6	.21	4.8	.19	4.3	.17	5.3	.21	16.2	.64
3.625	3.59 3.65	.1427 .1413 .1437	124480	UM5-362	11.5	.46	-	-	-	-	-	-	-	-	-	-
			124695	UM5W-362	3.7	.15	6.4	.25	3.9	.15	3.9	.15	5.3	.21	16.2	.64
			124818	UM5T-362	9.2	.37	5.6	.22	3.9	.15	9.2	.36	5.3	.21	21.8	.86
			124909	UM5V-362	3.7	.15	5.6	.22	4.8	.19	4.3	.17	5.3	.21	16.2	.64
3.65	3.615 3.675	.1437 .1423 .1447	124481	UM5-365	11.5	.46	-	-	-	-	-	-	-	-	-	-
			124696	UM5W-365	3.8	.15	6.4	.25	3.9	.15	3.9	.15	5.3	.21	16.2	.64
			124819	UM5T-365	9.2	.37	5.7	.22	3.9	.15	9.2	.36	5.3	.21	21.8	.86
			124910	UM5V-365	3.8	.15	5.6	.22	4.8	.19	4.3	.17	5.3	.21	16.2	.64

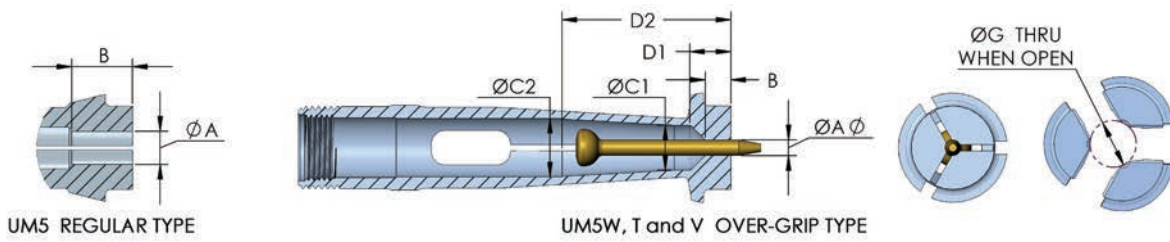

**UM5** - Regular Type   **UM5W** - Short Land Over-grip   **UM5T** - Long Land Over-grip   **UM5V** - Larger Capacity Over-grip

Part Size Range	ØA		SKU	Item Number	B		ØG		ØC1		D1		ØC2		D2	
	mm	inch			mm	inch	mm	inch	mm	inch	mm	inch	mm	inch	mm	inch
3.675	3.64 3.70	.1447 .1457	124482	UM5-367	11.5	.46	-	-	-	-	-	-	-	-	-	-
			124697	UM5W-367	3.8	.15	6.5	.25	3.9	.15	3.9	.15	5.3	.21	16.2	.64
			124820	UM5T-367	9.2	.37	5.7	.22	3.9	.15	9.2	.36	5.3	.21	21.8	.86
			124911	UM5V-367	3.8	.15	5.6	.22	4.8	.19	4.3	.17	5.3	.21	16.2	.64
3.7	3.665 3.725	.1457 .1467	124483	UM5-370	11.5	.46	-	-	-	-	-	-	-	-	-	-
			124698	UM5W-370	3.8	.15	6.5	.25	3.9	.15	3.9	.15	5.3	.21	16.2	.64
			124821	UM5T-370	9.2	.37	5.7	.22	3.9	.15	9.2	.36	5.3	.21	21.8	.86
			124912	UM5V-370	3.8	.15	5.7	.22	4.8	.19	4.3	.17	5.3	.21	16.2	.64
3.725	3.69 3.75	.1467 .1476	124484	UM5-372	12	.48	-	-	-	-	-	-	-	-	-	-
			124699	UM5W-372	3.8	.15	6.5	.25	3.9	.15	3.9	.15	5.3	.21	16.2	.64
			124822	UM5T-372	9.4	.38	5.7	.22	3.9	.15	9.5	.37	5.3	.21	21.8	.86
			124913	UM5V-372	3.8	.15	5.7	.22	4.9	.19	4.3	.17	5.3	.21	16.2	.64
3.75	3.715 3.775	.1476 .1486	124485	UM5-375	12.1	.48	-	-	-	-	-	-	-	-	-	-
			124700	UM5W-375	3.8	.15	6.5	.25	3.9	.15	3.9	.15	5.3	.21	16.2	.64
			124823	UM5T-375	9.4	.38	5.7	.22	3.9	.15	9.5	.37	5.3	.21	21.8	.86
			124914	UM5V-375	3.8	.15	5.7	.22	4.9	.19	4.3	.17	5.3	.21	16.2	.64
3.775	3.74 3.80	.1486 .1496	124486	UM5-377	12.1	.48	-	-	-	-	-	-	-	-	-	-
			124701	UM5W-377	3.8	.15	6.5	.25	3.9	.15	3.9	.15	5.3	.21	16.2	.64
			124824	UM5T-377	9.4	.38	5.7	.22	3.9	.15	9.5	.37	5.3	.21	21.8	.86
			124915	UM5V-377	3.8	.15	5.7	.22	4.9	.19	4.3	.17	5.3	.21	16.2	.64
3.8	3.765 3.825	.1496 .1506	124487	UM5-380	12.1	.48	-	-	-	-	-	-	-	-	-	-
			124702	UM5W-380	3.8	.16	6.6	.25	3.9	.15	3.9	.15	5.3	.21	16.2	.64
			124825	UM5T-380	9.5	.38	5.8	.22	3.9	.15	9.5	.37	5.3	.21	21.8	.86
			124916	UM5V-380	3.8	.16	5.8	.22	4.9	.19	4.3	.17	5.3	.21	16.2	.64
3.825	3.79 3.85	.1506 .1516	124488	UM5-382	12.1	.48	-	-	-	-	-	-	-	-	-	-
			124703	UM5W-382	3.8	.16	6.6	.25	3.9	.15	3.9	.15	5.3	.21	16.2	.64
			124826	UM5T-382	9.5	.38	5.8	.22	3.9	.15	9.5	.37	5.3	.21	21.8	.86
			124917	UM5V-382	3.8	.16	5.8	.22	4.9	.19	4.3	.17	5.3	.21	16.2	.64
3.85	3.815 3.875	.1516 .1526	124489	UM5-385	12.1	.48	-	-	-	-	-	-	-	-	-	-
			124704	UM5W-385	3.9	.16	6.6	.25	3.9	.15	3.9	.15	5.3	.21	16.2	.64
			124827	UM5T-385	9.5	.38	5.8	.22	3.9	.15	9.5	.37	5.3	.21	21.8	.86
			124918	UM5V-385	3.9	.16	5.8	.22	4.9	.19	4.3	.17	5.3	.21	16.2	.64
3.875	3.84 3.90	.1526 .1535	124490	UM5-387	12.1	.48	-	-	-	-	-	-	-	-	-	-
			124705	UM5W-387	3.9	.16	6.6	.26	3.9	.15	3.9	.15	5.3	.21	16.2	.64
			124828	UM5T-387	9.5	.38	5.8	.22	3.9	.15	9.5	.37	5.3	.21	21.8	.86
			124919	UM5V-387	3.9	.16	5.8	.22	4.9	.19	4.3	.17	5.3	.21	16.2	.64
3.9	3.865 3.925	.1535 .1545	124491	UM5-390	12.4	.49	-	-	-	-	-	-	-	-	-	-
			124706	UM5W-390	3.9	.16	6.6	.26	3.9	.15	3.9	.15	5.3	.21	16.2	.64
			124829	UM5T-390	9.8	.39	5.8	.22	3.9	.15	9.8	.39	5.3	.21	21.8	.86
			124920	UM5V-390	3.9	.16	5.9	.23	4.8	.19	4.3	.17	5.3	.21	16.2	.64

# UM5 MICROCONIC COLLETS

Part Size Range ØA			SKU	Item Number	B		ØG		ØC1		D1		ØC2		D2			
mm	inch				mm	inch	mm	inch	mm	inch	mm	inch	mm	inch	mm	inch		
3.925	3.89	.1545	.1531	124492	UM5-392	12.4	.49	-	-	-	-	-	-	-	-	-		
	3.95			.1555	124707	UM5W-392	3.9	.16	6.7	.26	3.9	.15	3.9	.15	5.3	.21	16.2	.64
					124830	UM5T-392	9.8	.39	5.8	.22	3.9	.15	9.8	.39	5.3	.21	21.8	.86
					124921	UM5V-392	3.9	.16	5.9	.23	4.8	.19	4.3	.17	5.3	.21	16.2	.64
3.95	3.915	.1555	.1541	124493	UM5-395	12.4	.49	-	-	-	-	-	-	-	-	-		
	3.975			.1565	124708	UM5W-395	3.9	.16	6.7	.26	3.9	.15	3.9	.15	5.3	.21	16.2	.64
					124831	UM5T-395	9.8	.39	5.9	.23	3.9	.15	9.8	.39	5.3	.21	21.8	.86
					124922	UM5V-395	3.9	.16	5.9	.23	4.8	.19	4.3	.17	5.3	.21	16.2	.64
3.975	3.94	.1565	.1551	124494	UM5-397	12.4	.49	-	-	-	-	-	-	-	-	-		
	4.00			.1575	124923	UM5V-397	3.9	.16	5.9	.23	4.8	.19	4.3	.17	5.3	.21	16.2	.64
4	3.965	.1575	.1561		124495	UM5-400	12.4	.49	-	-	-	-	-	-	-	-		
	4.025				.1585	124924	UM5V-400	3.9	.16	5.9	.23	4.8	.19	4.3	.17	5.3	.21	16.2
4.025	3.99	.1585	.1571	124496		UM5-402	12.4	.49	-	-	-	-	-	-	-	-		
	4.05			.1594		124925	UM5V-402	3.9	.16	6	.23	4.8	.19	4.3	.17	5.3	.21	16.2
4.05	4.015	.1594	.1581		124497	UM5-405	12.9	.51	-	-	-	-	-	-	-	-		
	4.075				.1604	124926	UM5V-405	3.9	.16	5.9	.23	4.9	.19	4.3	.17	5.3	.21	16.2
4.075	4.04	.1604	.1591	124498		UM5-407	12.9	.51	-	-	-	-	-	-	-	-		
	4.10			.1614		124927	UM5V-407	4	.16	6	.23	4.9	.19	4.3	.17	5.3	.21	16.2
4.1	4.065	.1614	.1600		124499	UM5-410	12.9	.51	-	-	-	-	-	-	-	-		
	4.125				.1624	124928	UM5V-410	4	.16	6	.23	4.9	.19	4.3	.17	5.3	.21	16.2
4.125	4.09	.1624	.1610	124500		UM5-412	12.9	.51	-	-	-	-	-	-	-	-		
	4.15			.1634		124929	UM5V-412	4	.16	6	.23	4.9	.19	4.3	.17	5.3	.21	16.2
4.15	4.115	.1634	.1620		124501	UM5-415	12.9	.51	-	-	-	-	-	-	-	-		
	4.175				.1644	124930	UM5V-415	4	.16	6	.23	4.9	.19	4.3	.17	5.3	.21	16.2
4.175	4.14	.1644	.1630	124502		UM5-417	13.2	.52	-	-	-	-	-	-	-	-		
	4.20			.1654		124931	UM5V-417	4	.16	6.1	.23	4.9	.19	4.3	.17	5.3	.21	16.2
4.2	4.165	.1654	.1640		124503	UM5-420	13.2	.52	-	-	-	-	-	-	-	-		
	4.225				.1663	124932	UM5V-420	4	.16	6.1	.23	4.9	.19	4.3	.17	5.3	.21	16.2
4.225	4.19	.1663	.1650	124504		UM5-422	13.2	.53	-	-	-	-	-	-	-	-		
	4.25			.1673		124933	UM5V-422	4	.16	6.1	.24	4.9	.19	4.3	.17	5.3	.21	16.2
4.25	4.215	.1673	.1659		124505	UM5-425	13.2	.53	-	-	-	-	-	-	-	-		
	4.275				.1683	124934	UM5V-425	4	.16	6.1	.24	4.9	.19	4.3	.17	5.3	.21	16.2
4.275	4.24	.1683	.1669	124506		UM5-427	13.2	.53	-	-	-	-	-	-	-	-		
	4.30			.1693		124935	UM5V-427	4.1	.16	6.1	.24	4.9	.19	4.3	.17	5.3	.21	16.2
4.3	4.265	.1693	.1679		124507	UM5-430	13.8	.55	-	-	-	-	-	-	-	-		
	4.325				.1703	124936	UM5V-430	4.1	.17	6.2	.24	4.8	.19	4.3	.17	5.3	.21	16.2
4.325	4.29	.1703	.1689	124508		UM5-432	13.8	.55	-	-	-	-	-	-	-	-		
	4.35			.1713		124937	UM5V-432	4.1	.17	6.2	.24	4.8	.19	4.3	.17	5.3	.21	16.2
4.35	4.315	.1713	.1699		124509	UM5-435	13.8	.55	-	-	-	-	-	-	-	-		
	4.375				.1722	124938	UM5V-435	4.1	.17	6.2	.24	4.8	.19	4.3	.17	5.3	.21	16.2
4.375	4.34	.1722	.1709	124510		UM5-437	13.8	.55	-	-	-	-	-	-	-	-		
	4.40			.1732		124939	UM5V-437	4.1	.17	6.3	.24	4.8	.19	4.3	.17	5.3	.21	16.2
4.4	4.365	.1732	.1719		124511	UM5-440	13.8	.55	-	-	-	-	-	-	-	-		
	4.425				.1742	124940	UM5V-440	4.1	.17	6.3	.24	4.8	.19	4.3	.17	5.3	.21	16.2
4.425	4.39	.1742	.1728	124512		UM5-442	13.8	.55	-	-	-	-	-	-	-	-		
	4.45			124941		UM5V-442	4.1	.17	6.3	.24	4.8	.19	4.3	.17	5.3	.21	16.2	.64

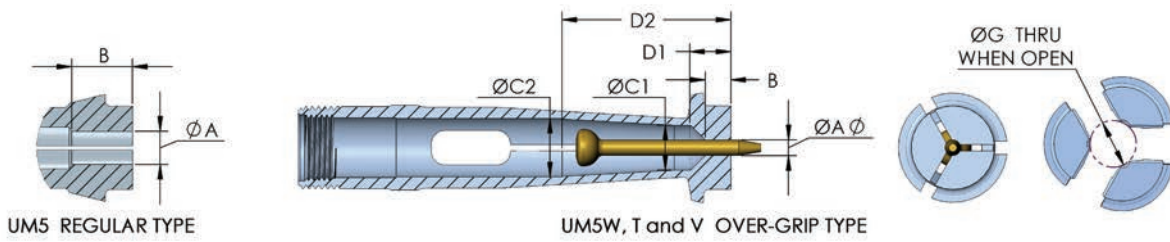

**UM5** - Regular Type **UM5W** - Short Land Over-grip **UM5T** - Long Land Over-grip **UM5V** - Larger Capacity Over-grip

Part Size Range ØA			SKU	Item Number	B		ØG		ØC1		D1		ØC2		D2	
mm	inch				mm	inch	mm	inch	mm	inch	mm	inch	mm	inch	mm	inch
4.45	4.415	.1752 <sup>1738</sup>		124513	UM5-445	13.8	.55	-	-	-	-	-	-	-	-	-
	4.475	.1762 <sup>1762</sup>		124942	UM5V-445	4.1	.17	6.3	.24	4.8	.19	4.3	.17	5.3	.21	16.2
4.475	4.44	.1762 <sup>1748</sup>		124514	UM5-447	14.3	.57	-	-	-	-	-	-	-	-	-
	4.50	.1772 <sup>1772</sup>		124943	UM5V-447	4.2	.17	6.4	.25	4.8	.19	4.3	.17	5.3	.21	16.2
4.5	4.465	.1772 <sup>1758</sup>		124515	UM5-450	14.3	.57	-	-	-	-	-	-	-	-	-
	4.525	.1781 <sup>1781</sup>		124944	UM5V-450	4.2	.17	6.4	.25	4.8	.19	4.3	.17	5.3	.21	16.2
4.525	4.49	.1781 <sup>1768</sup>		124516	UM5-452	14.3	.57	-	-	-	-	-	-	-	-	-
	4.55	.1791 <sup>1791</sup>		124945	UM5V-452	4.2	.17	6.4	.25	4.8	.19	4.3	.17	5.3	.21	16.2
4.55	4.515	.1791 <sup>1778</sup>		124517	UM5-455	14.3	.57	-	-	-	-	-	-	-	-	-
	4.575	.1801 <sup>1801</sup>		124946	UM5V-455	4.2	.17	6.4	.25	4.8	.19	4.3	.17	5.3	.21	16.2
4.575	4.54	.1801 <sup>1787</sup>		124518	UM5-457	14.3	.57	-	-	-	-	-	-	-	-	-
	4.60	.1811 <sup>1811</sup>		124947	UM5V-457	4.2	.17	6.5	.25	4.8	.19	4.3	.17	5.3	.21	16.2
4.6	4.565	.1811 <sup>1797</sup>		124519	UM5-460	14.3	.57	-	-	-	-	-	-	-	-	-
	4.625	.1821 <sup>1821</sup>		124948	UM5V-460	4.2	.17	6.5	.25	4.8	.19	4.3	.17	5.3	.21	16.2
4.625	4.59	.1821 <sup>1807</sup>		124520	UM5-462	14.4	.57	-	-	-	-	-	-	-	-	-
	4.65	.1831 <sup>1831</sup>		124949	UM5V-462	4.2	.17	6.5	.25	4.8	.19	4.3	.17	5.3	.21	16.2
4.65	4.615	.1831 <sup>1817</sup>		124521	UM5-465	14.9	.59	-	-	-	-	-	-	-	-	-
	4.675	.1841 <sup>1841</sup>		124950	UM5V-465	4.2	.17	6.5	.25	4.9	.19	4.3	.17	5.3	.21	16.2
4.675	4.64	.1841 <sup>1827</sup>		124522	UM5-467	14.9	.59	-	-	-	-	-	-	-	-	-
	4.70	.1850 <sup>1850</sup>		124951	UM5V-467	4.3	.17	6.5	.25	4.9	.19	4.3	.17	5.3	.21	16.2
4.7	4.665	.1850 <sup>1837</sup>		124523	UM5-470	14.9	.59	-	-	-	-	-	-	-	-	-
	4.725	.1860 <sup>1860</sup>		124952	UM5V-470	4.3	.17	6.5	.25	4.9	.19	4.3	.17	5.3	.21	16.2
4.725	4.69	.1860 <sup>1846</sup>		124524	UM5-472	14.9	.59	-	-	-	-	-	-	-	-	-
	4.75	.1870 <sup>1870</sup>		124953	UM5V-472	4.3	.17	6.6	.25	4.9	.19	4.3	.17	5.3	.21	16.2
4.75	4.715	.1870 <sup>1856</sup>		124525	UM5-475	14.9	.59	-	-	-	-	-	-	-	-	-
	4.775	.1880 <sup>1880</sup>		124954	UM5V-475	4.3	.17	6.6	.25	4.9	.19	4.3	.17	5.3	.21	16.2
4.775	4.74	.1880 <sup>1866</sup>		124526	UM5-477	14.9	.59	-	-	-	-	-	-	-	-	-
	4.80	.1890 <sup>1890</sup>		124955	UM5V-477	4.3	.17	6.6	.25	4.9	.19	4.3	.17	5.3	.21	16.2
4.8	4.765	.1890 <sup>1876</sup>		124527	UM5-480	14.9	.59	-	-	-	-	-	-	-	-	-
	4.825	.1900 <sup>1900</sup>		124956	UM5V-480	4.3	.17	6.6	.26	4.9	.19	4.3	.17	5.3	.21	16.2
4.825	4.79	.1900 <sup>1886</sup>		124528	UM5-482	14.9	.59	-	-	-	-	-	-	-	-	-
	4.85	.1909 <sup>1909</sup>		124957	UM5V-482	4.3	.17	6.6	.26	4.9	.19	4.3	.17	5.3	.21	16.2
4.85	4.815	.1909 <sup>1896</sup>		124529	UM5-485	14.9	.59	-	-	-	-	-	-	-	-	-
	4.875	.1919 <sup>1919</sup>		124958	UM5V-485	4.3	.18	6.7	.26	4.9	.19	4.3	.17	5.3	.21	16.2
4.875	4.84	.1919 <sup>1906</sup>		124530	UM5-487	14.9	.59	-	-	-	-	-	-	-	-	-
	4.90	.1929 <sup>1929</sup>		124959	UM5V-487	4.4	.18	6.7	.26	4.9	.19	4.3	.17	5.3	.21	16.2
4.9	4.865	.1929 <sup>1915</sup>		124531	UM5-490	15.5	.61	-	-	-	-	-	-	-	-	-
	4.925	.1939 <sup>1939</sup>		124960	UM5V-490	4.4	.18	6.7	.26	4.8	.19	4.3	.17	5.3	.21	16.2
4.925	4.89	.1939 <sup>1925</sup>		124532	UM5-492	15.5	.61	-	-	-	-	-	-	-	-	-
	4.95	.1949 <sup>1949</sup>		124961	UM5V-492	4.4	.18	6.8	.26	4.8	.19	4.3	.17	5.3	.21	16.2

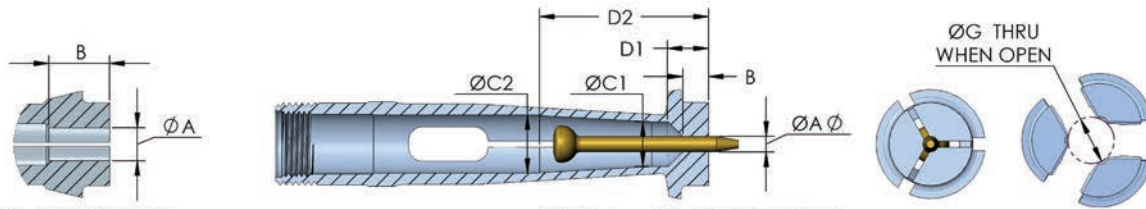

UM5 REGULAR TYPE

UM5W, T and V OVER-GRIP TYPE

**UM5** - Regular Type **UM5W** - Short Land Over-grip **UM5T** - Long Land Over-grip **UM5V** - Larger Capacity Over-grip

Part Size Range	ØA		SKU	Item Number	B		ØG		ØC1		D1		ØC2		D2	
	mm	inch			mm	inch	mm	inch	mm	inch	mm	inch	mm	inch	mm	inch
4.95	4.915	.1935	124533	UM5-495	15.5	.61	-	-	-	-	-	-	-	-	-	-
	4.975	.1959	124962	UM5V-495	4.4	.18	6.8	.26	4.8	.19	4.3	.17	5.3	.21	16.2	.64
4.975	4.94	.1945	124534	UM5-497	15.5	.61	-	-	-	-	-	-	-	-	-	-
	5.00	.1969														
5	4.965	.1955	124535	UM5-500	15.5	.61	-	-	-	-	-	-	-	-	-	-
	5.025	.1978														
5.025	4.99	.1965	124536	UM5-502	15.5	.61	-	-	-	-	-	-	-	-	-	-
	5.05	.1988														
5.05	5.015	.1974	124537	UM5-505	15.5	.61	-	-	-	-	-	-	-	-	-	-
	5.075	.1998														
5.075	5.04	.1984	124538	UM5-507	15.5	.62	-	-	-	-	-	-	-	-	-	-
	5.10	.2008														
5.1	5.065	.1994	124539	UM5-510	16	.64	-	-	-	-	-	-	-	-	-	-
	5.125	.2018														
5.125	5.09	.2004	124540	UM5-512	16	.64	-	-	-	-	-	-	-	-	-	-
	5.15	.2028														
5.15	5.115	.2014	124541	UM5-515	16	.64	-	-	-	-	-	-	-	-	-	-
	5.175	.2037														
5.175	5.14	.2024	124542	UM5-517	16	.64	-	-	-	-	-	-	-	-	-	-
	5.20	.2047														
5.2	5.165	.2033	124543	UM5-520	16.1	.64	-	-	-	-	-	-	-	-	-	-
	5.225	.2057														
5.225	5.19	.2043	124544	UM5-522	16.1	.64	-	-	-	-	-	-	-	-	-	-
	5.25	.2067														
5.25	5.215	.2053	124545	UM5-525	16.1	.64	-	-	-	-	-	-	-	-	-	-
	5.275	.2077														
5.275	5.24	.2063	124546	UM5-527	16.1	.64	-	-	-	-	-	-	-	-	-	-
	5.30	.2087														
5.3	5.265	.2073	124547	UM5-530	16.1	.64	-	-	-	-	-	-	-	-	-	-
	5.325	.2096														
5.325	5.29	.2083	124548	UM5-532	16.1	.64	-	-	-	-	-	-	-	-	-	-
	5.35	.2106														
5.35	5.315	.2093	124549	UM5-535	16.6	.66	-	-	-	-	-	-	-	-	-	-
	5.375	.2116														
5.375	5.34	.2102	124550	UM5-537	16.6	.66	-	-	-	-	-	-	-	-	-	-
	5.40	.2126														
5.4	5.365	.2112	124551	UM5-540	16.6	.66	-	-	-	-	-	-	-	-	-	-
	5.425	.2136														
5.425	5.39	.2122	124552	UM5-542	16.6	.66	-	-	-	-	-	-	-	-	-	-
	5.45	.2146														
5.45	5.415	.2132	124553	UM5-545	16.6	.66	-	-	-	-	-	-	-	-	-	-
	5.475	.2156														
5.475	5.44	.2142	124554	UM5-547	25.5	1.01	-	-	-	-	-	-	-	-	-	-
	5.50	.2165														
5.5	5.465	.2152	124555	UM5-550	25.5	1.01	-	-	-	-	-	-	-	-	-	-
	5.525	.2175														



# UM10 >

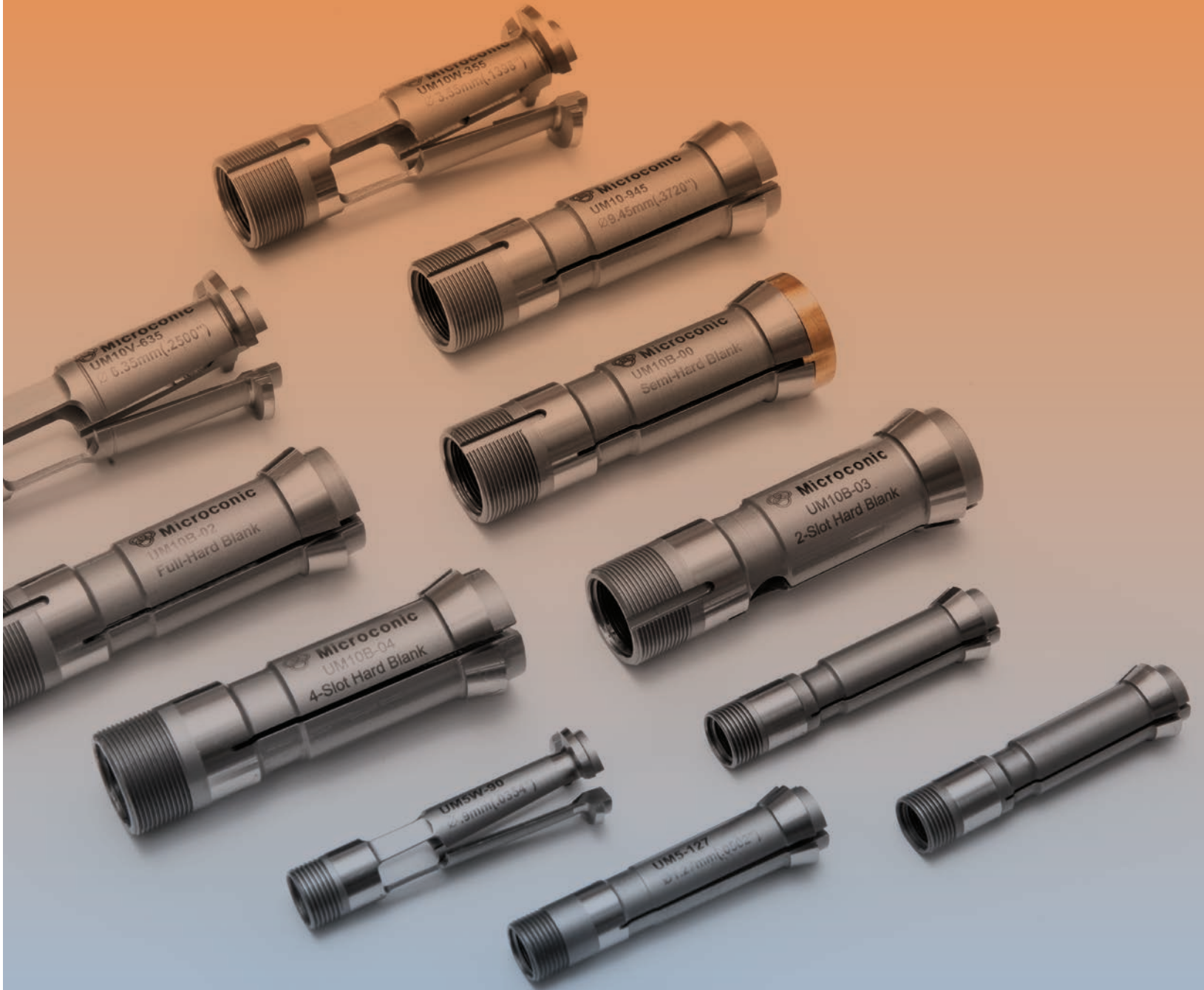

# < UM5

# UM10 MICROCONIC COLLETS

Part Size Range ØA			SKU	Item Number	B		ØG		ØC1		D1		ØC2		D2	
mm	inch				mm	inch	mm	inch	mm	inch	mm	inch	mm	inch	mm	inch
0.25	.22 .27	.0098 .0087 .0106	123001	UM10-25	1.6	.07	-	-	-	-	-	-	-	-	-	-
0.28	.25 .30	.0110 .0098 .0118	123002	UM10-28	1.6	.07	-	-	-	-	-	-	-	-	-	-
0.31	.28 .33	.0122 .0110 .0130	123003	UM10-31	1.6	.07	-	-	-	-	-	-	-	-	-	-
0.34	.31 .36	.0134 .0122 .0142	123004	UM10-34	1.6	.07	-	-	-	-	-	-	-	-	-	-
0.37	.34 .39	.0146 .0134 .0154	123005	UM10-37	1.8	.08	-	-	-	-	-	-	-	-	-	-
0.4	.35 .43	.0157 .0138 .0169	123006	UM10-40	1.9	.08	-	-	-	-	-	-	-	-	-	-
0.45	.40 .48	.0177 .0157 .0189	123007	UM10-45	1.9	.08	-	-	-	-	-	-	-	-	-	-
			123546	UM10W-45	2.2	.09	6.1	.24	7.4	.29	5.6	.22	9.9	.38	15.1	.60
0.5	.45 .53	.0197 .0177 .0209	123008	UM10-50	1.9	.08	-	-	-	-	-	-	-	-	-	-
			123009	UM10W-50	2.2	.09	6.1	.24	7.4	.29	5.6	.22	9.9	.38	15.1	.60
0.55	.50 .58	.0217 .0197 .0228	123010	UM10-55	1.9	.08	-	-	-	-	-	-	-	-	-	-
			123011	UM10W-55	2.2	.09	6.2	.24	7.4	.29	5.6	.22	9.9	.38	15.1	.60
0.6	.55 .63	.0236 .0217 .0248	123012	UM10-60	1.9	.08	-	-	-	-	-	-	-	-	-	-
			123013	UM10W-60	2.2	.09	6.2	.24	7.4	.28	5.6	.22	9.8	.38	15.1	.60
0.65	.60 .68	.0256 .0236 .0268	123014	UM10-65	1.9	.08	-	-	-	-	-	-	-	-	-	-
			123015	UM10W-65	2.3	.09	6.3	.24	7.4	.28	5.6	.22	9.8	.38	15.1	.60
0.7	.65 .73	.0276 .0256 .0287	123016	UM10-70	1.9	.08	-	-	-	-	-	-	-	-	-	-
			123017	UM10W-70	2.3	.09	6.3	.24	7.4	.28	5.6	.22	9.8	.38	15.1	.60
0.75	.70 .78	.0295 .0276 .0307	123018	UM10-75	2	.08	-	-	-	-	-	-	-	-	-	-
			123019	UM10W-75	2.3	.10	6.3	.24	7.4	.28	5.6	.22	9.8	.38	15.1	.60
0.8	.75 .83	.0315 .0295 .0327	123020	UM10-80	2	.08	-	-	-	-	-	-	-	-	-	-
			123021	UM10W-80	2.3	.10	6.3	.24	7.4	.28	5.6	.22	9.8	.38	15.1	.60
0.85	.80 .88	.0335 .0315 .0346	123022	UM10-85	2	.08	-	-	-	-	-	-	-	-	-	-
			123023	UM10W-85	2.4	.10	6.4	.25	7.4	.28	5.6	.22	9.8	.38	15.1	.60
0.9	.85 .93	.0354 .0335 .0366	123024	UM10-90	2.5	.10	-	-	-	-	-	-	-	-	-	-
			123025	UM10W-90	2.4	.10	6.4	.25	7.4	.28	5.6	.22	9.8	.38	15.1	.60
0.95	.90 .98	.0374 .0354 .0386	123026	UM10-95	2.5	.10	-	-	-	-	-	-	-	-	-	-
			123027	UM10W-95	2.4	.10	6.4	.25	7.4	.29	5.6	.22	9.9	.38	15.1	.60
1	.95 1.03	.0394 .0374 .0406	123028	UM10-100	2.8	.11	-	-	-	-	-	-	-	-	-	-
			123029	UM10W-100	2.4	.10	6.4	.25	7.4	.29	5.6	.22	9.9	.38	15.1	.60
1.05	1.00 1.08	.0413 .0394 .0425	123030	UM10-105	2.8	.12	-	-	-	-	-	-	-	-	-	-
			123031	UM10W-105	2.4	.10	6.4	.25	7.4	.29	5.6	.22	9.9	.38	15.1	.60
1.1	1.05 1.13	.0433 .0413 .0445	123032	UM10-110	2.8	.12	-	-	-	-	-	-	-	-	-	-
			123033	UM10W-110	2.4	.10	6.5	.25	7.4	.29	5.6	.22	9.9	.38	15.1	.60
1.15	1.10 1.18	.0453 .0433 .0465	123034	UM10-115	2.8	.12	-	-	-	-	-	-	-	-	-	-
			123035	UM10W-115	2.5	.10	6.5	.25	7.4	.29	5.6	.22	9.9	.38	15.1	.60
1.2	1.15 1.23	.0472 .0453 .0484	123036	UM10-120	3.4	.14	-	-	-	-	-	-	-	-	-	-
			123037	UM10W-120	2.5	.10	6.5	.25	7.4	.29	5.6	.22	9.9	.38	15.1	.60
1.25	1.20 1.28	.0492 .0472 .0504	123038	UM10-125	3.4	.14	-	-	-	-	-	-	-	-	-	-
			123039	UM10W-125	2.5	.10	6.6	.25	7.4	.29	5.6	.22	9.9	.38	15.1	.60

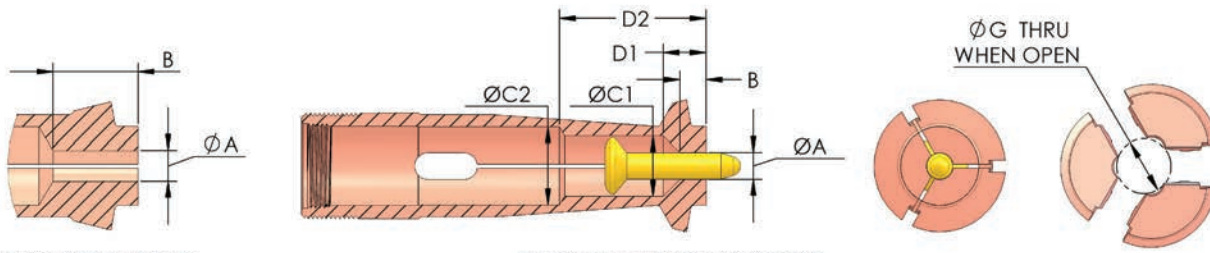

UM10 REGULAR TYPE

UM10W, T and V OVER-GRIP TYPE

**UM10** - Regular Type **UM10W** - Short Land Over-grip **UM10T** - Long Land Over-grip **UM10V** - Larger Capacity Over-grip

Part Size Range ØA			SKU	Item Number	B		ØG		ØC1	D1		ØC2	D2			
mm	inch	mm			inch	mm	inch	mm		inch	mm		inch	mm	inch	
1.3	1.25	.0512 <sup>.0492</sup>	123040	UM10-130	3.4	.14	-	-	-	-	-	-	-	-		
	1.33	.0512 <sup>.0524</sup>	123041	UM10W-130	2.6	.11	6.6	.25	7.4	.29	5.6	.22	9.9	.38	15.1	.60
1.35	1.30	.0531 <sup>.0512</sup>	123042	UM10-135	3.9	.16	-	-	-	-	-	-	-	-	-	
	1.38	.0531 <sup>.0543</sup>	123043	UM10W-135	2.6	.11	6.6	.26	7.4	.29	5.6	.22	9.9	.38	15.1	.60
1.4	1.35	.0551 <sup>.0531</sup>	123044	UM10-140	3.9	.16	-	-	-	-	-	-	-	-	-	
	1.43	.0551 <sup>.0563</sup>	123045	UM10W-140	2.6	.11	6.6	.26	7.4	.29	5.6	.22	9.9	.38	15.1	.60
1.45	1.40	.0571 <sup>.0551</sup>	123046	UM10-145	4.5	.18	-	-	-	-	-	-	-	-	-	
	1.48	.0571 <sup>.0583</sup>	123047	UM10W-145	2.6	.11	6.7	.26	7.4	.29	5.6	.22	9.9	.38	15.1	.60
1.5	1.45	.0591 <sup>.0571</sup>	123048	UM10-150	4.5	.18	-	-	-	-	-	-	-	-	-	
	1.53	.0591 <sup>.0602</sup>	123049	UM10W-150	2.7	.11	6.7	.26	7.4	.29	5.6	.22	9.9	.38	15.1	.60
1.55	1.50	.0610 <sup>.0591</sup>	123050	UM10-155	4.5	.18	-	-	-	-	-	-	-	-	-	
	1.58	.0610 <sup>.0622</sup>	123051	UM10W-155	2.7	.11	6.7	.26	7.4	.29	5.6	.22	9.9	.38	15.1	.60
				123338	UM10T-155	5.8	.23	6.5	.25	7.4	.29	7	.28	9.9	.39	17.1
1.6	1.55	.0630 <sup>.0610</sup>	123052	UM10-160	4.5	.18	-	-	-	-	-	-	-	-	-	
	1.63	.0630 <sup>.0642</sup>	123053	UM10W-160	2.7	.11	6.8	.26	7.4	.29	5.6	.22	9.9	.38	15.1	.60
				123339	UM10T-160	5.8	.23	6.5	.25	7.4	.29	7	.28	9.9	.39	17.1
1.65	1.60	.0650 <sup>.0630</sup>	123054	UM10-165	4.8	.19	-	-	-	-	-	-	-	-	-	
	1.68	.0650 <sup>.0661</sup>	123055	UM10W-165	2.7	.11	6.8	.26	7.4	.29	5.6	.22	9.9	.38	15.1	.60
				123340	UM10T-165	5.8	.23	6.6	.25	7.4	.29	7	.28	9.9	.39	17.1
1.7	1.65	.0669 <sup>.0650</sup>	123056	UM10-170	4.8	.19	-	-	-	-	-	-	-	-	-	
	1.73	.0669 <sup>.0681</sup>	123057	UM10W-170	2.8	.11	6.8	.26	7.4	.29	5.6	.22	9.9	.38	15.1	.60
				123341	UM10T-170	5.8	.23	6.6	.26	7.4	.29	7	.28	9.9	.39	17.1
1.75	1.70	.0689 <sup>.0669</sup>	123058	UM10-175	4.8	.19	-	-	-	-	-	-	-	-	-	
	1.78	.0689 <sup>.0701</sup>	123059	UM10W-175	2.8	.11	6.9	.27	7.4	.29	5.6	.22	9.9	.38	15.1	.60
				123342	UM10T-175	5.8	.23	6.6	.26	7.4	.29	7	.28	9.9	.39	17.1
1.8	1.75	.0709 <sup>.0689</sup>	123060	UM10-180	5.3	.21	-	-	-	-	-	-	-	-	-	
	1.83	.0709 <sup>.0720</sup>	123061	UM10W-180	2.8	.11	6.9	.27	7.4	.29	5.6	.22	9.9	.38	15.1	.60
				123343	UM10T-180	5.9	.24	6.7	.26	7.4	.29	7	.28	9.9	.39	17.1
1.85	1.80	.0728 <sup>.0709</sup>	123062	UM10-185	5.3	.21	-	-	-	-	-	-	-	-	-	
	1.88	.0728 <sup>.0740</sup>	123063	UM10W-185	2.8	.12	6.9	.27	7.4	.29	5.6	.22	9.9	.38	15.1	.60
				123344	UM10T-185	5.9	.24	6.7	.26	7.4	.29	7	.28	9.9	.39	17.1
1.9	1.85	.0748 <sup>.0728</sup>	123064	UM10-190	5.9	.24	-	-	-	-	-	-	-	-	-	
	1.93	.0748 <sup>.0760</sup>	123065	UM10W-190	2.8	.12	7	.27	7.4	.29	5.6	.22	9.9	.38	15.1	.60
				123345	UM10T-190	5.9	.24	6.8	.26	7.4	.29	7	.28	9.9	.39	17.1
1.95	1.90	.0768 <sup>.0748</sup>	123066	UM10-195	5.9	.24	-	-	-	-	-	-	-	-	-	
	1.98	.0768 <sup>.0780</sup>	123067	UM10W-195	2.9	.12	7	.27	7.4	.29	5.6	.22	9.9	.38	15.1	.60
				123346	UM10T-195	5.9	.24	6.8	.26	7.4	.29	7	.28	9.9	.39	17.1
2	1.95	.0787 <sup>.0768</sup>	123068	UM10-200	5.9	.24	-	-	-	-	-	-	-	-	-	
	2.03	.0787 <sup>.0799</sup>	123069	UM10W-200	2.9	.12	7	.27	7.4	.29	5.6	.22	9.9	.38	15.1	.60
				123347	UM10T-200	5.9	.24	6.8	.26	7.4	.29	7	.28	9.9	.39	17.1

# UM10 MICROCONIC COLLETS

Part Size Range ØA			SKU	Item Number	B		ØG		ØC1		D1		ØC2		D2	
mm	inch				mm	inch	mm	inch	mm	inch	mm	inch	mm	inch	mm	inch
2.05	2.00 2.08	.0807 .0787 .0819	123070	UM10-205	5.9	.24	-	-	-	-	-	-	-	-	-	-
			123071	UM10W-205	2.9	.12	7.1	.27	7.4	.29	5.6	.22	9.9	.38	15.1	.60
			123348	UM10T-205	5.9	.24	6.9	.27	7.4	.29	7	.28	9.9	.39	17.1	.68
2.1	2.05 2.13	.0827 .0807 .0839	123072	UM10-210	6.4	.26	-	-	-	-	-	-	-	-	-	-
			123073	UM10W-210	2.9	.12	7.1	.27	7.4	.29	5.6	.22	9.9	.38	15.1	.60
			123349	UM10T-210	5.9	.24	6.9	.27	7.4	.29	7	.28	9.9	.39	17.1	.68
2.15	2.10 2.18	.0846 .0827 .0858	123074	UM10-215	6.4	.26	-	-	-	-	-	-	-	-	-	-
			123075	UM10W-215	3	.12	7.1	.28	7.4	.29	5.6	.22	9.9	.38	15.1	.60
			123350	UM10T-215	6.5	.26	6.8	.26	7.5	.29	7.6	.30	9.9	.39	17.1	.68
2.2	2.15 2.23	.0866 .0846 .0878	123076	UM10-220	6.5	.26	-	-	-	-	-	-	-	-	-	-
			123077	UM10W-220	3	.12	7.2	.28	7.4	.29	5.6	.22	9.9	.38	15.1	.60
			123351	UM10T-220	6.5	.26	6.9	.27	7.5	.29	7.6	.30	9.9	.39	17.1	.68
2.25	2.20 2.28	.0886 .0866 .0898	123078	UM10-225	6.7	.27	-	-	-	-	-	-	-	-	-	-
			123079	UM10W-225	3	.12	7.2	.28	7.4	.29	5.6	.22	9.9	.38	15.1	.60
			123352	UM10T-225	6.5	.26	6.9	.27	7.5	.29	7.6	.30	9.9	.39	17.1	.68
2.3	2.25 2.33	.0906 .0886 .0917	123080	UM10-230	6.7	.27	-	-	-	-	-	-	-	-	-	-
			123081	UM10W-230	3	.12	7.2	.28	7.4	.29	5.6	.22	9.9	.38	15.1	.60
			123353	UM10T-230	6.5	.26	6.9	.27	7.5	.29	7.6	.30	9.9	.39	17.1	.68
2.35	2.30 2.38	.0925 .0906 .0937	123082	UM10-235	6.8	.27	-	-	-	-	-	-	-	-	-	-
			123083	UM10W-235	3.1	.13	7.3	.28	7.4	.29	5.6	.22	9.9	.38	15.1	.60
			123354	UM10T-235	6.5	.26	7	.27	7.5	.29	7.6	.30	9.9	.39	17.1	.68
2.4	2.35 2.43	.0945 .0925 .0957	123084	UM10-240	7.3	.29	-	-	-	-	-	-	-	-	-	-
			123085	UM10W-240	3.1	.13	7.3	.28	7.4	.29	5.6	.22	9.9	.38	15.1	.60
			123355	UM10T-240	6.5	.26	7	.27	7.5	.29	7.6	.30	9.9	.39	17.1	.68
2.45	2.40 2.48	.0965 .0945 .0976	123086	UM10-245	7.3	.29	-	-	-	-	-	-	-	-	-	-
			123087	UM10W-245	3.1	.13	7.4	.28	7.4	.29	5.6	.22	9.9	.38	15.1	.60
			123356	UM10T-245	7.1	.29	7	.27	7.5	.29	8.2	.32	9.9	.38	17.1	.68
2.5	2.45 2.53	.0984 .0965 .0996	123088	UM10-250	7.8	.31	-	-	-	-	-	-	-	-	-	-
			123089	UM10W-250	3.2	.13	7.4	.29	7.4	.29	5.6	.22	9.9	.38	15.1	.60
			123357	UM10T-250	7.1	.29	7	.27	7.5	.29	8.2	.32	9.9	.38	17.1	.68
2.55	2.50 2.58	.1004 .0984 .1016	123090	UM10-255	7.8	.31	-	-	-	-	-	-	-	-	-	-
			123091	UM10W-255	3.2	.13	7.4	.29	7.4	.29	5.6	.22	9.9	.38	15.1	.60
			123358	UM10T-255	7.1	.29	7	.27	7.5	.29	8.2	.32	9.9	.39	17.1	.68
2.6	2.55 2.63	.1024 .1004 .1035	123092	UM10-260	7.8	.31	-	-	-	-	-	-	-	-	-	-
			123093	UM10W-260	3.2	.13	7.4	.29	7.4	.29	5.6	.22	9.9	.38	15.1	.60
			123359	UM10T-260	7.2	.29	7.1	.27	7.5	.29	8.2	.32	9.9	.39	17.1	.68
2.65	2.60 2.68	.1043 .1024 .1055	123094	UM10-265	7.9	.31	-	-	-	-	-	-	-	-	-	-
			123095	UM10W-265	3.2	.13	7.5	.29	7.4	.29	5.6	.22	9.9	.38	15.1	.60
			123360	UM10T-265	7.2	.29	7.1	.28	7.5	.29	8.2	.32	9.9	.39	17.1	.68
2.7	2.65 2.73	.1063 .1043 .1075	123096	UM10-270	8.4	.33	-	-	-	-	-	-	-	-	-	-
			123097	UM10W-270	3.2	.13	7.5	.29	7.4	.29	5.6	.22	9.9	.38	15.1	.60
			123361	UM10T-270	7.2	.29	7.2	.28	7.5	.29	8.2	.32	9.9	.39	17.1	.68
2.75	2.70 2.78	.1083 .1063 .1094	123098	UM10-275	8.4	.34	-	-	-	-	-	-	-	-	-	-
			123099	UM10W-275	3.3	.13	7.6	.29	7.4	.29	5.6	.22	9.9	.38	15.1	.60
			123362	UM10T-275	7.7	.31	7.1	.27	7.5	.29	8.7	.34	9.9	.38	17.1	.68

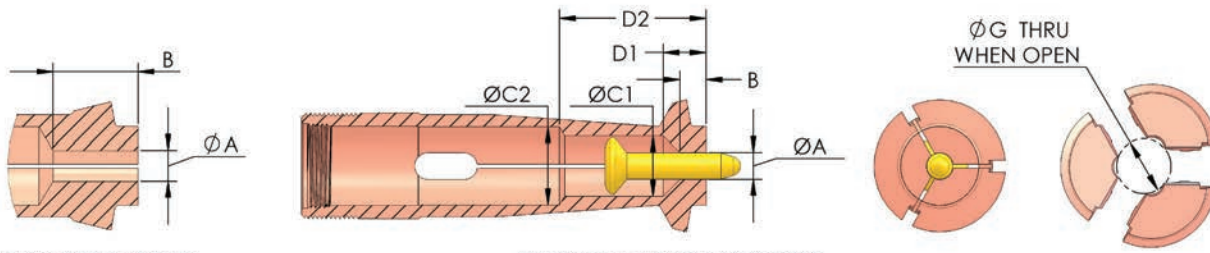

UM10 REGULAR TYPE

UM10W, T and V OVER-GRIP TYPE

**UM10** - Regular Type **UM10W** - Short Land Over-grip **UM10T** - Long Land Over-grip **UM10V** - Larger Capacity Over-grip

Part Size Range ØA			SKU	Item Number	B		ØG		ØC1		D1		ØC2		D2	
mm	inch				mm	inch	mm	inch	mm	inch	mm	inch	mm	inch	mm	inch
2.8	2.75	.1102 <sup>.1083</sup> .1114	123100	UM10-280	8.9	.36	-	-	-	-	-	-	-	-	-	-
	2.83		123101	UM10W-280	3.3	.13	7.6	.29	7.4	.29	5.6	.22	9.9	.38	15.1	.60
			123363	UM10T-280	7.7	.31	7.1	.28	7.5	.29	8.7	.34	9.9	.38	17.1	.68
2.85	2.80	.1122 <sup>.1102</sup> .1134	123102	UM10-285	8.9	.36	-	-	-	-	-	-	-	-	-	-
	2.88		123103	UM10W-285	3.3	.14	7.6	.30	7.4	.29	5.6	.22	9.9	.38	15.1	.60
			123364	UM10T-285	7.7	.31	7.2	.28	7.5	.29	8.7	.34	9.9	.39	17.1	.68
2.9	2.85	.1142 <sup>.1122</sup> .1154	123104	UM10-290	9	.36	-	-	-	-	-	-	-	-	-	-
	2.93		123105	UM10W-290	3.3	.14	7.7	.30	7.4	.29	5.6	.22	9.9	.38	15.1	.60
			123365	UM10T-290	7.8	.31	7.2	.28	7.5	.29	8.7	.34	9.9	.39	17.1	.68
2.95	2.90	.1161 <sup>.1142</sup> .1173	123106	UM10-295	9.2	.37	-	-	-	-	-	-	-	-	-	-
	2.98		123107	UM10W-295	3.4	.14	7.7	.30	7.4	.29	5.6	.22	9.9	.38	15.1	.60
			123366	UM10T-295	7.8	.31	7.3	.28	7.5	.29	8.7	.34	9.9	.39	17.1	.68
3	2.95	.1181 <sup>.1161</sup> .1193	123108	UM10-300	9.2	.37	-	-	-	-	-	-	-	-	-	-
	3.03		123109	UM10W-300	3.4	.14	7.7	.30	7.4	.29	5.6	.22	9.9	.38	15.1	.60
			123367	UM10T-300	8.3	.33	7.2	.28	7.5	.29	9.2	.36	9.9	.38	17.1	.68
3.05	3.00	.1201 <sup>.1181</sup> .1213	123110	UM10-305	9.3	.37	-	-	-	-	-	-	-	-	-	-
	3.08		123111	UM10W-305	3.4	.14	7.8	.30	7.4	.29	5.6	.22	9.9	.38	15.1	.60
			123368	UM10T-305	8.3	.33	7.3	.28	7.5	.29	9.2	.36	9.9	.38	17.1	.68
3.1	3.05	.1220 <sup>.1201</sup> .1232	123112	UM10-310	9.3	.37	-	-	-	-	-	-	-	-	-	-
	3.13		123113	UM10W-310	3.5	.14	7.8	.30	7.4	.29	5.6	.22	9.9	.38	15.1	.60
			123369	UM10T-310	8.3	.33	7.3	.28	7.5	.29	9.2	.36	9.9	.38	17.1	.68
3.15	3.10	.1240 <sup>.1220</sup> .1252	123114	UM10-315	9.8	.39	-	-	-	-	-	-	-	-	-	-
	3.18		123115	UM10W-315	3.5	.14	7.9	.30	7.4	.29	5.6	.22	9.9	.38	15.1	.60
			123370	UM10T-315	8.3	.33	7.3	.28	7.5	.29	9.2	.36	9.9	.38	17.1	.68
3.2	3.15	.1260 <sup>.1240</sup> .1272	123116	UM10-320	9.8	.39	-	-	-	-	-	-	-	-	-	-
	3.23		123117	UM10W-320	3.5	.14	7.9	.31	7.4	.29	5.6	.22	9.9	.38	15.1	.60
			123371	UM10T-320	8.3	.33	7.4	.29	7.5	.29	9.2	.36	9.9	.39	17.1	.68
3.25	3.20	.1280 <sup>.1260</sup> .1291	123118	UM10-325	25.8	1.02	-	-	-	-	-	-	-	-	-	-
	3.28		123119	UM10W-325	3.5	.14	7.9	.31	7.4	.29	5.6	.22	9.9	.38	15.1	.60
			123372	UM10T-325	8.3	.33	7.4	.29	7.5	.29	9.2	.36	9.9	.39	17.1	.68
3.3	3.25	.1299 <sup>.1280</sup> .1311	123120	UM10-330	11	.44	-	-	-	-	-	-	-	-	-	-
	3.33		123121	UM10W-330	3.6	.14	8	.31	7.4	.29	5.6	.22	9.9	.38	15.1	.60
			123373	UM10T-330	8.9	.35	7.4	.29	7.5	.29	9.7	.38	9.9	.38	17.1	.68
3.35	3.30	.1319 <sup>.1299</sup> .1331	123122	UM10-335	11	.44	-	-	-	-	-	-	-	-	-	-
	3.38		123123	UM10W-335	3.6	.15	8	.31	7.4	.29	5.6	.22	9.9	.38	15.1	.60
			123374	UM10T-335	8.9	.35	7.4	.29	7.5	.29	9.7	.38	9.9	.38	17.1	.68
3.4	3.35	.1339 <sup>.1319</sup> .1350	123124	UM10-340	11	.44	-	-	-	-	-	-	-	-	-	-
	3.43		123125	UM10W-340	3.6	.15	8	.31	7.4	.29	5.6	.22	9.9	.38	15.1	.60
			123375	UM10T-340	8.9	.35	7.5	.29	7.5	.29	9.7	.38	9.9	.38	17.1	.68

# UM10 MICROCONIC COLLETS

Part Size Range ØA			SKU	Item Number	B		ØG		ØC1		D1		ØC2		D2	
mm	inch				mm	inch	mm	inch	mm	inch	mm	inch	mm	inch	mm	inch
3.45	3.40 3.48	.1358 .1339 .1370	123126	UM10-345	11	.44	-	-	-	-	-	-	-	-	-	-
			123127	UM10W-345	3.6	.15	8.1	.31	7.4	.29	5.6	.22	9.9	.38	15.1	.60
			123376	UM10T-345	8.9	.35	7.5	.29	7.5	.29	9.7	.38	9.9	.38	17.1	.68
3.5	3.45 3.53	.1378 .1358 .1390	123128	UM10-350	11	.44	-	-	-	-	-	-	-	-	-	-
			123129	UM10W-350	3.6	.15	8.1	.31	7.4	.29	5.6	.22	9.9	.38	15.1	.60
			123377	UM10T-350	8.9	.35	7.5	.29	7.5	.29	9.7	.38	9.9	.39	17.1	.68
3.55	3.50 3.58	.1398 .1378 .1409	123130	UM10-355	11	.44	-	-	-	-	-	-	-	-	-	-
			123131	UM10W-355	3.7	.15	8.1	.32	7.4	.29	5.6	.22	9.9	.38	15.1	.60
			123378	UM10T-355	8.9	.36	7.6	.29	7.5	.29	9.7	.38	9.9	.39	17.1	.68
3.6	3.55 3.63	.1417 .1398 .1429	123132	UM10-360	11.1	.44	-	-	-	-	-	-	-	-	-	-
			123133	UM10W-360	3.7	.15	8.2	.32	7.4	.29	5.6	.22	9.9	.38	15.1	.60
			123379	UM10T-360	8.9	.36	7.6	.29	7.5	.29	9.7	.38	9.9	.39	17.1	.68
3.65	3.60 3.68	.1437 .1417 .1449	123134	UM10-365	11.1	.44	-	-	-	-	-	-	-	-	-	-
			123135	UM10W-365	3.7	.15	8.2	.32	7.4	.29	5.6	.22	9.9	.38	15.1	.60
			123380	UM10T-365	9.5	.38	7.5	.29	7.5	.29	10.3	.41	9.9	.39	17.1	.68
3.7	3.65 3.73	.1457 .1437 .1469	123136	UM10-370	11.1	.44	-	-	-	-	-	-	-	-	-	-
			123137	UM10W-370	3.7	.15	8.3	.32	7.4	.29	5.6	.22	9.9	.38	15.1	.60
			123381	UM10T-370	9.5	.38	7.6	.29	7.5	.29	10.3	.41	9.9	.39	17.1	.68
3.75	3.70 3.78	.1476 .1457 .1488	123138	UM10-375	11.1	.44	-	-	-	-	-	-	-	-	-	-
			123139	UM10W-375	3.8	.15	8.3	.32	7.4	.29	5.6	.22	9.9	.38	15.1	.60
			123382	UM10T-375	9.5	.38	7.6	.30	7.5	.29	10.3	.41	9.9	.39	17.1	.68
3.8	3.75 3.83	.1496 .1476 .1508	123140	UM10-380	11.1	.44	-	-	-	-	-	-	-	-	-	-
			123141	UM10W-380	3.8	.15	8.3	.32	7.4	.29	5.6	.22	9.9	.38	15.1	.60
			123383	UM10T-380	9.6	.38	7.7	.30	7.5	.29	10.3	.41	9.9	.39	17.1	.68
3.85	3.80 3.88	.1516 .1496 .1528	123142	UM10-385	11.1	.44	-	-	-	-	-	-	-	-	-	-
			123143	UM10W-385	3.8	.15	8.4	.32	7.4	.29	5.6	.22	9.9	.38	15.1	.60
			123384	UM10T-385	9.6	.38	7.7	.30	7.5	.29	10.3	.41	9.9	.39	17.1	.68
3.9	3.85 3.93	.1535 .1516 .1547	123144	UM10-390	11.2	.44	-	-	-	-	-	-	-	-	-	-
			123145	UM10W-390	3.8	.16	8.4	.33	7.4	.29	5.6	.22	9.9	.38	15.1	.60
			123385	UM10T-390	9.6	.38	7.8	.30	7.5	.29	10.3	.41	9.9	.39	17.1	.68
3.95	3.90 3.98	.1555 .1535 .1567	123146	UM10-395	11.2	.44	-	-	-	-	-	-	-	-	-	-
			123147	UM10W-395	3.9	.16	8.4	.33	7.4	.29	5.6	.22	9.9	.38	15.1	.60
			123386	UM10T-395	10.1	.40	7.7	.30	7.5	.29	10.9	.43	9.9	.39	17.1	.68
4	3.95 4.03	.1575 .1555 .1587	123148	UM10-400	11.2	.44	-	-	-	-	-	-	-	-	-	-
			123149	UM10W-400	3.9	.16	8.5	.33	7.4	.29	5.6	.22	9.9	.38	15.1	.60
			123387	UM10T-400	10.2	.40	7.7	.30	7.5	.29	10.9	.43	9.9	.39	17.1	.68
4.05	4.00 4.08	.1594 .1575 .1606	123150	UM10-405	11.2	.45	-	-	-	-	-	-	-	-	-	-
			123151	UM10W-405	3.9	.16	8.5	.33	7.4	.29	5.6	.22	9.9	.38	15.1	.60
			123388	UM10T-405	10.2	.40	7.8	.30	7.5	.29	10.9	.43	9.9	.39	17.1	.68
4.1	4.05 4.13	.1614 .1594 .1626	123152	UM10-410	11.2	.45	-	-	-	-	-	-	-	-	-	-
			123153	UM10W-410	3.9	.16	8.6	.33	7.4	.29	5.6	.22	9.9	.38	15.1	.60
			123389	UM10T-410	10.2	.41	7.8	.30	7.5	.29	10.9	.43	9.9	.39	17.1	.68

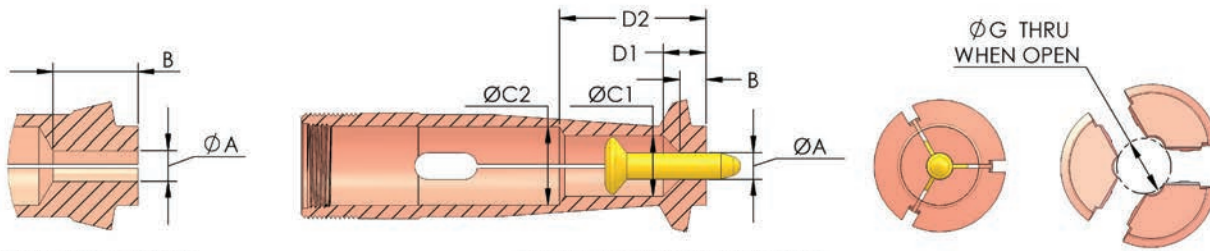

UM10 REGULAR TYPE

UM10W, T and V OVER-GRIP TYPE

**UM10** - Regular Type **UM10W** - Short Land Over-grip **UM10T** - Long Land Over-grip **UM10V** - Larger Capacity Over-grip

Part Size	Range ØA		SKU	Item Number	B		ØG		ØC1		D1		ØC2		D2	
	mm	inch			mm	inch	mm	inch	mm	inch	mm	inch	mm	inch	mm	inch
4.15	4.10 4.18	.1634 .1646	123154	UM10-415	11.2	.45	-	-	-	-	-	-	-	-	-	-
			123155	UM10W-415	4	.16	8.6	.33	7.4	.29	5.6	.22	9.9	.38	15.1	.60
			123390	UM10T-415	10.2	.41	7.9	.30	7.5	.29	10.9	.43	9.9	.39	17.1	.68
			124338	UM10V-415	4	.16	6.8	.26	9.2	.36	6.5	.26	9.9	.39	25.7	1.01
4.2	4.15 4.23	.1654 .1665	123156	UM10-420	11.2	.45	-	-	-	-	-	-	-	-	-	-
			123157	UM10W-420	4	.16	8.6	.33	7.4	.29	5.6	.22	9.9	.38	15.1	.60
			123391	UM10T-420	10.2	.41	7.9	.31	7.5	.29	10.9	.43	9.9	.39	17.1	.68
			124339	UM10V-420	4	.16	6.9	.27	9.2	.36	6.5	.26	9.9	.39	25.7	1.01
4.25	4.20 4.28	.1673 .1685	123158	UM10-425	11.3	.45	-	-	-	-	-	-	-	-	-	-
			123159	UM10W-425	4	.16	8.7	.34	7.4	.29	5.6	.22	9.9	.38	15.1	.60
			123392	UM10T-425	10.7	.43	7.9	.31	7.5	.29	11.4	.45	9.9	.38	17.1	.68
			123429	UM10V-425	4	.16	6.9	.27	9.2	.36	6.5	.26	9.9	.39	25.7	1.01
4.3	4.25 4.33	.1693 .1705	123160	UM10-430	11.3	.45	-	-	-	-	-	-	-	-	-	-
			123161	UM10W-430	4	.16	8.7	.34	7.4	.29	5.6	.22	9.9	.38	15.1	.60
			123393	UM10T-430	10.7	.43	7.9	.31	7.5	.29	11.4	.45	9.9	.38	17.1	.68
			123430	UM10V-430	4	.16	7	.27	9.2	.36	6.5	.26	9.9	.39	25.7	1.01
4.35	4.30 4.38	.1713 .1724	123162	UM10-435	11.3	.45	-	-	-	-	-	-	-	-	-	-
			123163	UM10W-435	4.1	.16	8.8	.34	7.4	.29	5.6	.22	9.9	.38	15.1	.60
			123394	UM10T-435	10.7	.43	8	.31	7.5	.29	11.4	.45	9.9	.39	17.1	.68
			123431	UM10V-435	4.1	.16	7	.27	9.2	.36	6.5	.26	9.9	.39	25.7	1.01
4.4	4.35 4.43	.1732 .1744	123164	UM10-440	11.3	.45	-	-	-	-	-	-	-	-	-	-
			123165	UM10W-440	4.1	.17	8.8	.34	7.4	.29	5.6	.22	9.9	.38	15.1	.60
			123395	UM10T-440	10.7	.43	8	.31	7.5	.29	11.4	.45	9.9	.39	17.1	.68
			123432	UM10V-440	4.1	.17	7	.27	9.2	.36	6.5	.26	9.9	.39	25.7	1.01
4.45	4.40 4.48	.1752 .1764	123166	UM10-445	11.3	.45	-	-	-	-	-	-	-	-	-	-
			123167	UM10W-445	4.1	.17	8.8	.34	7.4	.29	5.6	.22	9.9	.38	15.1	.60
			123396	UM10T-445	10.8	.43	8	.31	7.5	.29	11.4	.45	9.9	.39	17.1	.68
			123433	UM10V-445	4.1	.17	7.1	.27	9.2	.36	6.5	.26	9.9	.39	25.7	1.01
4.5	4.45 4.53	.1772 .1783	123168	UM10-450	11.3	.45	-	-	-	-	-	-	-	-	-	-
			123169	UM10W-450	4.1	.17	8.9	.34	7.4	.29	5.6	.22	9.9	.38	15.1	.60
			123397	UM10T-450	10.8	.43	8.1	.31	7.5	.29	11.4	.45	9.9	.39	17.1	.68
			123434	UM10V-450	4.1	.17	7.1	.28	9.2	.36	6.5	.26	9.9	.39	25.7	1.01
4.55	4.50 4.58	.1791 .1803	123170	UM10-455	11.3	.45	-	-	-	-	-	-	-	-	-	-
			123171	UM10W-455	4.2	.17	8.9	.35	7.4	.29	5.6	.22	9.9	.38	15.1	.60
			123398	UM10T-455	11.3	.45	8	.31	7.5	.29	11.9	.47	9.9	.39	17.1	.68
			123435	UM10V-455	4.2	.17	7.2	.28	9.2	.36	6.5	.26	9.9	.39	25.7	1.01

# UM10 MICROCONIC COLLETS

Part Size Range ØA			SKU	Item Number	B		ØG		ØC1		D1		ØC2		D2	
mm	inch				mm	inch	mm	inch	mm	inch	mm	inch	mm	inch	mm	inch
4.6	4.55 4.63	.1811 .1791 .1823	123172	UM10-460	11.4	.45	-	-	-	-	-	-	-	-	-	-
			123173	UM10W-460	4.2	.17	8.9	.35	7.4	.29	5.6	.22	9.9	.38	15.1	.60
			123399	UM10T-460	11.3	.45	8.1	.31	7.5	.29	11.9	.47	9.9	.39	17.1	.68
			123436	UM10V-460	4.2	.17	7.2	.28	9.2	.36	6.5	.26	9.9	.39	25.7	1.01
4.65	4.60 4.68	.1831 .1811 .1843	123174	UM10-465	11.4	.45	-	-	-	-	-	-	-	-	-	-
			123175	UM10W-465	4.2	.17	9	.35	7.4	.29	5.6	.22	9.9	.38	15.1	.60
			123400	UM10T-465	11.3	.45	8.1	.32	7.5	.29	11.9	.47	9.9	.39	17.1	.68
			123437	UM10V-465	4.2	.17	7.3	.28	9.2	.36	6.5	.26	9.9	.39	25.7	1.01
4.7	4.65 4.73	.1850 .1831 .1862	123176	UM10-470	11.4	.45	-	-	-	-	-	-	-	-	-	-
			123177	UM10W-470	4.2	.17	9	.35	7.4	.29	5.6	.22	9.9	.38	15.1	.60
			123401	UM10T-470	11.3	.45	8.2	.32	7.5	.29	11.9	.47	9.9	.39	17.1	.68
			123438	UM10V-470	4.2	.17	7.3	.28	9.2	.36	6.5	.26	9.9	.39	25.7	1.01
4.75	4.70 4.78	.1870 .1850 .1882	123178	UM10-475	11.4	.45	-	-	-	-	-	-	-	-	-	-
			123179	UM10W-475	4.3	.17	9.1	.35	7.4	.29	5.6	.22	9.9	.38	15.1	.60
			123402	UM10T-475	11.4	.45	8.2	.32	7.5	.29	11.9	.47	9.9	.39	17.1	.68
			123439	UM10V-475	4.3	.17	7.3	.28	9.2	.36	6.5	.26	9.9	.39	25.7	1.01
4.8	4.75 4.83	.1890 .1870 .1902	123180	UM10-480	11.4	.45	-	-	-	-	-	-	-	-	-	-
			123181	UM10W-480	4.3	.17	9.1	.35	7.4	.29	5.6	.22	9.9	.38	15.1	.60
			123403	UM10T-480	11.4	.45	8.3	.32	7.5	.29	11.9	.47	9.9	.39	17.1	.68
			123440	UM10V-480	4.3	.17	7.4	.29	9.2	.36	6.5	.26	9.9	.39	25.7	1.01
4.85	4.80 4.88	.1909 .1890 .1921	123182	UM10-485	11.4	.45	-	-	-	-	-	-	-	-	-	-
			123183	UM10W-485	4.3	.17	9.1	.36	7.4	.29	5.6	.22	9.9	.38	15.1	.60
			123404	UM10T-485	11.4	.45	8.3	.32	7.5	.29	11.9	.47	9.9	.39	17.1	.68
			123441	UM10V-485	4.3	.17	7.4	.29	9.2	.36	6.5	.26	9.9	.39	25.7	1.01
4.9	4.85 4.93	.1929 .1909 .1941	123184	UM10-490	11.5	.46	-	-	-	-	-	-	-	-	-	-
			123185	UM10W-490	4.3	.18	9.2	.36	7.4	.29	5.6	.22	9.9	.38	15.1	.60
			123405	UM10T-490	11.4	.45	8.3	.32	7.5	.29	11.9	.47	9.9	.39	17.1	.68
			123442	UM10V-490	4.3	.18	7.5	.29	9.2	.36	6.5	.26	9.9	.39	25.7	1.01
4.95	4.90 4.98	.1949 .1929 .1961	123186	UM10-495	11.5	.46	-	-	-	-	-	-	-	-	-	-
			123187	UM10W-495	4.4	.18	9.2	.36	7.4	.29	5.6	.22	9.9	.38	15.1	.60
			123406	UM10T-495	12.2	.48	8.3	.32	7.5	.29	12.7	.50	9.9	.38	17.1	.68
			123443	UM10V-495	4.4	.18	7.5	.29	9.2	.36	6.5	.26	9.9	.39	25.7	1.01
5	4.95 5.03	.1969 .1949 .1980	123188	UM10-500	11.5	.46	-	-	-	-	-	-	-	-	-	-
			123189	UM10W-500	4.4	.18	9.3	.36	7.4	.29	5.6	.22	9.9	.38	15.1	.60
			123407	UM10T-500	12.2	.48	8.3	.32	7.5	.29	12.7	.50	9.9	.38	17.1	.68
			123444	UM10V-500	4.4	.18	7.6	.29	9.2	.36	6.5	.26	9.9	.39	25.7	1.01
5.05	5.00 5.08	.1988 .1969 .2000	123190	UM10-505	11.5	.46	-	-	-	-	-	-	-	-	-	-
			123191	UM10W-505	4.4	.18	9.3	.36	7.4	.29	5.6	.22	9.9	.38	15.1	.60
			123408	UM10T-505	12.2	.48	8.4	.32	7.5	.29	12.7	.50	9.9	.38	17.1	.68
			123445	UM10V-505	4.4	.18	7.6	.29	9.2	.36	6.5	.26	9.9	.39	25.7	1.01
5.1	5.05 5.13	.2008 .1988 .2020	123192	UM10-510	11.5	.46	-	-	-	-	-	-	-	-	-	-
			123193	UM10W-510	4.4	.18	9.4	.36	7.4	.29	5.6	.22	9.9	.38	15.1	.60
			123409	UM10T-510	12.2	.48	8.4	.33	7.5	.29	12.7	.50	9.9	.38	17.1	.68
			123446	UM10V-510	4.4	.18	7.7	.30	9.2	.36	6.5	.26	9.9	.39	25.7	1.01



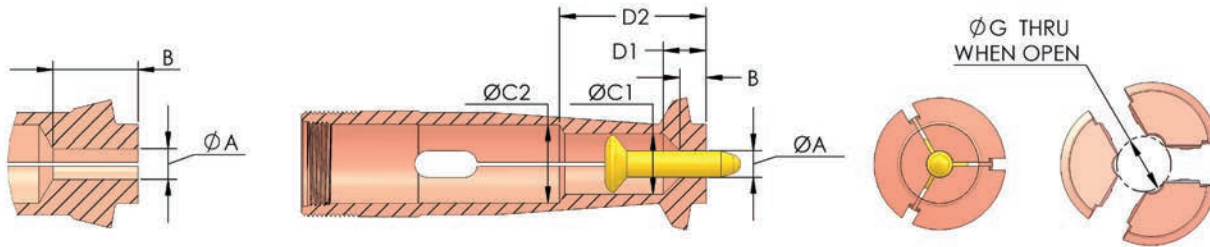

UM10 REGULAR TYPE

UM10W, T and V OVER-GRIP TYPE

UM10 - Regular Type UM10W - Short Land Over-grip UM10T - Long Land Over-grip UM10V - Larger Capacity Over-grip

Part Size Range ØA			SKU	Item Number	B		ØG		ØC1		D1		ØC2		D2	
mm	inch				mm	inch	mm	inch	mm	inch	mm	inch	mm	inch	mm	inch
5.15	5.10 5.18	.2028 .2039	123194	UM10-515	11.5	.46	-	-	-	-	-	-	-	-	-	-
			123195	UM10W-515	4.5	.18	9.4	.36	7.4	.29	5.6	.22	9.9	.38	15.1	.60
			123410	UM10T-515	12.2	.48	8.4	.33	7.5	.29	12.7	.50	9.9	.39	17.1	.68
			123447	UM10V-515	4.5	.18	7.7	.30	9.2	.36	6.5	.26	9.9	.39	25.7	1.01
5.2	5.15 5.23	.2047 .2059	123196	UM10-520	11.5	.46	-	-	-	-	-	-	-	-	-	-
			123197	UM10W-520	4.5	.18	9.4	.37	7.4	.29	5.6	.22	9.9	.38	15.1	.60
			123411	UM10T-520	12.2	.49	8.5	.33	7.5	.29	12.7	.50	9.9	.39	17.1	.68
			123448	UM10V-520	4.5	.18	7.7	.30	9.2	.36	6.5	.26	9.9	.39	25.7	1.01
5.25	5.20 5.28	.2067 .2079	123198	UM10-525	11.5	.46	-	-	-	-	-	-	-	-	-	-
			123199	UM10W-525	4.5	.18	9.5	.37	7.4	.29	5.6	.22	9.9	.38	15.1	.60
			123412	UM10T-525	12.2	.49	8.5	.33	7.5	.29	12.7	.50	9.9	.39	17.1	.68
			123449	UM10V-525	4.5	.18	7.8	.30	9.2	.36	6.5	.26	9.9	.39	25.7	1.01
5.3	5.25 5.33	.2087 .2098	123200	UM10-530	11.6	.46	-	-	-	-	-	-	-	-	-	-
			123201	UM10W-530	4.5	.18	9.5	.37	7.4	.29	5.6	.22	9.9	.38	15.1	.60
			123413	UM10T-530	12.2	.49	8.6	.33	7.5	.29	12.7	.50	9.9	.39	17.1	.68
			123450	UM10V-530	4.5	.18	7.8	.30	9.2	.36	6.5	.26	9.9	.39	25.7	1.01
5.35	5.30 5.38	.2106 .2118	123202	UM10-535	11.6	.46	-	-	-	-	-	-	-	-	-	-
			123203	UM10W-535	4.6	.18	9.5	.37	7.4	.29	5.6	.22	9.9	.38	15.1	.60
			123414	UM10T-535	12.9	.51	8.5	.33	7.5	.29	13.4	.53	9.9	.39	17.1	.68
			123451	UM10V-535	4.6	.18	7.9	.30	9.2	.36	6.5	.26	9.9	.39	25.7	1.01
5.4	5.35 5.43	.2126 .2138	123204	UM10-540	11.6	.46	-	-	-	-	-	-	-	-	-	-
			123205	UM10W-540	4.6	.19	9.6	.37	7.4	.29	5.6	.22	9.9	.38	15.1	.60
			123415	UM10T-540	13	.51	8.6	.33	7.5	.29	13.4	.53	9.9	.39	17.1	.68
			123452	UM10V-540	4.6	.19	7.9	.31	9.2	.36	6.5	.26	9.9	.39	25.7	1.01
5.45	5.40 5.48	.2146 .2157	123206	UM10-545	11.6	.46	-	-	-	-	-	-	-	-	-	-
			123207	UM10W-545	4.6	.19	9.6	.37	7.4	.29	5.6	.22	9.9	.38	15.1	.60
			123416	UM10T-545	13	.52	8.6	.33	7.5	.29	13.4	.53	9.9	.39	17.1	.68
			123453	UM10V-545	4.6	.19	8	.31	9.2	.36	6.5	.26	9.9	.39	25.7	1.01
5.5	5.45 5.53	.2165 .2177	123208	UM10-550	11.6	.46	-	-	-	-	-	-	-	-	-	-
			123209	UM10W-550	4.6	.19	9.7	.38	7.4	.29	5.6	.22	9.9	.38	15.1	.60
			123417	UM10T-550	13	.52	8.6	.34	7.5	.29	13.4	.53	9.9	.39	17.1	.68
			123454	UM10V-550	4.6	.19	8	.31	9.2	.36	6.5	.26	9.9	.39	25.7	1.01
5.55	5.50 5.58	.2185 .2197	123210	UM10-555	11.6	.46	-	-	-	-	-	-	-	-	-	-
			123211	UM10W-555	4.7	.19	9.7	.38	7.4	.29	5.6	.22	9.9	.38	15.1	.60
			123418	UM10T-555	13	.52	8.7	.34	7.5	.29	13.4	.53	9.9	.39	17.1	.68
			123455	UM10V-555	4.7	.19	8	.31	9.2	.36	6.5	.26	9.9	.39	25.7	1.01
5.6	5.55 5.63	.2205 .2217	123212	UM10-560	11.7	.46	-	-	-	-	-	-	-	-	-	-
			123213	UM10W-560	4.7	.19	9.8	.38	7.4	.29	5.6	.22	9.9	.38	15.1	.60
			123419	UM10T-560	13	.52	8.7	.34	7.5	.29	13.4	.53	9.9	.39	17.1	.68
			123456	UM10V-560	4.7	.19	8.1	.31	9.2	.36	6.5	.26	9.9	.39	25.7	1.01

# UM10 MICROCONIC COLLETS

Part Size Range ØA			SKU	Item Number	B		ØG		ØC1		D1		ØC2		D2		
mm	inch				mm	inch	mm	inch	mm	inch	mm	inch	mm	inch	mm	inch	
5.65	5.60	.2224	.2205	123214	UM10-565	11.7	.46	-	-	-	-	-	-	-	-	-	
	5.68			123215	UM10W-565	4.7	.19	9.8	.38	7.4	.29	5.6	.22	9.9	.38	15.1	.60
				123420	UM10T-565	13	.52	8.8	.34	7.5	.29	13.4	.53	9.9	.39	17.1	.68
				123457	UM10V-565	4.7	.19	8.1	.32	9.2	.36	6.5	.26	9.9	.39	25.7	1.01
5.7	5.65	.2244	.2224	123216	UM10-570	11.7	.46	-	-	-	-	-	-	-	-	-	
	5.73			123217	UM10W-570	4.7	.19	9.8	.38	7.4	.29	5.6	.22	9.9	.38	15.1	.60
				123421	UM10T-570	13	.52	8.8	.34	7.5	.29	13.4	.53	9.9	.39	17.1	.68
				123458	UM10V-570	4.7	.19	8.2	.32	9.2	.36	6.5	.26	9.9	.39	25.7	1.01
5.75	5.70	.2264	.2244	123218	UM10-575	11.7	.47	-	-	-	-	-	-	-	-	-	
	5.78			123219	UM10W-575	4.8	.19	9.9	.38	7.4	.29	5.6	.22	9.9	.38	15.1	.60
				123422	UM10T-575	13.7	.54	8.8	.34	7.5	.29	14.1	.55	9.9	.38	17.1	.68
				123459	UM10V-575	4.8	.19	8.2	.32	9.2	.36	6.5	.26	9.9	.39	25.7	1.01
5.8	5.75	.2283	.2264	123220	UM10-580	11.7	.47	-	-	-	-	-	-	-	-	-	
	5.83			123221	UM10W-580	4.8	.19	9.9	.39	7.4	.29	5.6	.22	9.9	.38	15.1	.60
				123423	UM10T-580	13.7	.54	8.8	.34	7.5	.29	14.1	.55	9.9	.38	17.1	.68
				123460	UM10V-580	4.8	.19	8.3	.32	9.2	.36	6.5	.26	9.9	.39	25.7	1.01
5.85	5.80	.2303	.2283	123222	UM10-585	11.7	.47	-	-	-	-	-	-	-	-	-	
	5.88			123223	UM10W-585	4.8	.19	10	.39	7.4	.29	5.6	.22	9.9	.38	15.1	.60
				123424	UM10T-585	13.7	.55	8.8	.34	7.5	.29	14.1	.55	9.9	.38	17.1	.68
				123461	UM10V-585	4.8	.19	8.3	.32	9.2	.36	6.5	.26	9.9	.39	25.7	1.01
5.9	5.85	.2323	.2303	123224	UM10-590	11.8	.47	-	-	-	-	-	-	-	-	-	
	5.93			123225	UM10W-590	4.8	.19	10	.39	7.4	.29	5.6	.22	9.9	.38	15.1	.60
				123425	UM10T-590	13.7	.55	8.9	.35	7.5	.29	14.1	.55	9.9	.38	17.1	.68
				123462	UM10V-590	4.8	.19	8.4	.32	9.2	.36	6.5	.26	9.9	.39	25.7	1.01
5.95	5.90	.2343	.2323	123226	UM10-595	11.8	.47	-	-	-	-	-	-	-	-	-	
	5.98			123227	UM10W-595	4.9	.20	10	.39	7.4	.29	5.6	.22	9.9	.38	15.1	.60
				123426	UM10T-595	13.8	.55	8.9	.35	7.5	.29	14.1	.55	9.9	.39	17.1	.68
				123463	UM10V-595	4.9	.20	8.4	.33	9.2	.36	6.5	.26	9.9	.39	25.7	1.01
6	5.95	.2362	.2343	123228	UM10-600	11.8	.47	-	-	-	-	-	-	-	-	-	
	6.03			123229	UM10W-600	4.9	.20	10.1	.39	7.4	.29	5.6	.22	9.9	.38	15.1	.60
				123427	UM10T-600	13.8	.55	9	.35	7.5	.29	14.1	.55	9.9	.39	17.1	.68
				123464	UM10V-600	4.9	.20	8.5	.33	9.2	.36	6.5	.26	9.9	.39	25.7	1.01
6.05	6.00	.2382	.2362	123230	UM10-605	11.8	.47	-	-	-	-	-	-	-	-	-	
	6.08			123231	UM10W-605	4.9	.20	10.1	.39	7.4	.29	5.6	.22	9.9	.38	15.1	.60
				123509	UM10T-605	13.8	.55	9	.35	7.5	.29	14.1	.55	9.9	.39	17.1	.68
				123465	UM10V-605	4.9	.20	8.5	.33	9.2	.36	6.5	.26	9.9	.39	25.7	1.01
6.1	6.05	.2402	.2382	123232	UM10-610	11.8	.47	-	-	-	-	-	-	-	-	-	
	6.13			123233	UM10W-610	4.9	.20	10.1	.39	7.4	.29	5.6	.22	9.9	.38	15.1	.60
				123510	UM10T-610	13.8	.55	9.1	.35	7.6	.29	14.1	.55	9.9	.39	17.1	.68
				123466	UM10V-610	4.9	.20	8.5	.33	9.3	.36	6.5	.26	9.9	.39	25.7	1.01
6.15	6.10	.2421	.2402	123234	UM10-615	11.8	.47	-	-	-	-	-	-	-	-	-	
	6.18			123235	UM10W-615	4.9	.20	10.2	.40	7.4	.29	5.6	.22	9.9	.38	15.1	.60
				123511	UM10T-615	13.8	.55	9.1	.35	7.6	.29	14.1	.55	9.9	.39	17.1	.68
				123467	UM10V-615	4.9	.20	8.6	.33	9.3	.36	6.5	.26	9.9	.39	25.7	1.01

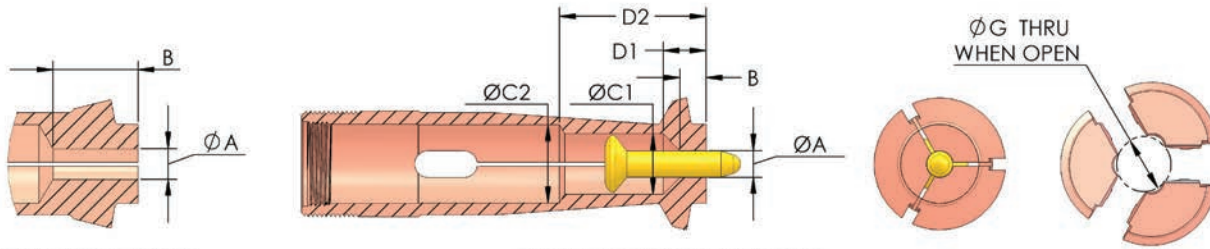

UM10 REGULAR TYPE

UM10W, T and V OVER-GRIP TYPE

**UM10** - Regular Type **UM10W** - Short Land Over-grip **UM10T** - Long Land Over-grip **UM10V** - Larger Capacity Over-grip

Part Size Range ØA		SKU	Item Number	B		ØG		ØC1		D1		ØC2		D2		
mm	inch			mm	inch	mm	inch	mm	inch	mm	inch	mm	inch	mm	inch	
6.2	6.15 6.23	.2441 .2453	123236	UM10-620	11.8	.47	-	-	-	-	-	-	-	-	-	
			123237	UM10W-620	5	.20	10.2	.40	7.4	.29	5.6	.22	9.9	.38	15.1	.60
			123512	UM10T-620	13.8	.55	9.1	.36	7.6	.29	14.1	.55	9.9	.39	17.1	.68
			123468	UM10V-620	5	.20	8.6	.33	9.3	.36	6.5	.26	9.9	.39	25.7	1.01
6.25	6.20 6.28	.2461 .2472	123238	UM10-625	11.9	.47	-	-	-	-	-	-	-	-	-	
			123239	UM10W-625	5	.20	10.3	.40	7.4	.29	5.6	.22	9.9	.38	15.1	.60
			123513	UM10T-625	13.8	.55	9.2	.36	7.6	.29	14.1	.55	9.9	.39	17.1	.68
			123469	UM10V-625	5	.20	8.7	.34	9.2	.36	6.5	.26	9.9	.39	25.7	1.01
6.3	6.25 6.33	.2480 .2492	123240	UM10-630	11.9	.47	-	-	-	-	-	-	-	-	-	
			123241	UM10W-630	5	.20	10.3	.40	7.4	.29	5.6	.22	9.9	.38	15.1	.60
			123514	UM10T-630	13.8	.55	9.3	.36	7.6	.29	14.1	.55	9.9	.39	17.1	.68
			123470	UM10V-630	5	.20	8.7	.34	9.2	.36	6.5	.26	9.9	.39	25.7	1.01
6.35	6.30 6.38	.2500 .2512	123242	UM10-635	11.9	.47	-	-	-	-	-	-	-	-	-	
			123243	UM10W-635	5.1	.20	10.4	.40	7.4	.29	5.6	.22	9.9	.38	15.1	.60
			123515	UM10T-635	13.8	.55	9.3	.36	7.6	.29	14.1	.55	9.9	.39	17.1	.68
			123471	UM10V-635	5.1	.20	8.8	.34	9.2	.36	6.5	.26	9.9	.39	25.7	1.01
6.4	6.35 6.43	.2520 .2531	123244	UM10-640	11.9	.47	-	-	-	-	-	-	-	-	-	
			123245	UM10W-640	5.1	.20	10.4	.40	7.4	.29	5.6	.22	9.9	.38	15.1	.60
			123516	UM10T-640	13.8	.55	9.3	.36	7.6	.29	14.1	.55	9.9	.39	17.1	.68
			123472	UM10V-640	5.1	.20	8.8	.34	9.2	.36	6.5	.26	9.9	.39	25.7	1.01
6.45	6.40 6.48	.2539 .2551	123246	UM10-645	11.9	.47	-	-	-	-	-	-	-	-	-	
			123247	UM10W-645	5.1	.21	10.5	.41	7.4	.29	5.6	.22	9.9	.38	15.1	.60
			123517	UM10T-645	13.9	.55	9.4	.36	7.6	.29	14.1	.55	9.9	.39	17.1	.68
			123473	UM10V-645	5.1	.21	8.9	.34	9.2	.36	6.5	.26	9.9	.39	25.7	1.01
6.5	6.45 6.53	.2559 .2571	123248	UM10-650	11.9	.47	-	-	-	-	-	-	-	-	-	
			123249	UM10W-650	5.1	.21	10.5	.41	7.4	.29	5.6	.22	9.9	.38	15.1	.60
			123518	UM10T-650	13.9	.55	9.4	.37	7.6	.29	14.1	.55	9.9	.39	17.1	.68
			123474	UM10V-650	5.1	.21	8.9	.35	9.2	.36	6.5	.26	9.9	.39	25.7	1.01
6.55	6.50 6.58	.2579 .2591	123250	UM10-655	11.9	.48	-	-	-	-	-	-	-	-	-	
			123251	UM10W-655	5.1	.21	10.5	.41	7.4	.29	5.6	.22	9.9	.38	15.1	.60
			123519	UM10T-655	13.9	.55	9.5	.37	7.6	.29	14.1	.55	9.9	.39	17.1	.68
			123475	UM10V-655	5.1	.21	8.9	.35	9.2	.36	6.5	.26	9.9	.39	25.7	1.01
6.6	6.55 6.63	.2598 .2610	123252	UM10-660	12	.48	-	-	-	-	-	-	-	-	-	
			123253	UM10W-660	5.2	.21	10.6	.41	7.4	.29	5.6	.22	9.9	.38	15.1	.60
			123520	UM10T-660	13.9	.55	9.5	.37	7.6	.29	14.1	.55	9.9	.39	17.1	.68
			123476	UM10V-660	5.2	.21	9	.35	9.2	.36	6.5	.26	9.9	.39	25.7	1.01
6.65	6.60 6.68	.2618 .2630	123254	UM10-665	12	.48	-	-	-	-	-	-	-	-	-	
			123255	UM10W-665	5.2	.21	10.6	.41	7.4	.29	5.6	.22	9.9	.38	15.1	.60
			123521	UM10T-665	13.9	.55	9.6	.37	7.6	.29	14.1	.55	9.9	.39	17.1	.68
			123477	UM10V-665	5.2	.21	9	.35	9.2	.36	6.5	.26	9.9	.39	25.7	1.01

# UM10 MICROCONIC COLLETS

Part Size Range ØA			SKU	Item Number	B		ØG		ØC1		D1		ØC2		D2	
mm	inch				mm	inch	mm	inch	mm	inch	mm	inch	mm	inch	mm	inch
6.7	6.65	.2638 .2618 .2650	123256	UM10-670	12	.48	-	-	-	-	-	-	-	-	-	-
	6.73		123257	UM10W-670	5.2	.21	10.7	.41	7.4	.29	5.6	.22	9.9	.38	15.1	.60
			123522	UM10T-670	13.9	.55	9.6	.37	7.6	.29	14.1	.55	9.9	.39	17.1	.68
			123478	UM10V-670	5.2	.21	9.1	.35	9.2	.36	6.5	.26	9.9	.39	25.7	1.01
6.75	6.70	.2657 .2638 .2669	123258	UM10-675	12	.48	-	-	-	-	-	-	-	-	-	-
	6.78		123259	UM10W-675	5.3	.21	10.7	.42	7.4	.29	5.6	.22	9.9	.38	15.1	.60
			123523	UM10T-675	13.9	.55	9.7	.38	7.6	.29	14.1	.55	9.9	.39	17.1	.68
			123479	UM10V-675	5.3	.21	9.1	.35	9.2	.36	6.5	.26	9.9	.39	25.7	1.01
6.8	6.75	.2677 .2657 .2689	123260	UM10-680	12	.48	-	-	-	-	-	-	-	-	-	-
	6.83		123261	UM10W-680	5.3	.21	10.7	.42	7.4	.29	5.6	.22	9.9	.38	15.1	.60
			123524	UM10T-680	13.9	.55	9.7	.38	7.6	.29	14.1	.55	9.9	.39	17.1	.68
			123480	UM10V-680	5.3	.21	9.2	.36	9.2	.36	6.5	.26	9.9	.39	25.7	1.01
6.85	6.80	.2697 .2677 .2709	123262	UM10-685	12	.48	-	-	-	-	-	-	-	-	-	-
	6.88		123263	UM10W-685	5.3	.21	10.8	.42	7.4	.29	5.6	.22	9.9	.38	15.1	.60
			123525	UM10T-685	13.9	.55	9.8	.38	7.6	.29	14.1	.55	9.9	.39	17.1	.68
			123481	UM10V-685	5.3	.21	9.2	.36	9.2	.36	6.5	.26	9.9	.39	25.7	1.01
6.9	6.85	.2717 .2697 .2728	123264	UM10-690	12	.48	-	-	-	-	-	-	-	-	-	-
	6.93		123265	UM10W-690	5.3	.21	10.8	.42	7.4	.29	5.6	.22	9.9	.38	15.1	.60
			123526	UM10T-690	13.9	.55	9.8	.38	7.5	.29	14.1	.55	9.9	.38	17.1	.68
			123482	UM10V-690	5.3	.21	9.3	.36	9.2	.36	6.5	.26	9.9	.39	25.7	1.01
6.95	6.90	.2736 .2717 .2748	123266	UM10-695	12.1	.48	-	-	-	-	-	-	-	-	-	-
	6.98		123267	UM10W-695	5.4	.22	10.9	.42	7.4	.29	5.6	.22	9.9	.38	15.1	.60
			123527	UM10T-695	14	.55	9.8	.38	7.5	.29	14.1	.55	9.9	.38	17.1	.68
			123483	UM10V-695	5.4	.22	9.3	.36	9.2	.36	6.5	.26	9.9	.39	25.7	1.01
7	6.95	.2756 .2736 .2768	123268	UM10-700	12.1	.48	-	-	-	-	-	-	-	-	-	-
	7.03		123269	UM10W-700	5.4	.22	10.9	.42	7.4	.29	5.6	.22	9.9	.38	15.1	.60
			123528	UM10T-700	14	.55	9.9	.38	7.5	.29	14.1	.55	9.9	.38	17.1	.68
			123484	UM10V-700	5.4	.22	9.4	.36	9.2	.36	6.5	.26	9.9	.39	25.7	1.01
7.05	7.00	.2776 .2756 .2787	123270	UM10-705	12.1	.48	-	-	-	-	-	-	-	-	-	-
	7.08		123271	UM10W-705	5.4	.22	11	.43	7.4	.29	5.6	.22	9.9	.38	15.1	.60
			123529	UM10T-705	14	.55	9.9	.39	7.5	.29	14.1	.55	9.9	.38	17.1	.68
			123485	UM10V-705	5.4	.22	9.4	.37	9.2	.36	6.5	.26	9.9	.39	25.7	1.01
7.1	7.05	.2795 .2776 .2807	123272	UM10-710	12.1	.48	-	-	-	-	-	-	-	-	-	-
	7.13		123273	UM10W-710	5.4	.22	11	.43	7.4	.29	5.6	.22	9.9	.38	15.1	.60
			123530	UM10T-710	14	.56	10	.39	7.5	.29	14.1	.55	9.9	.38	17.1	.68
			123486	UM10V-710	5.4	.22	9.5	.37	9.2	.36	6.5	.26	9.9	.39	25.7	1.01
7.15	7.10	.2815 .2795 .2827	123274	UM10-715	12.1	.48	-	-	-	-	-	-	-	-	-	-
	7.18		123275	UM10W-715	5.5	.22	11	.43	7.4	.29	5.6	.22	9.9	.38	15.1	.60
			123531	UM10T-715	14	.56	10	.39	7.5	.29	14.1	.55	9.9	.38	17.1	.68
			123487	UM10V-715	5.5	.22	9.5	.37	9.2	.36	6.5	.26	9.9	.39	25.7	1.01
7.2	7.15	.2835 .2815 .2846	123276	UM10-720	12.1	.48	-	-	-	-	-	-	-	-	-	-
	7.23		123277	UM10W-720	5.5	.22	11.1	.43	7.4	.29	5.6	.22	9.9	.38	15.1	.60
			123532	UM10T-720	14	.56	10.1	.39	7.5	.29	14.1	.55	9.9	.38	17.1	.68
			123488	UM10V-720	5.5	.22	9.5	.37	9.2	.36	6.5	.26	9.9	.39	25.7	1.01

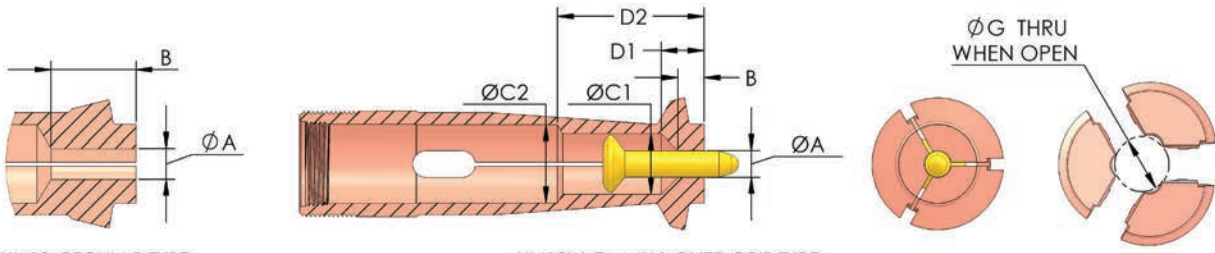

UM10 REGULAR TYPE

UM10W, T and V OVER-GRIP TYPE

**UM10** - Regular Type **UM10W** - Short Land Over-grip **UM10T** - Long Land Over-grip **UM10V** - Larger Capacity Over-grip

Part Size Range ØA			SKU	Item Number	B		ØG		ØC1		D1		ØC2		D2	
mm	inch				mm	inch	mm	inch	mm	inch	mm	inch	mm	inch	mm	inch
7.25	7.20	.2854 .2835 .2866	123278	UM10-725	12.2	.48	-	-	-	-	-	-	-	-	-	-
	7.28		123533	UM10T-725	14	.56	10.1	.39	7.5	.29	14.1	.55	9.9	.38	17.1	.68
			123489	UM10V-725	5.5	.22	9.6	.37	9.2	.36	6.5	.26	9.9	.39	25.7	1.01
7.3	7.25	.2874 .2854 .2886	123279	UM10-730	12.2	.48	-	-	-	-	-	-	-	-	-	-
	7.33		123490	UM10V-730	5.5	.22	9.6	.37	9.2	.36	6.5	.26	9.9	.39	25.7	1.01
7.35	7.30	.2894 .2874 .2906	123280	UM10-735	12.2	.48	-	-	-	-	-	-	-	-	-	-
	7.38		123491	UM10V-735	5.6	.22	9.7	.38	9.2	.36	6.5	.26	9.9	.39	25.7	1.01
7.4	7.35	.2913 .2894 .2925	123281	UM10-740	12.2	.49	-	-	-	-	-	-	-	-	-	-
	7.43		123492	UM10V-740	5.6	.22	9.7	.38	9.2	.36	6.5	.26	9.9	.39	25.7	1.01
7.45	7.40	.2933 .2913 .2945	123282	UM10-745	12.2	.49	-	-	-	-	-	-	-	-	-	-
	7.48		123493	UM10V-745	5.6	.23	9.8	.38	9.2	.36	6.5	.26	9.9	.39	25.7	1.01
7.5	7.45	.2953 .2933 .2965	123283	UM10-750	12.2	.49	-	-	-	-	-	-	-	-	-	-
	7.53		123494	UM10V-750	5.6	.23	9.8	.38	9.2	.36	6.5	.26	9.9	.39	25.7	1.01
7.55	7.50	.2972 .2953 .2984	123284	UM10-755	12.2	.49	-	-	-	-	-	-	-	-	-	-
	7.58		123495	UM10V-755	5.6	.23	9.9	.38	9.2	.36	6.5	.26	9.9	.39	25.7	1.01
7.6	7.55	.2992 .2972 .3004	123285	UM10-760	12.3	.49	-	-	-	-	-	-	-	-	-	-
	7.63		123496	UM10V-760	5.7	.23	9.9	.39	9.2	.36	6.5	.26	9.9	.39	25.7	1.01
7.65	7.60	.3012 .2992 .3024	123286	UM10-765	12.3	.49	-	-	-	-	-	-	-	-	-	-
	7.68		123497	UM10V-765	5.7	.23	10	.39	9.2	.36	6.5	.26	9.9	.39	25.7	1.01
7.7	7.65	.3031 .3012 .3043	123287	UM10-770	12.3	.49	-	-	-	-	-	-	-	-	-	-
	7.73		123498	UM10V-770	5.7	.23	10	.39	9.2	.36	6.5	.26	9.9	.39	25.7	1.01
7.75	7.70	.3051 .3031 .3063	123288	UM10-775	12.3	.49	-	-	-	-	-	-	-	-	-	-
	7.78		123499	UM10V-775	5.8	.23	10	.39	9.2	.36	6.5	.26	9.9	.39	25.7	1.01
7.8	7.75	.3071 .3051 .3083	123289	UM10-780	12.3	.49	-	-	-	-	-	-	-	-	-	-
	7.83		123500	UM10V-780	5.8	.23	10.1	.39	9.2	.36	6.5	.26	9.9	.39	25.7	1.01
7.85	7.80	.3091 .3071 .3102	123290	UM10-785	12.3	.49	-	-	-	-	-	-	-	-	-	-
	7.88		123501	UM10V-785	5.8	.23	10.1	.39	9.2	.36	6.5	.26	9.9	.39	25.7	1.01
7.9	7.85	.3110 .3091 .3122	123291	UM10-790	12.4	.49	-	-	-	-	-	-	-	-	-	-
	7.93		123502	UM10V-790	5.8	.23	10.2	.40	9.2	.36	6.5	.26	9.9	.39	25.7	1.01
7.95	7.90	.3130 .3110 .3142	123292	UM10-795	12.4	.49	-	-	-	-	-	-	-	-	-	-
	7.98		123503	UM10V-795	5.9	.23	10.2	.40	9.2	.36	6.5	.26	9.9	.39	25.7	1.01
8	7.95	.3150 .3130 .3161	123293	UM10-800	12.4	.49	-	-	-	-	-	-	-	-	-	-
	8.03		123504	UM10V-800	5.9	.24	10.3	.40	9.2	.36	6.5	.26	9.9	.39	25.7	1.01
8.05	8.00	.3169 .3150 .3181	123294	UM10-805	12.4	.49	-	-	-	-	-	-	-	-	-	-
	8.08		123505	UM10V-805	5.9	.24	10.3	.40	9.3	.36	6.5	.26	9.9	.39	25.7	1.01
8.1	8.05	.3189 .3169 .3201	123295	UM10-810	12.4	.49	-	-	-	-	-	-	-	-	-	-
	8.13		123506	UM10V-810	5.9	.24	10.4	.40	9.3	.36	6.5	.26	9.9	.39	25.7	1.01
8.15	8.10	.3209 .3189 .3220	123296	UM10-815	12.4	.49	-	-	-	-	-	-	-	-	-	-
	8.18		123507	UM10V-815	5.9	.24	10.4	.40	9.3	.36	6.5	.26	9.9	.39	25.7	1.01

# UM10 MICROCONIC COLLETS

Part Size Range ØA		SKU	Item Number	B		ØG		ØC1		D1		ØC2		D2	
mm	inch			mm	inch	mm	inch	mm	inch	mm	inch	mm	inch	mm	inch
8.2	8.15	.3228-.3209	123297	UM10-820	12.4	.49	-	-	-	-	-	-	-	-	-
	8.23		.3228-.3240	123508	UM10V-820	6	.24	10.5	.41	9.3	.36	6.5	.26	9.9	.39
8.25	8.20	.3248-.3228	123298	UM10-825	12.5	.50	-	-	-	-	-	-	-	-	-
	8.28		.3248-.3260	123534	UM10V-825	6	.24	10.5	.41	9.2	.36	6.5	.26	9.9	.39
8.3	8.25	.3268-.3248	123299	UM10-830	12.5	.50	-	-	-	-	-	-	-	-	-
	8.33		.3268-.3280	123535	UM10V-830	6	.24	10.6	.41	9.2	.36	6.5	.26	9.9	.39
8.35	8.30	.3287-.3268	123300	UM10-835	12.5	.50	-	-	-	-	-	-	-	-	-
	8.38		.3287-.3299	123536	UM10V-835	6.1	.24	10.6	.41	9.2	.36	6.5	.26	9.9	.39
8.4	8.35	.3307-.3287	123301	UM10-840	12.5	.50	-	-	-	-	-	-	-	-	-
	8.43		.3307-.3319	123537	UM10V-840	6.1	.24	10.7	.41	9.2	.36	6.5	.26	9.9	.39
8.45	8.40	.3327-.3307	123302	UM10-845	12.5	.50	-	-	-	-	-	-	-	-	-
	8.48		.3327-.3339	123538	UM10V-845	6.1	.24	10.7	.42	9.2	.36	6.5	.26	9.9	.39
8.5	8.45	.3346-.3327	123303	UM10-850	12.5	.50	-	-	-	-	-	-	-	-	-
	8.53		.3346-.3358	123539	UM10V-850	6.1	.25	10.7	.42	9.3	.36	6.5	.26	9.9	.39
8.55	8.50	.3366-.3346	123304	UM10-855	12.5	.50	-	-	-	-	-	-	-	-	-
	8.58		.3366-.3378	123540	UM10V-855	6.1	.25	10.8	.42	9.3	.36	6.5	.26	9.9	.39
8.6	8.55	.3386-.3366	123305	UM10-860	12.6	.50	-	-	-	-	-	-	-	-	-
	8.63		.3386-.3398	123541	UM10V-860	6.2	.25	10.8	.42	9.3	.36	6.5	.26	9.9	.39
8.65	8.60	.3406-.3386	123306	UM10-865	12.6	.50	-	-	-	-	-	-	-	-	-
	8.68		.3406-.3417	123542	UM10V-865	6.2	.25	10.9	.42	9.3	.36	6.5	.26	9.9	.39
8.7	8.65	.3425-.3406	123307	UM10-870	12.6	.50	-	-	-	-	-	-	-	-	-
	8.73		.3425-.3437	125011	UM10V-870	6.2	.25	10.9	.42	9.3	.36	6.5	.26	9.9	.39
8.75	8.70	.3445-.3425	123308	UM10-875	12.6	.50	-	-	-	-	-	-	-	-	-
	8.78		.3445-.3457	123653	UM10V-875	6.3	.25	11	.43	9.2	.36	6.5	.26	9.9	.39
8.8	8.75	.3465-.3445	123309	UM10-880	12.6	.50	-	-	-	-	-	-	-	-	-
	8.83		.3465-.3476	125012	UM10V-880	6.3	.25	11	.43	9.2	.36	6.5	.26	9.9	.39
8.85	8.80	.3484-.3465	123310	UM10-885	12.6	.50	-	-	-	-	-	-	-	-	-
	8.88		.3484-.3496	125013	UM10V-885	6.3	.25	11.1	.43	9.2	.36	6.5	.26	9.9	.39
8.9	8.85	.3504-.3484	123311	UM10-890	12.7	.50	-	-	-	-	-	-	-	-	-
	8.93		.3504-.3516	125014	UM10V-890	6.3	.25	11.1	.43	9.2	.36	6.5	.26	9.9	.39
8.95	8.90	.3524-.3504	123312	UM10-895	12.7	.50	-	-	-	-	-	-	-	-	-
	8.98		.3524-.3535	125015	UM10V-895	6.3	.25	11.2	.43	9.2	.36	6.5	.26	9.9	.39
9	8.95	.3543-.3524	123313	UM10-900	12.7	.50	-	-	-	-	-	-	-	-	-
	9.03		.3543-.3555	123557	UM10V-900	6.4	.26	11.2	.44	9.2	.36	6.5	.26	9.9	.39
9.05	9.00	.3563-.3543	123314	UM10-905	12.7	.50	-	-	-	-	-	-	-	-	-
	9.08		.3563-.3575	123558	UM10V-905	6.4	.26	11.2	.44	9.2	.36	6.5	.26	9.9	.39
9.1	9.05	.3583-.3563	123315	UM10-910	12.7	.51	-	-	-	-	-	-	-	-	-
9.15	9.10	.3602-.3583	123316	UM10-915	12.7	.51	-	-	-	-	-	-	-	-	-
	9.18		.3602-.3614												
9.2	9.15	.3622-.3602	123317	UM10-920	12.7	.51	-	-	-	-	-	-	-	-	-
	9.23		.3622-.3634												
9.25	9.20	.3642-.3622	123318	UM10-925	12.8	.51	-	-	-	-	-	-	-	-	-
	9.28		.3642-.3654												
9.3	9.25	.3661-.3642	123319	UM10-930	12.8	.51	-	-	-	-	-	-	-	-	-
	9.33		.3661-.3673												

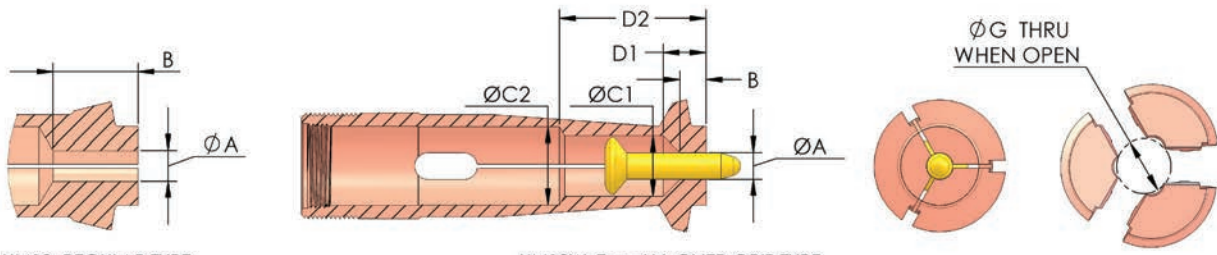

UM10 REGULAR TYPE

UM10W, T and V OVER-GRIP TYPE

**UM10** - Regular Type **UM10W** - Short Land Over-grip **UM10T** - Long Land Over-grip **UM10V** - Larger Capacity Over-grip

Part Size Range		ØA	SKU	Item Number	B		ØG		ØC1		D1		ØC2		D2	
mm	inch				mm	inch	mm	inch	mm	inch	mm	inch	mm	inch	mm	inch
9.35	9.30 9.38	.3681 .3661 .3693	123320	UM10-935	12.8	.51	-	-	-	-	-	-	-	-	-	-
9.4	9.35 9.43	.3701 .3681 .3713	123321	UM10-940	12.8	.51	-	-	-	-	-	-	-	-	-	-
9.45	9.40 9.48	.3720 .3701 .3732	123322	UM10-945	12.8	.51	-	-	-	-	-	-	-	-	-	-
9.5	9.45 9.53	.3740 .3720 .3752	123323	UM10-950	12.8	.51	-	-	-	-	-	-	-	-	-	-
9.55	9.50 9.58	.3760 .3740 .3772	123324	UM10-955	12.8	.51	-	-	-	-	-	-	-	-	-	-
9.6	9.55 9.63	.3780 .3760 .3791	123325	UM10-960	12.9	.51	-	-	-	-	-	-	-	-	-	-
9.65	9.60 9.68	.3799 .3780 .3811	123326	UM10-965	12.9	.51	-	-	-	-	-	-	-	-	-	-
9.7	9.65 9.73	.3819 .3799 .3831	123327	UM10-970	12.9	.51	-	-	-	-	-	-	-	-	-	-
9.75	9.70 9.78	.3839 .3819 .3850	123328	UM10-975	12.9	.51	-	-	-	-	-	-	-	-	-	-
9.8	9.75 9.83	.3858 .3839 .3870	123329	UM10-980	12.9	.51	-	-	-	-	-	-	-	-	-	-
9.85	9.80 9.88	.3878 .3858 .3890	123330	UM10-985	12.9	.51	-	-	-	-	-	-	-	-	-	-
9.9	9.85 9.93	.3898 .3878 .3909	123331	UM10-990	13	.51	-	-	-	-	-	-	-	-	-	-
9.95	9.90 9.98	.3917 .3898 .3929	123332	UM10-995	13	.52	-	-	-	-	-	-	-	-	-	-
10	9.95 10.03	.3937 .3917 .3949	123333	UM10-1000	13	.52	-	-	-	-	-	-	-	-	-	-
10.15	1.10 1.18	.3996 .3976 .4008	123663	UM10-1015	13	.52	-	-	-	-	-	-	-	-	-	-

# INSTALLATION INSTRUCTIONS FOR SWISS TYPE MACHINE



## INSTALLING THE MICROCONIC CARTRIDGE:

1. Remove any previous collet from the machine by normal means.



2. Remove the collet spring (this is not used with Microconic).



3. Make sure the machine spindle sleeve is clean and wiped free of any particles.

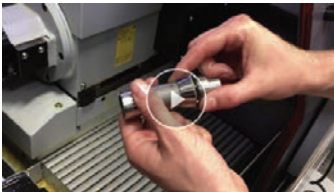

4. Insert the Microconic cartridge (without a collet yet), and seat it with a few twists to displace any dust particles.



5. Screw on the spindle nose cap normally.

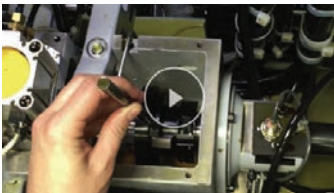

6. Adjust the machine's collet closer normally for firm closing force. The Microconic cartridge is now installed. The estimated time for above steps is under 5 minutes.

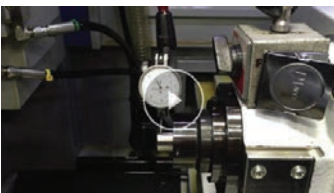

If desired, the working concentricity of the machine can now be verified using a dial test indicator measuring the runout of the cartridge nose. Machine should be in the CLOSED COLLET condition for this test. If improvement is needed, first try removing the cartridge and carefully cleaning all mating surfaces of the machine and cartridge, then reinstalling the cartridge. If runout is still excessive, further troubleshooting can be performed to determine the source of the runout in the machine. On machines in excellent condition, runout of less than 2 microns (.0001") should be achieved. The cartridge can remain in the machine and does not have to be removed to change Microconic collets.





## INSTALLING AND ADJUSTING MICROCONIC COLLETS:

1. With cartridge already installed, put machine in CLOSED COLLET condition.



2. Loosen the adjustment set screw  $\frac{1}{2}$  turn with the included Masa screwdriver.



3. Insert the Microconic collet into the cartridge.



4. Screw the collet in using the Micrograd dial.



5. Insert a gage pin the diameter of your work piece.



6. Continue to screw in the collet with the Micrograd dial until it closes onto the gage pin. This is the ZERO CLAMPING reference position on the Micrograd dial.



7. Back-off 1 graduation of the Micrograd dial and remove the gage pin.



8. Return the Micrograd dial to the ZERO CLAMPING reference position, and then rotate additional graduations to set the clamping force (see the Setting table on page 0). Remove the Micrograd dial when done.



9. Tighten the adjustment set screw with the Masa screwdriver. The collet is now installed and adjusted. The estimated time for above steps is under 2 minutes. \*For over-grip collets additional adjustment steps are needed. See instructions included with each cartridge and over-grip collet, and also at [masatool.com/installation](https://www.masatool.com/installation).



## WARRANTY

### **MASA TOOL WARRANTS THAT THE PRODUCTS WILL BE FREE FROM DEFECTS IN MATERIAL AND WORKMANSHIP.**

- No product shall be returned to us without a return authorization (RMA) number. Email sales@masatool.com to request an RMA.
- If you find any failure of our products to conform to our stated dimensions notify us this within 90 days from date of receipt of the product, we will replace the defective product or make suitable repairs. Stated performance claims apply only to product in non-worn condition. Catalog statements are valid as of the issue date and are subject to change without notice.
- If we are unable to correct the nonconformity by replacing the product or making suitable repairs we will refund the purchase price upon receipt of the nonconforming product FOB our plant.
- In no event shall we be liable either directly or by way of contribution or indemnity, for direct, special, incidental or consequential damages such as, but not limited to, property damage, loss of profit, or damages based on loss of use of the product, whether the claim for any such damages be based on warranty, express or implied, contract, tort, or otherwise.
- This warranty does not apply to products that are misapplied, altered, or abused. The foregoing is our sole warranty with respect to the product.
- We make no other warranties, express or implied, including implied warranties of merchantability and fitness for a particular purpose.
- Orders for special items, non-catalog or modified items, are accepted on a no cancellation basis, and are not returnable. A confirming purchase order and approved drawing is required prior to any work beginning on special items.

### **DISTRIBUTOR ORDER AND SHIPPING POLICY**

- Orders will be accepted only by email. Send orders to sales@masatool.com.
- Only orders that are clearly legible and are on a distributor letterhead or official company purchase order form, showing a valid PO number will be processed.
- All orders are shipped FOB 2575 Jason Court, Oceanside, CA 92056-3592.
- Customer Service hours are 7:00 AM to 4:30 PM Pacific Time, Monday through Friday.
- **Cutoff time for our same-day order expedite service is 11:00 AM Pacific Time.**

### **PAYMENT TERMS**

- Standard distributor payment terms are Net 30 days.
- Credit card payments are accepted. Fee applies.
- FOB point is 2575 Jason Court, Oceanside, CA 92056-3592. Freight will be prepaid and added to invoice unless otherwise specified.





**MASA**  
MICROCONIC SYSTEM

**M A S A T O O L . C O M**

**MASA TOOL**

2575 Jason Court  
Oceanside, CA 92056-3592

tel: 760.732.1422  
email: [info@masatool.com](mailto:info@masatool.com)

ZW101 Issued August 2022